

REL. TO PROTO.:		REL. TO TOOL.:		REL. TO PROD.:	7/6/95 P7107	C-0178		
REV LTR	EO NO.	SHEETS	ZONES	REVISION DESCRIPTION			DRAWN BY	APPD BY
A	P5893			RELEASED TO PRODUCTION			JMR 7/6/95	

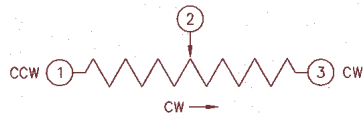
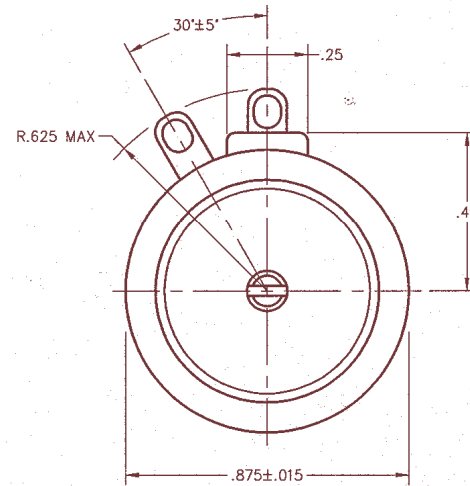
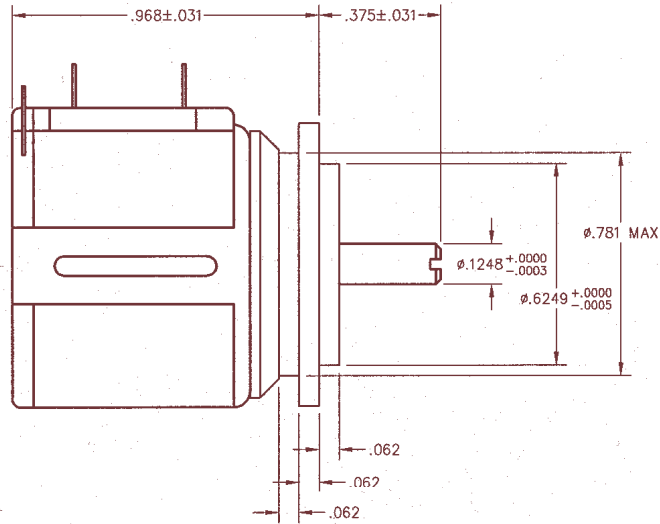

- Servo lid similar to model 3550
- Shaft diameter 0.1248" +0.0000" /-0.0003"
- Front ball bearing

NOTES EXCEPT AS SPECIFIED

- DIMENSIONS IN INCHES [MILLIMETERS] PER ANSI Y14.5
- DEBURR EDGES .005 [0,127] MAX.
- MAX. BURR PERMITTED .002 [0,051]
- INSIDE RADIUS .005 [0,127] MAX.
- OUTSIDE RADIUS .005 [0,127] MAX.
- TOLERANCES:
 - xx = ±.02 [0,50]
 - xxx = ±.005 [0,127]
 - xxxx = ±.0005 [0,0127]
- ANGLE TOLERANCE ±.5°
- SURFACES SHALL BE FLAT WITHIN .001 IN/IN [0,001 mm/mm]
- SURFACE ROUGHNESS TO BE 63 PER ANSI B46.1
- DIAMETERS WITH SAME CENTERLINE TO BE CONCENTRIC WITHIN .005 [0,127] T.I.R.
- FEATURES WITH SAME CENTERLINE TO BE SYMMETRICAL WITHIN .005 [0,127]



TITLE			
OUTLINE DRAWING			
SIZE	CODE IDENT NO.	DWG NO.	REV
B	57921	C-0178	A
SCALE	MODEL	SHEET 1 OF 1	
2X	3540S-TAL		

THIS PRINT DISCLOSES SUBJECT MATTER IN WHICH BOURNS, INC. HAS PROPRIETARY RIGHTS. THE RECEIPT OR POSSESSION OF THIS PRINT DOES NOT CONFER, TRANSFER, OR LICENSE THE USE OF THE DESIGN OR TECHNICAL INFORMATION SHOWN HEREIN. REPRODUCTION OF THIS PRINT OR ANY INFORMATION CONTAINED HEREIN OR MANUFACTURE OF ANY ARTICLE HEREFROM, FOR DISCLOSURE TO OTHERS, IS FORBIDDEN, EXCEPT BY SPECIFIC WRITTEN PERMISSION FROM BOURNS, INC..