

Amphenol FCI

© 2016 AFCI

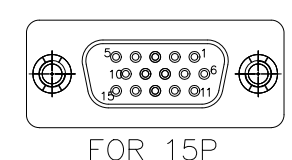
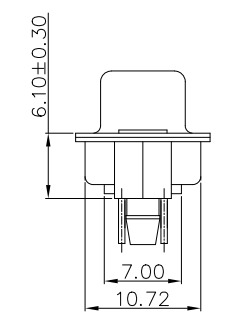
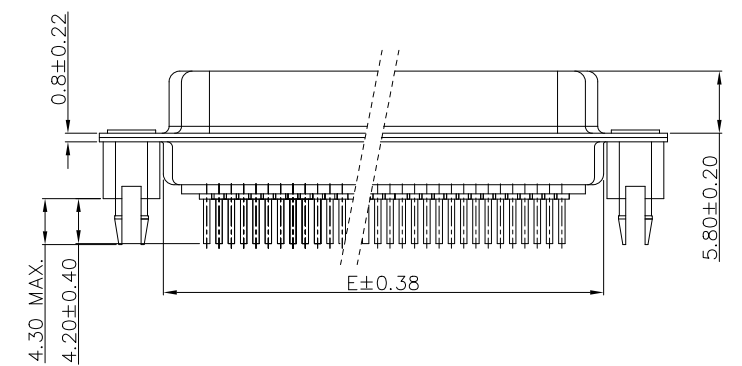
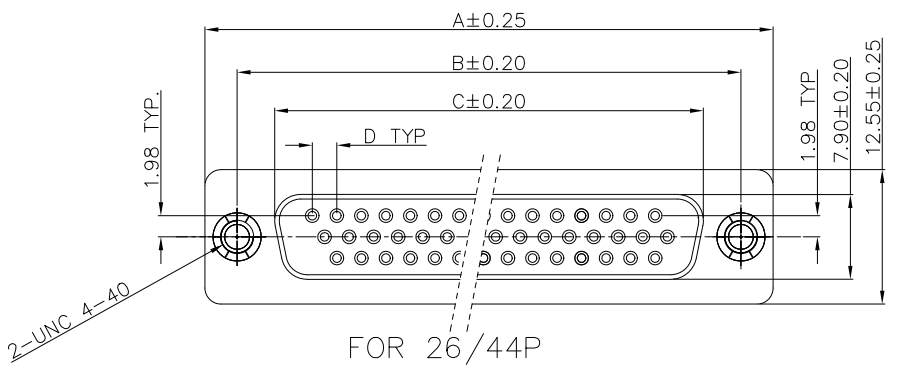

**NOTES:**

- CHARACTERISTICS:**  
 RATED VOLTAGE: 250V  
 RATED CURRENT: 2.5AMP  
 CONTACT RESISTANCE: 25mohms MAX. INITIAL,  
 40mohms MAX. AFTER.  
 INSULATION RESISTANCE: 5000Mohms MIN. at 500V DC  
 DIELECTRIC STRENGTH: 750VRMS  
 OPERATING TEMPERATURE RANGE: -55° C~105° C  
 INSERTION/EXTRACTION FORCE PER CONTACT: 5N Max. /0.2N Min.  
 MATING/UNMATING CYCLES: 50MATING CYCLES MIN FOR GOLD-FLASH  
 500MATING CYCLES MIN FOR 30u" GOLD.
- MATERIAL:**  
 INSULATORS: THERMOPLASTIC G.F(UL94V-0) BLACK  
 CONTACTS: COPPER ALLOY, GOLD(G/F or 30U") TOP OVER CONTACT  
 AREA, 100u" Min MATTE TIN TOP OVER SOLDER AREA,  
 50u" Min NICKEL UNDER PLATE.  
 SHELL: CARBON STEEL, 100u" Min NICKEL TOP OVER,  
 50u" Min COPPER UNDER PLATE.  
 HARPOON: COPPER ALLOY , 100u" Min MATTE TIN PLATED.
- PROCESS CONDITIONS FOR SOLDERING**  
 FOR H TYPE:  
 THE HOUSING WILL WITHSTAND EXPOSURE TO 260° C PEAK TEMPERATURE FOR 10 SECONDS MAXIMUM IN A WAVE SOLDERING APPLICATION  
 FOR S TYPE:  
 THE HOUSING WILL WITHSTAND EXPOSURE TO 205° C PEAK TEMPERATURE FOR 5 SECONDS MAXIMUM IN A WAVE SOLDERING APPLICATION
- PART NUMBER DESCRIPTION:**

10090929-S XX X X LF

SERIES NO. TYPE LF: ROHS COMPLIANT

S: SOCKET PBT (FEMALE) FLANGE MOUNTING OPTION  
 H: SOCKET PA9T (FEMALE)  
 (See Note 3) X: UNC #4-40 CLINCHNUTS

NUMBER OF CONTACTS CONTACT FINISH

15: 15-PIN 4: FLASH GOLD  
 26: 26-PIN 6: 30u" GOLD  
 44: 44-PIN

POS.	PART NO.	THREAD TYPE
15	10090929-*15*XLF	UNC #4-40
26	10090929-*26*XLF	UNC #4-40
44	10090929-*44*XLF	UNC #4-40

POS.	A	B	C	D	E
15	30.81	24.99	16.33	2.29	19.10
26	39.24	33.32	24.66	2.29	27.75
44	53.04	47.04	38.38	2.29	41.30

mat'l. code				surface ISO 1302 ✓		tolerance ISO 406 ISO 1101		projection		product family	
-								D-SUB		D-SUB	
ltr	ecn no	dr	date	tolerances unless otherwise specified		angles linear		MM		title	
H	ELX-N-4677	TY	12/14/22							H/D D-SUB FEMALE STRAIGHT	
B	T10-0164	JH	10/19/10								
C	ELX-I-15500	AB	2013/08/21	0°±2'				scale 2:1			
D	ELX-I-18426	AB	2014/07/29	dr	JASON HSU	12/10/09				dwg no sheet 1 of 3 size	
E	ELX-I-20972	AB	2015/05/30	eng	MITHUN PAUL	2016/04/27				10090929 A3	
F	ELX-I-24092	MP	2016/05/13	chr	GREGAR MATHEW	2019/08/22				type Product Customer Drawing	
G	ELX-I-34650	GM	2019/08/22	appd	SANOJ P K	2019/08/22					
sheet	revision	H	H	H							
index	sheet	1	2	3							

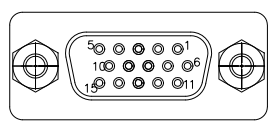
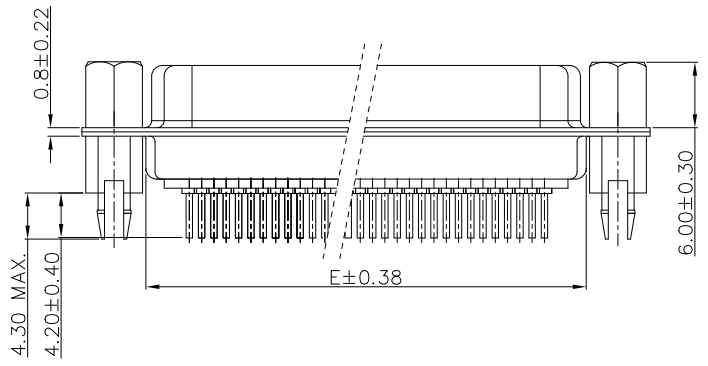
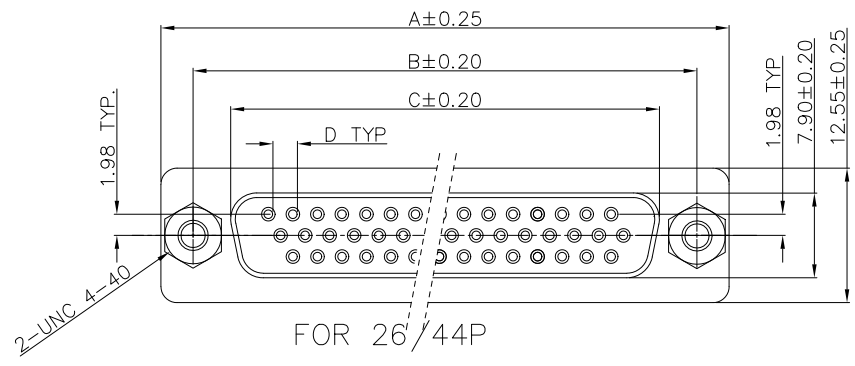

FOR 15P

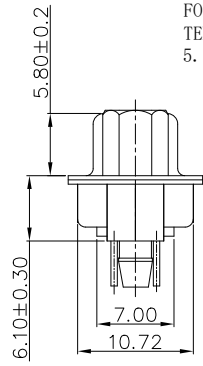

10090929-S XX X V LF

SERIES NO. \_\_\_\_\_

TYPE \_\_\_\_\_

S: SOCKET (FEMALE)  
H: SOCKET PART (FEMALE)  
(See Note 3)

NUMBER OF CONTACTS \_\_\_\_\_

15: 15-PIN  
26: 26-PIN  
44: 44-PIN

LF: ROHS COMPLIANT

FLANGE MOUNTING OPTION  
V: UNC #4-40 SCREWS/LOCKS

CONTACT FINISH  
4: FLASH GOLD  
6: 30u" GOLD

POS.	A	B	C	D	E
15	30.81	24.99	16.33	2.29	19.10
26	39.24	33.32	24.66	2.29	27.75
44	53.04	47.04	38.38	2.29	41.30

REMARK:

1. CHARACTERISTICS:

RATED VOLTAGE: 250V  
 RATED CURRENT: 2.5AMP  
 CONTACT RESISTANCE: 25mohms MAX. INITIAL,  
 40mohms MAX. AFTER.  
 INSULATION RESISTANCE: 5000Mohms MIN. at 500V DC  
 DIELECTRIC STRENGTH: 750VRMS  
 OPERATING TEMPERATURE RANGE: -55° C~105° C  
 INSERTION/EXTRACTION FORCE PER CONTACT: 5N Max./0.2N Min.  
 MATING/UNMATING CYCLES: 50MATING CYCLES MIN FOR GOLD-FLASH  
 500MATING CYCLES MIN FOR 30u" GOLD.

2. MATERIAL:

INSULATORS: THERMOPLASTIC G.F(UL94V-0) BLACK  
 CONTACTS: COPPER ALLOY, GOLD(G/F or 30u") TOP OVER CONTACT  
 AREA, 100u" Min MATTE TIN TOP OVER SOLDER AREA,  
 50u" Min NICKEL UNDER PLATE.  
 SHELL: CARBON STEEL, 100u" Min NICKEL TOP OVER,  
 50u" Min COPPER UNDER PLATE.  
 HARPOON: COPPER ALLOY , 100u" Min MATTE TIN PLATED.  
 NUT: COPPER ALLOY , 50u" Min NICKEL PLATED.

3. PROCESS CONDITIONS FOR SOLDERING

FOR H TYPE: THE HOUSING WILL WITHSTAND EXPOSURE TO 260° C PEAK  
 TEMPERATURE FOR 10 SECONDS MAXIMUM IN A WAVE SOLDERING APPLICATION  
 FOR S TYPE: THE HOUSING WILL WITHSTAND EXPOSURE TO 205° C PEAK  
 TEMPERATURE FOR 5 SECONDS MAXIMUM IN A WAVE SOLDERING APPLICATION

5. PART NUMBER DESCRIPTION:

mat'l. code		surface		tolerance		projection		product family	
-		ISO 1302 ✓		ISO 406 ISO 1101				D-SUB	
ltr		ecn no		dr		date		title	
H								H/D D-SUB FEMALE STRAIGHT	
								dwg no	
								sheet 2 of 3	
								size	
								A3	
								type	
								Product Customer Drawing	
sheet		revision							
index		sheet							

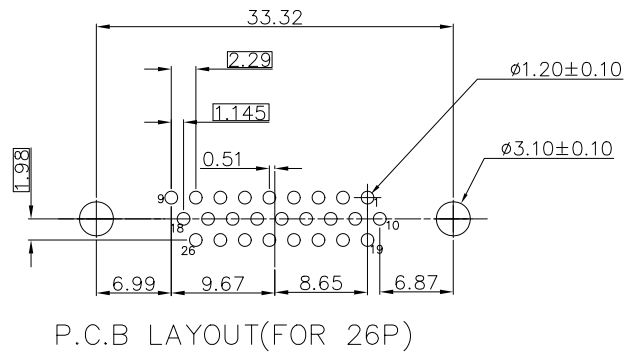
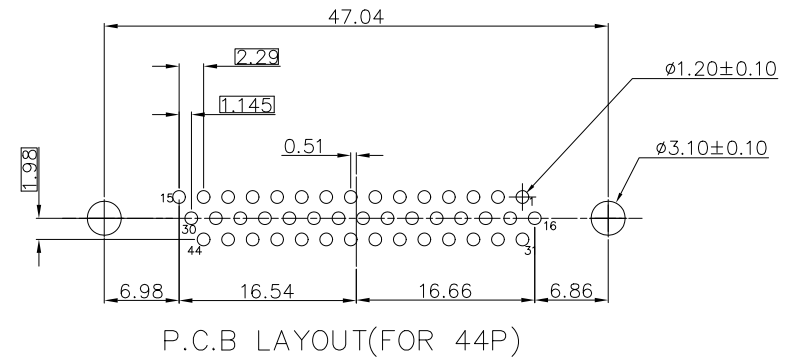
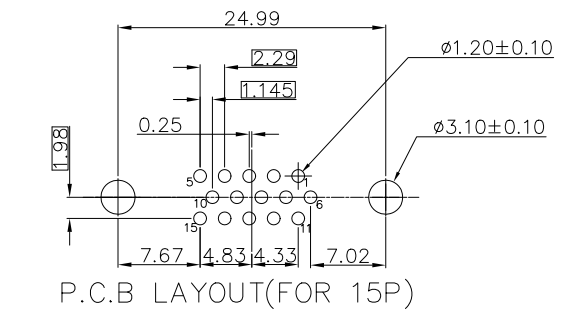

mat'l. code		surface		tolerance		projection		product family	
-		ISO 1302 ✓		ISO 406 ISO 1101				D-SUB	
ltr	ecn	no	dr	date		tolerances unless otherwise specified angles linear $.0 \pm 0.38$ $.00 \pm 0.25$ $.000 \pm 0.010$		title	
H								H/D D-SUB FEMALE STRAIGHT	
						$0^\circ \pm 2'$		scale 2:1 	
			dr	JASON HSU	12/10/09			dwg no sheet 3 of 3 size 10090929 A3	
			eng	MITHUN PAUL	2016/04/27				
			chr	GREGAR MATHEW	2019/08/22				
			appd	SANOJ P K	2019/08/22			type Product Customer Drawing	
sheet	revision								
index	sheet								

Amphenol  
FCI

© 2016 AFCI