

Jan.1.2022 Copyright 2022 HIROSE ELECTRIC CO., LTD. All Rights Reserved.
 In case of consideration for using Automotive equipment / device which demand high reliability, kindly contact our sales window correspondents.

【 ASSEMBLE TOOL 】 APPLICABLE OUTER CONDUCTOR CRIMPING TOOL : HT303/P06-T-1
 TOOL FOR PRESS FITTING OF DISK : MMCX-LP/PR-MP

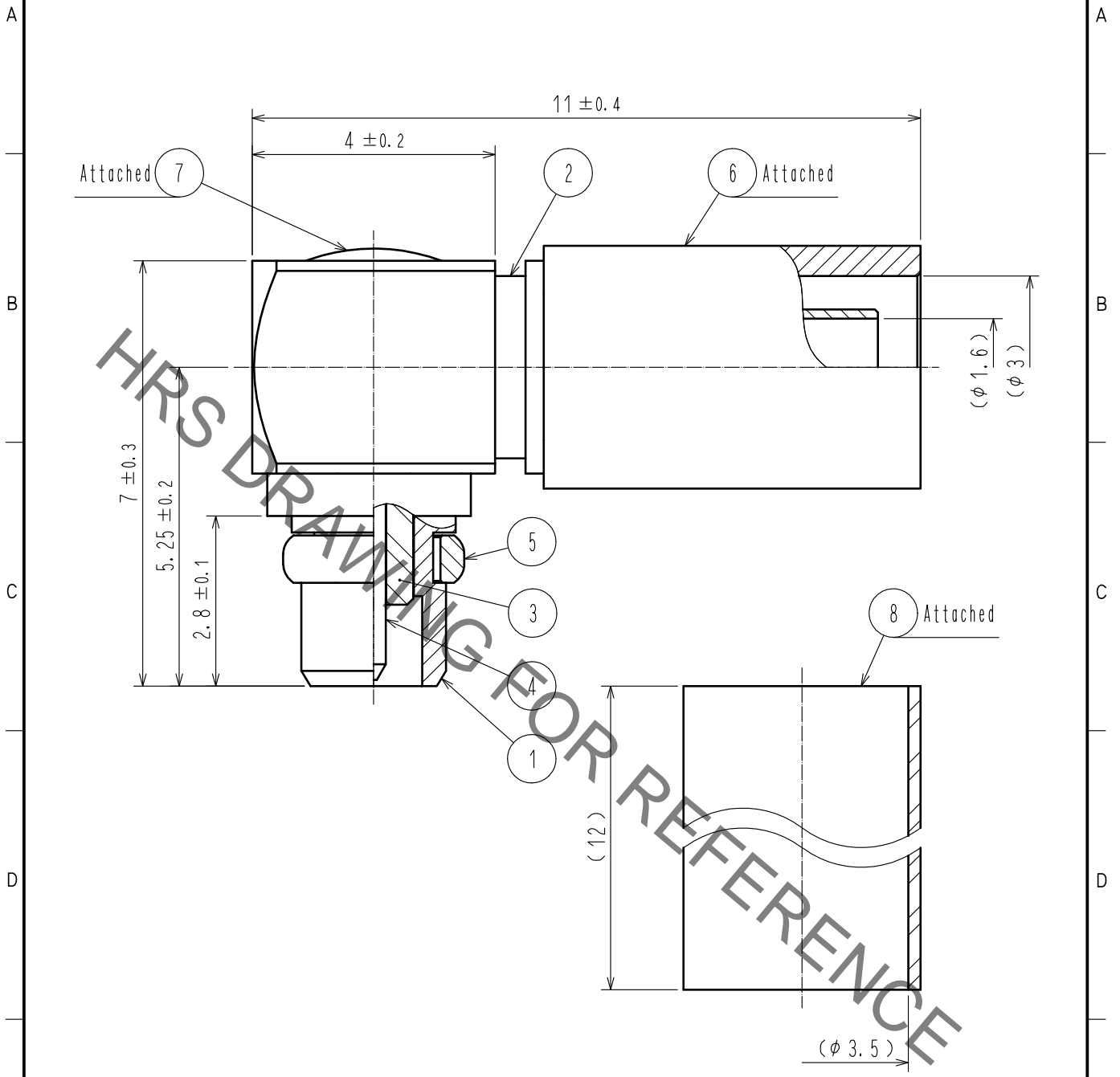

RoHS COMPLIANT

4	PHOSPHOR BRONZE	GOLD PLATING	8	POLYOLEFIN	HEAT SHRINK TUBING(BLACK)
3	PTFE		7	BRASS	GOLD PLATING
2	BRASS	GOLD PLATING	6	COPPER	GOLD PLATING
1	BRASS	GOLD PLATING	5	BERYLLIUM COPPER	GOLD PLATING
NO.	MATERIAL	FINISH . REMARKS	NO.	MATERIAL	FINISH . REMARKS

UNITS mm		SCALE 10 : 1	COUNT 	DESCRIPTION OF REVISIONS	DESIGNED	CHECKED	DATE
-------------	--	-----------------	-----------	--------------------------	----------	---------	------

HIROSE ELECTRIC CO., LTD.	APPROVED : TO. KATAYAMA	17. 08. 08	DRAWING NO.	EDC-134885-40-00
	CHECKED : TO. KATAYAMA	17. 08. 08	PART NO.	MMCX-LP-316/U(40)
	DESIGNED : NK. OOSAWA	17. 08. 08	CODE NO.	CL339-0006-0-40
	DRAWN : NK. OOSAWA	17. 08. 08		1/1

Mouser Electronics

Authorized Distributor

Click to View Pricing, Inventory, Delivery & Lifecycle Information:

[Hirose Electric:](#)

[MMCX-LP-316/U\(40\)](#)