

BU-00243-X

Solderless Standard Banana Plug (15 AMP)

Description:

- * Standard 4mm Banana Plug
- *Field serviceable, hands free operation while testing.
- *Universal banana plug that can be used with all 4mm banana jacks.
- *Thru-Hole design in cap locating wire on top of insulator.
- *Available in various colors
- *Hook-up wire: #18 AWG

Materials:

Cap & Housing	ABS
Banana Plug	Brass Body
Spring	Phosphor Bronze
Plating	Nickel

Ratings:

CE Compliance:

Voltage:

*To be used safely and for personal safety do not handle with voltages over 30Vms/60 Vdc.

*Maximum "hands free" in controlled environments: 300 WVDC max.

Operating Temp: +122°F (50°C)

Current: 15 AMPS

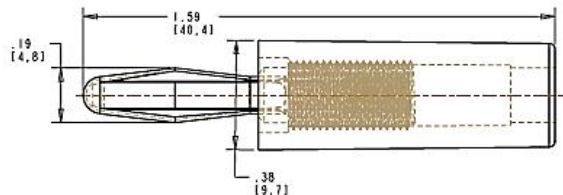

ASSEMBLY INSTRUCTIONS:

1. NOTE, WIRE "IS" NEEDED FOR ASSEMBLY.
2. PREPARE CABLE AND TIN BARE END.
3. PUSH CABLE THROUGH INSULATOR.
4. NOTE CORRECT ORIENTATION.
5. PUSH CABLE INTO CONTACT BODY AND SOLDER WIRE.
6. SCREW THE BANANA CONTACT-ASM INTO INSULATOR.

How to Order:

Model: BU-00243-* (-* Indicates Color)

(*0 Black, *2 Red, *4 Yellow, *5 Green, *6 Blue, *9 White)

Contact: Sales: 1-880-955-2629

Technical Support:

techsupport@muellerelectric.com

Fax: 216-771-3068

Where to Purchase:

International: 216-771-5225

www.muellerelectric.com