



IDM241-411S RS232 Kit

IDM

MOBILE HANDHELD SCANNERS

SICK
Sensor Intelligence.



Ordering information

Type	Part no.
IDM241-411S RS232 Kit	6080750

Included in delivery: Base station (1), IDM241-411S (1), Power supply unit (1), Connection cable (1)

Other models and accessories → www.sick.com/IDM



Detailed technical data

Features

Application	Standard application
Scanner design	Wireless variant
Sensor resolution	1,280 px x 800 px
Light source	LED, Visible, Red, 660 nm
Alignment aid	LED, green, 660 nm
Reading distance	30 mm ... 400 mm
Scanning frequency	60 Hz
Code resolution	≥ 0.07 mm ¹⁾ ≥ 0.13 mm ²⁾

¹⁾ Valid for Code 39.

²⁾ Valid for Data Matrix code.

Mechanics/electronics

Supply voltage	5 V DC, ± 5 %
Current consumption	Operation (charge status incl. base station): 750 mA Standby: 175 mA
Housing color	Black, Gray
Enclosure rating	IP52
Weight	230 g, without cable
Dimensions (L x W x H)	94 mm x 71 mm x 160 mm
MTBF	100,000 h

Performance

Readable code structures	1D codes, 2D codes, Stacked
Bar code types	Code 39, Code 39 Full ASCII, Code 32, Code 128, GS1-128, Codabar, Code 11, Code 93, GS1 DataBar, Standard and Industrial 2 of 5, Interleaved & Matrix 2 of 5, IATA, UPC / EAN / JAN, UPC / EAN / JAN (with addition), Telepen, MSI/Plessey, UK/Plessey, Australian Post, China

	Post, German Post, US Planet, US Postnet, British Post, Intelligent Mail, Japan Post, Korea Post, Dutch KIX Post, Posi LAPA 4 State Code
2D code types	Data Matrix, MaxiCode, QR code, Aztec, MicroQR-Code, GS1 QR code, GS1 Data-Matrix
Stacked code types	PDF417, MicroPDF417, Code 49, Code 16K, Composite, Codablock F
Battery power	Over 60,000 scans with full battery
Code buffer	5,000 Codes (EAN, for scanning in batch mode), 100,000 Codes (EAN, for out of range scanning)

Interfaces

Ethernet	✓
Type of fieldbus integration	Optional, over external connection module CDF600-2
PROFINET	✓
Type of fieldbus integration	Optional over external fieldbus module CDF600-2
Function	PROFINET Single Port, PROFINET Dual Port
EtherCAT	✓
Type of fieldbus integration	Optional over external fieldbus module CDF600
Serial	✓, RS-232
PROFIBUS DP	✓
Type of fieldbus integration	Optional over external fieldbus module CDF600-2
Bluetooth	✓
Remark	Bluetooth™ V4.0, 2.402 ... 2.4830 GHz
Function	Wireless operating range up to 100 m (free view), batch function for expansion of the wireless radius, up to seven scanners communicate with one base station
Optical indicators	2 LEDs (good read, charge of battery, radio connection status)
Acoustic indicators	Beeper, can be switched off
Vibration	No
Configuration software	IDM Setup Tool

Ambient data

Shock resistance	25 drops from 1.8 m height on concrete
Ambient operating temperature	-10 °C ... +50 °C
Storage temperature	-40 °C ... +70 °C
Permissible relative humidity	95 %, Non-condensing
Ambient light immunity	100,000 lx

General notes

Items supplied	The battery is included in delivery
Note	A power supply unit may also be required for commissioning. Not free of paint wetting impairment substances.

Classifications

eCl@ss 5.0	27280101
eCl@ss 5.1.4	27280101
eCl@ss 6.0	27280101
eCl@ss 6.2	27280101
eCl@ss 7.0	27280101
eCl@ss 8.0	27280101

eCl@ss 8.1	27280101
eCl@ss 9.0	27280101
eCl@ss 10.0	27280101
eCl@ss 11.0	27280101
eCl@ss 12.0	27280101
ETIM 5.0	EC002550
ETIM 6.0	EC002550
ETIM 7.0	EC002550
ETIM 8.0	EC002550
UNSPSC 16.0901	43211701

Connection diagram

PROFINET IO/RT

PROFINET IO/RT

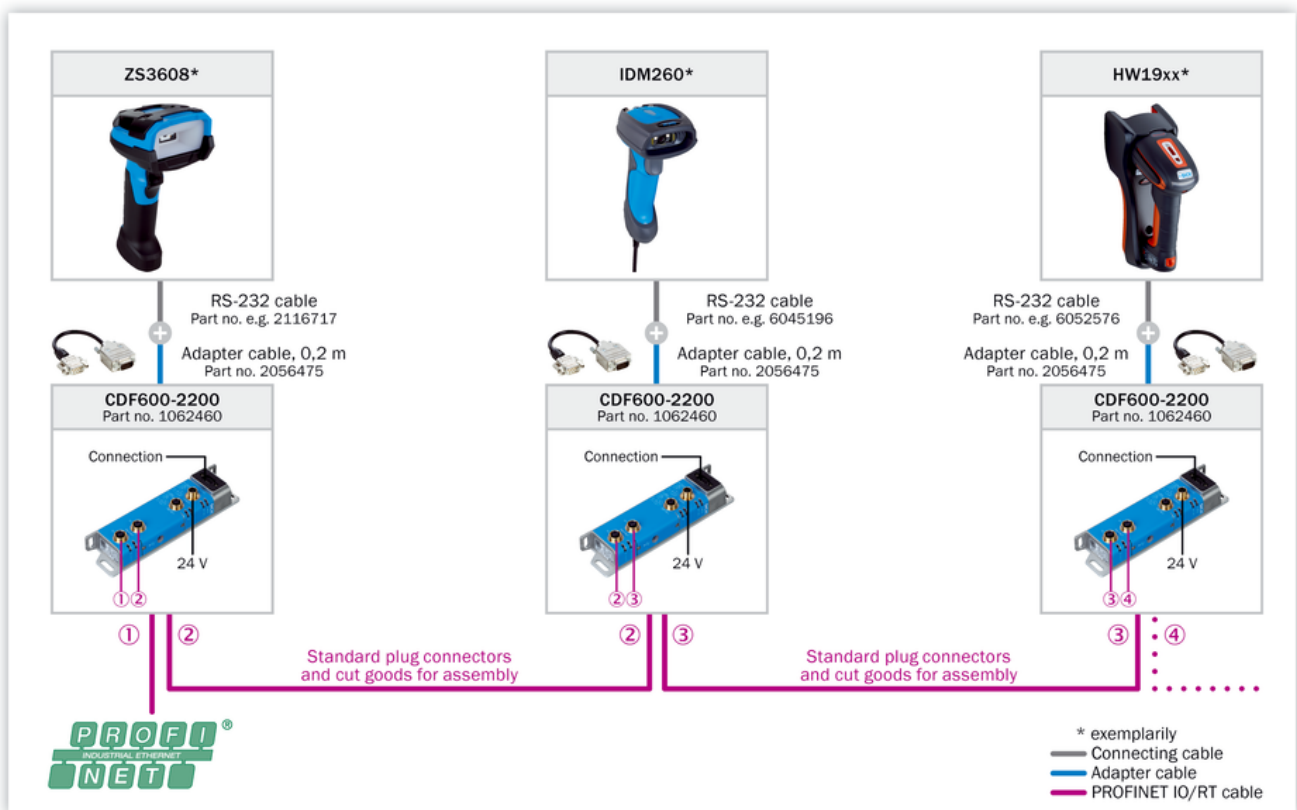

PROFIBUS DP

PROFIBUS DP

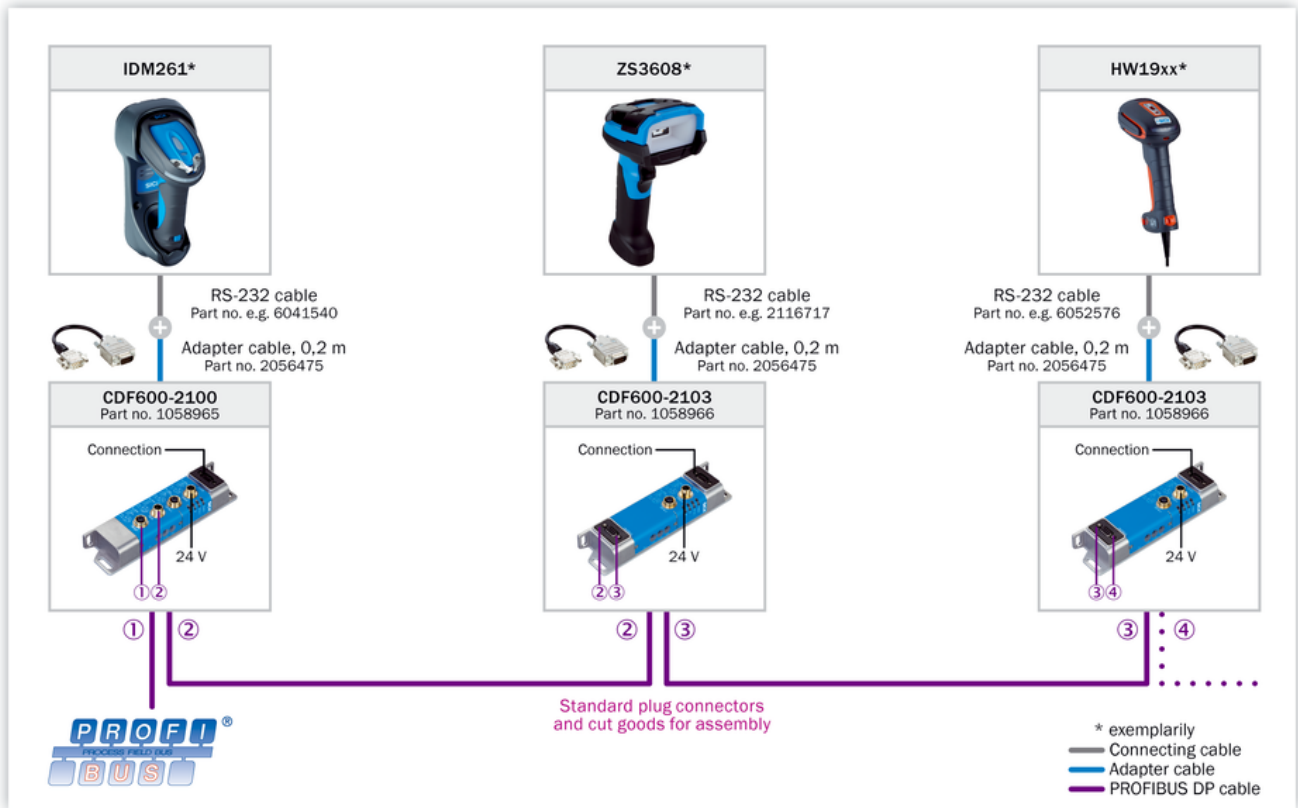

Ethernet TCP/IP

Ethernet TCP/IP

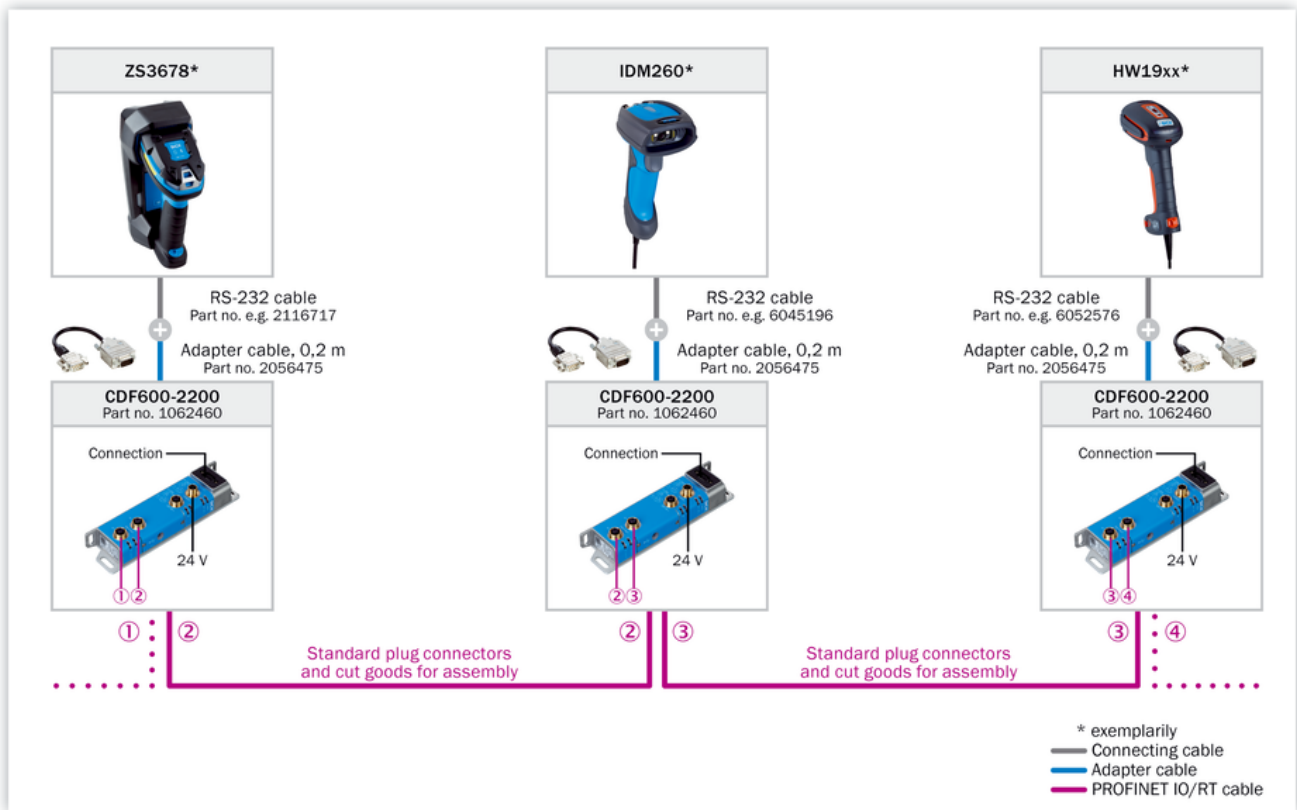

EtherCAT®

EtherCAT®

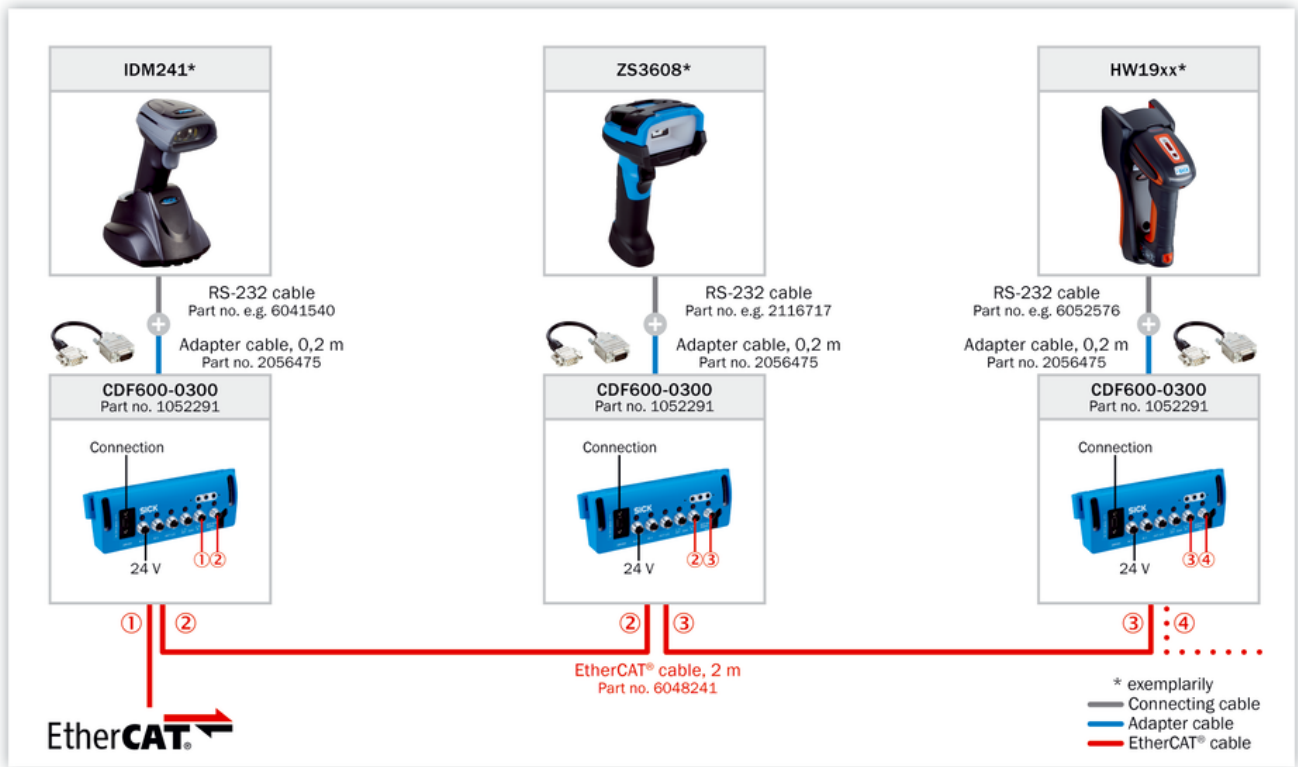

DeviceNet™

DeviceNet™

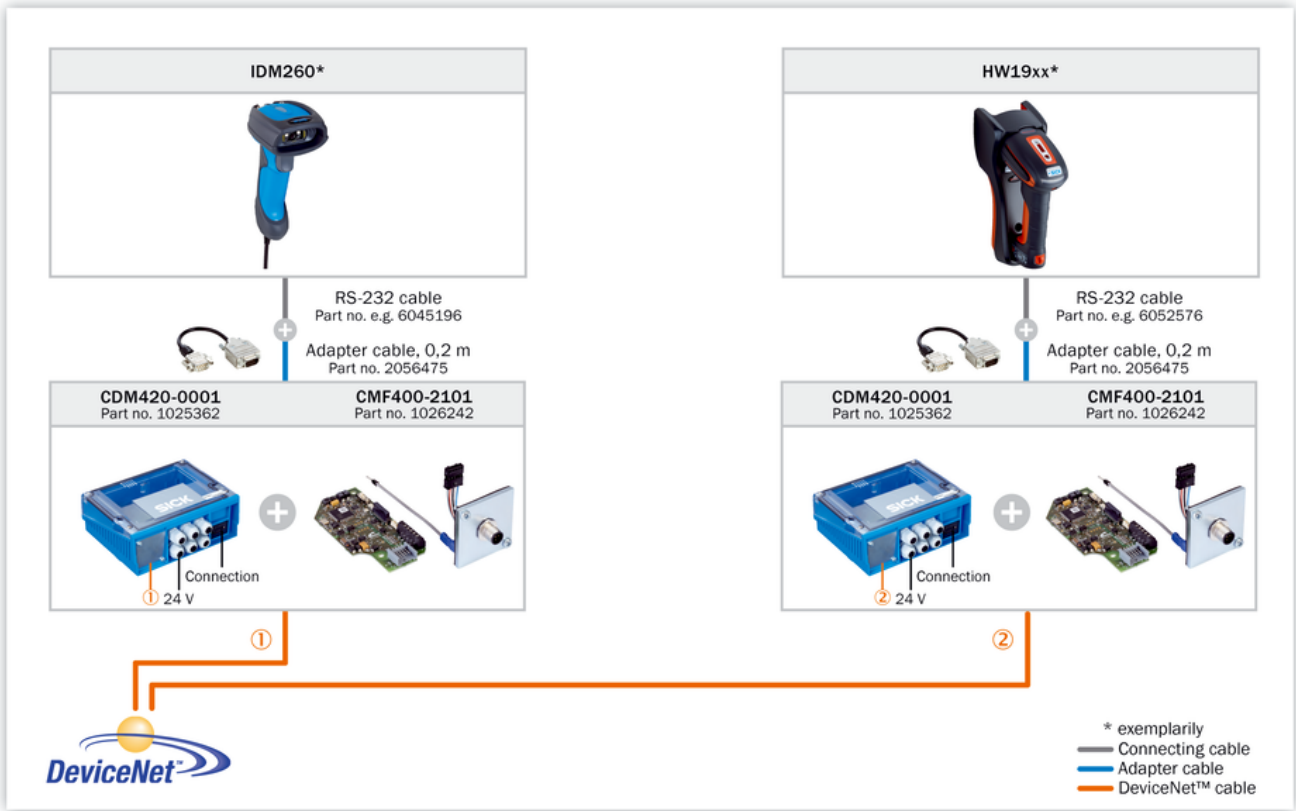

AUX looping

Looping-in via AUX

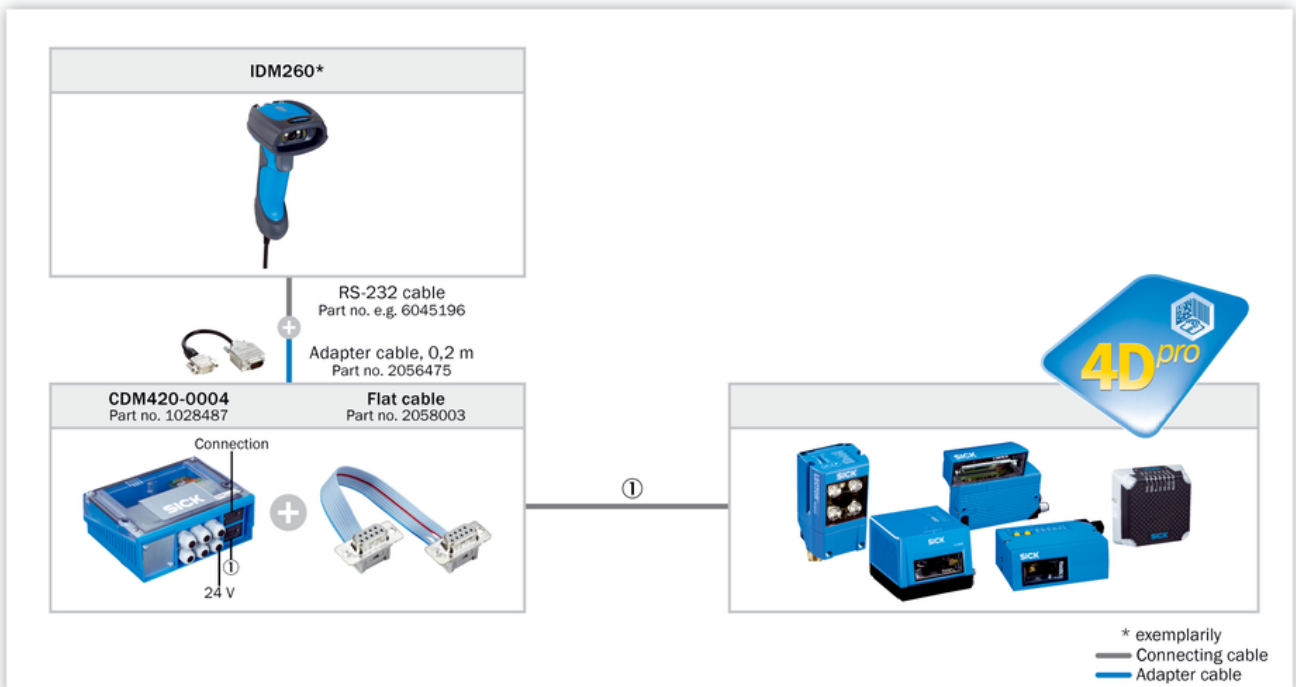

Selection Guide

IDMx4x

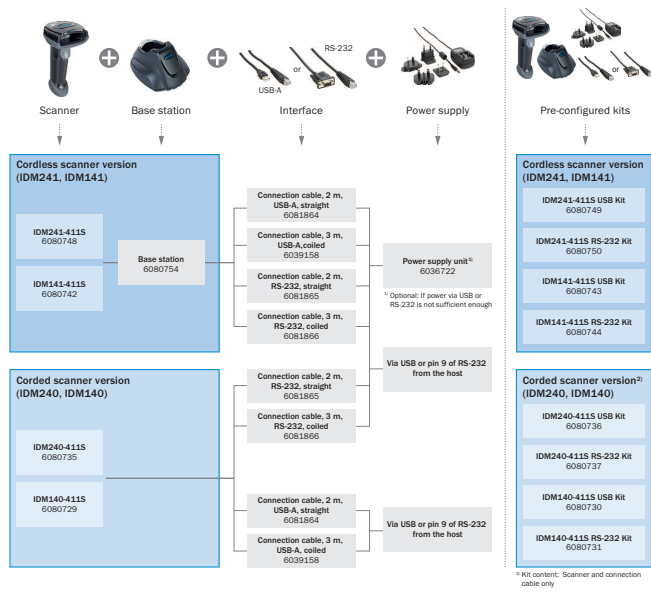

Accessories

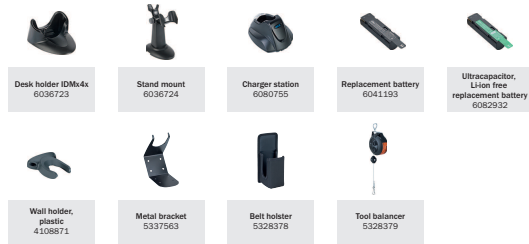

IDMx6x

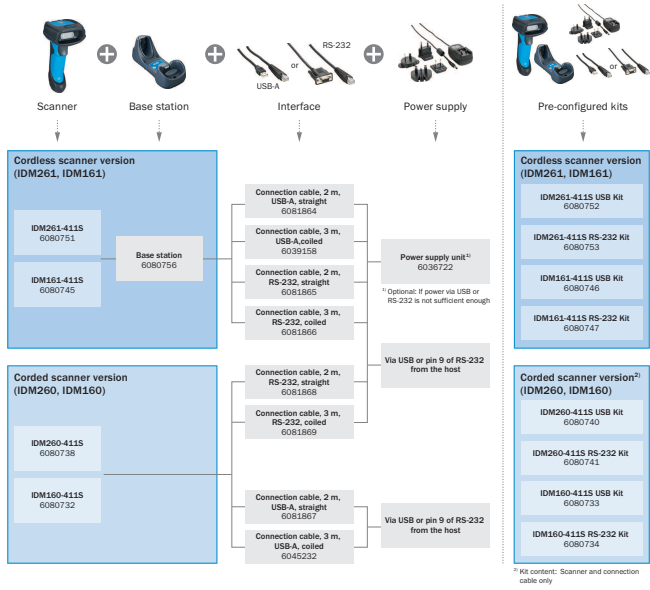

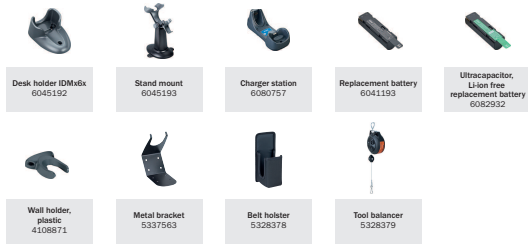

Accessories





Recommended accessories

Other models and accessories → www.sick.com/IDM

	Brief description	Type	Part no.
Other adapters			
	Adapter for connecting a handheld scanner to CDB620 / CDM420 / CDF600 / CD-F600-2, D-Sub 9-pin male connector, D-Sub 15-pin male connector, including 24V / 5V DC converter, AUX port adapter, for handheld scanners to CDB620/CDM420/CDF600/CDF600-2, adapter AUX port	YMHDAC-C30XXMDSA9	2056475
	Connection kit for connecting a hand-held scanner to a PROFINET (Siemens) interface		On request

Recommended services

Additional services → www.sick.com/IDM

	Type	Part no.
Extended warranty		
<ul style="list-style-type: none">• Product area: Identification solutions, machine vision, Distance sensors, Detection and ranging solutions• Range of services: The services correspond to the scope of the statutory manufacturer warranty (SICK general terms of delivery).• Duration: Five-year warranty from delivery date.	Extended warranty for a total of five years from delivery date	1680671

SICK AT A GLANCE

SICK is one of the leading manufacturers of intelligent sensors and sensor solutions for industrial applications. A unique range of products and services creates the perfect basis for controlling processes securely and efficiently, protecting individuals from accidents and preventing damage to the environment.

We have extensive experience in a wide range of industries and understand their processes and requirements. With intelligent sensors, we can deliver exactly what our customers need. In application centers in Europe, Asia and North America, system solutions are tested and optimized in accordance with customer specifications. All this makes us a reliable supplier and development partner.

Comprehensive services complete our offering: SICK LifeTime Services provide support throughout the machine life cycle and ensure safety and productivity.

For us, that is “Sensor Intelligence.”

WORLDWIDE PRESENCE:

Contacts and other locations –www.sick.com