



# IDM141-411S USB Kit

IDM

MOBILE HANDHELD SCANNERS

**SICK**  
Sensor Intelligence.



### Ordering information

Type	Part no.
IDM141-411S USB Kit	6080743

**Included in delivery:** Base station (1), IDM141-411S (1), Power supply unit (1), Connection cable (1)

Should you require further technical data, this can be found with the single scanner and the other parts of the kit.

Other models and accessories → [www.sick.com/IDM](http://www.sick.com/IDM)



### Detailed technical data

#### Features

<b>Version</b>	Standard Range
<b>Application</b>	Standard application
<b>Scanner design</b>	Wireless variant
<b>Light source</b>	LED, Visible, Red, 630 nm
<b>Reading distance</b>	20 mm ... 850 mm <sup>1)</sup>
<b>Scanning frequency</b>	≤ 500 Hz
<b>Code resolution</b>	≥ 0.076 mm

<sup>1)</sup> For details see reading field diagram.

#### Mechanics/electronics

<b>Supply voltage</b>	3.7 V DC ... 5 V <sup>1)</sup>
<b>Current consumption</b>	Operation: 180 mA Standby: 80 mA
<b>Housing color</b>	Black/gray
<b>Enclosure rating</b>	IP52
<b>Weight</b>	230 g, incl. rechargeable battery
<b>Dimensions (L x W x H)</b>	97.8 mm x 70.5 mm x 156.2 mm

<sup>1)</sup> Rechargeable battery operation.

#### Performance

<b>Readable code structures</b>	1D codes, Stacked
<b>Bar code types</b>	Code 39, Code 39 Full ASCII, Code 32, Code 128, GS1-128, Codabar, Code 11, Code 93, GS1 DataBar, Standard and Industrial 2 of 5, Interleaved & Matrix 2 of 5, IATA, UPC / EAN / JAN, UPC / EAN / JAN (with addition), Telepen, MSI/Plessey, UK/Plessey, Australian Post, China Post, German Post, US Planet, US Postnet, British Post, Intelligent Mail, Japan Post, Korea Post, Dutch KIX Post, Posi LAPA 4 State Code
<b>Stacked code types</b>	PDF417, MicroPDF417, Composite Code

<b>Battery power</b>	Over 60,000 scans with full battery
<b>Code buffer</b>	80,000 Codes (EAN)

### Interfaces

<b>USB</b>	✓
Function	Keyboard wedge, COM-Port emulation
<b>Optical indicators</b>	2 LEDs (good read, charge of battery, radio connection status)
<b>Acoustic indicators</b>	Beeper, can be switched off
<b>Vibration</b>	No
<b>Configuration software</b>	IDM Setup Tool

### Ambient data

<b>Shock resistance</b>	25 drops from 1.8 m height on concrete
<b>Ambient operating temperature</b>	-10 °C ... +50 °C
<b>Storage temperature</b>	-40 °C ... +70 °C
<b>Permissible relative humidity</b>	± 95 %, Non-condensing
<b>Ambient light immunity</b>	100,000 lx

### General notes

<b>Items supplied</b>	The battery is included in delivery
<b>Note</b>	Not free of paint wetting impairment substances.

### Classifications

<b>eCl@ss 5.0</b>	27280101
<b>eCl@ss 5.1.4</b>	27280101
<b>eCl@ss 6.0</b>	27280101
<b>eCl@ss 6.2</b>	27280101
<b>eCl@ss 7.0</b>	27280101
<b>eCl@ss 8.0</b>	27280101
<b>eCl@ss 8.1</b>	27280101
<b>eCl@ss 9.0</b>	27280101
<b>eCl@ss 10.0</b>	27280101
<b>eCl@ss 11.0</b>	27280101
<b>eCl@ss 12.0</b>	27280101
<b>ETIM 5.0</b>	EC002550
<b>ETIM 6.0</b>	EC002550
<b>ETIM 7.0</b>	EC002550
<b>ETIM 8.0</b>	EC002550
<b>UNSPSC 16.0901</b>	43211701

Connection diagram

PROFINET IO/RT

PROFINET IO/RT

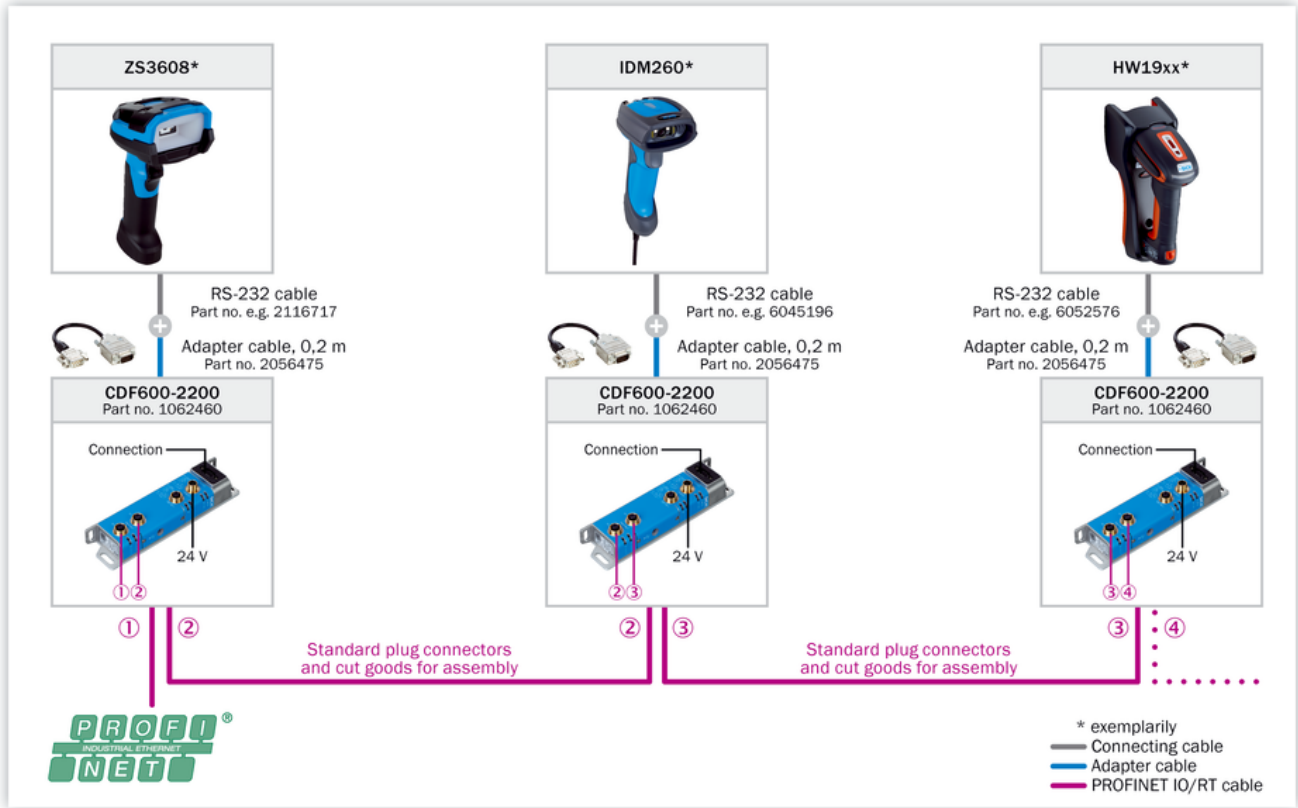

PROFIBUS DP

PROFIBUS DP

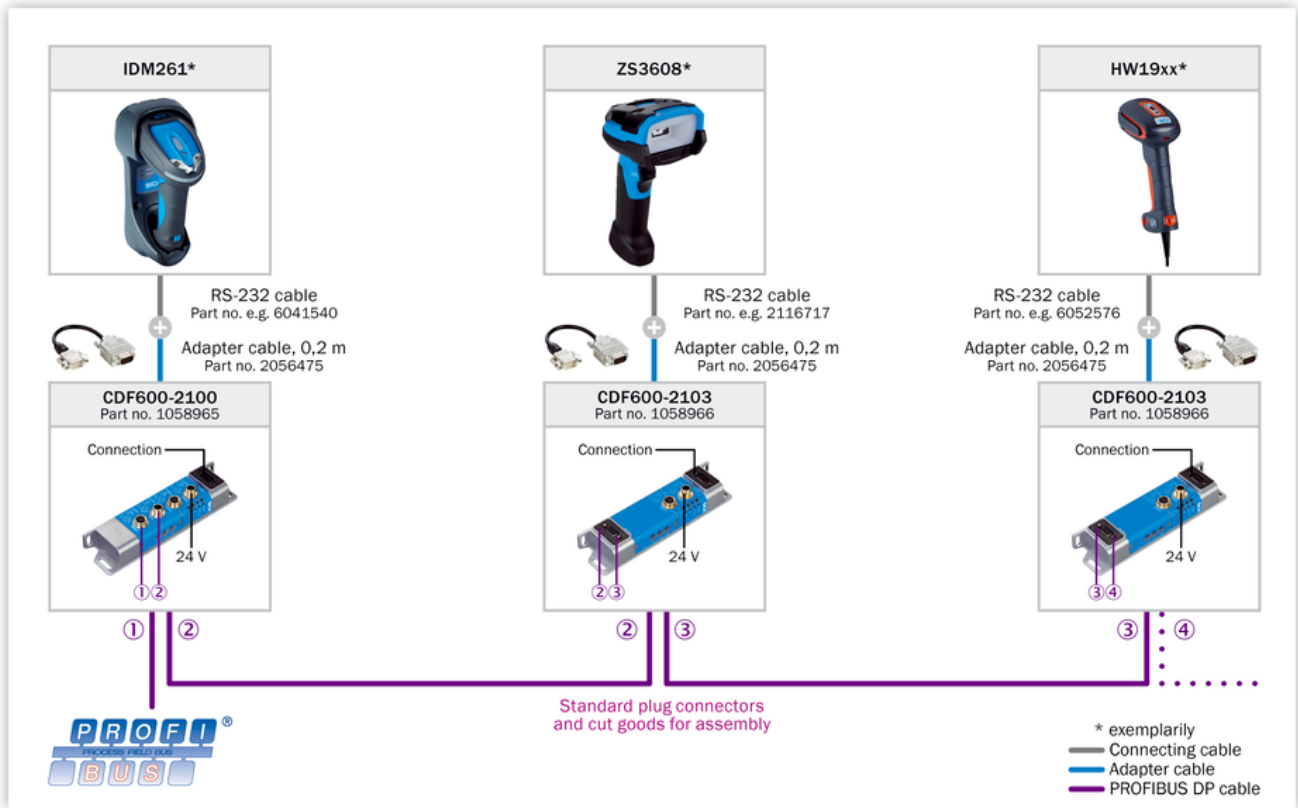

Ethernet TCP/IP

### Ethernet TCP/IP

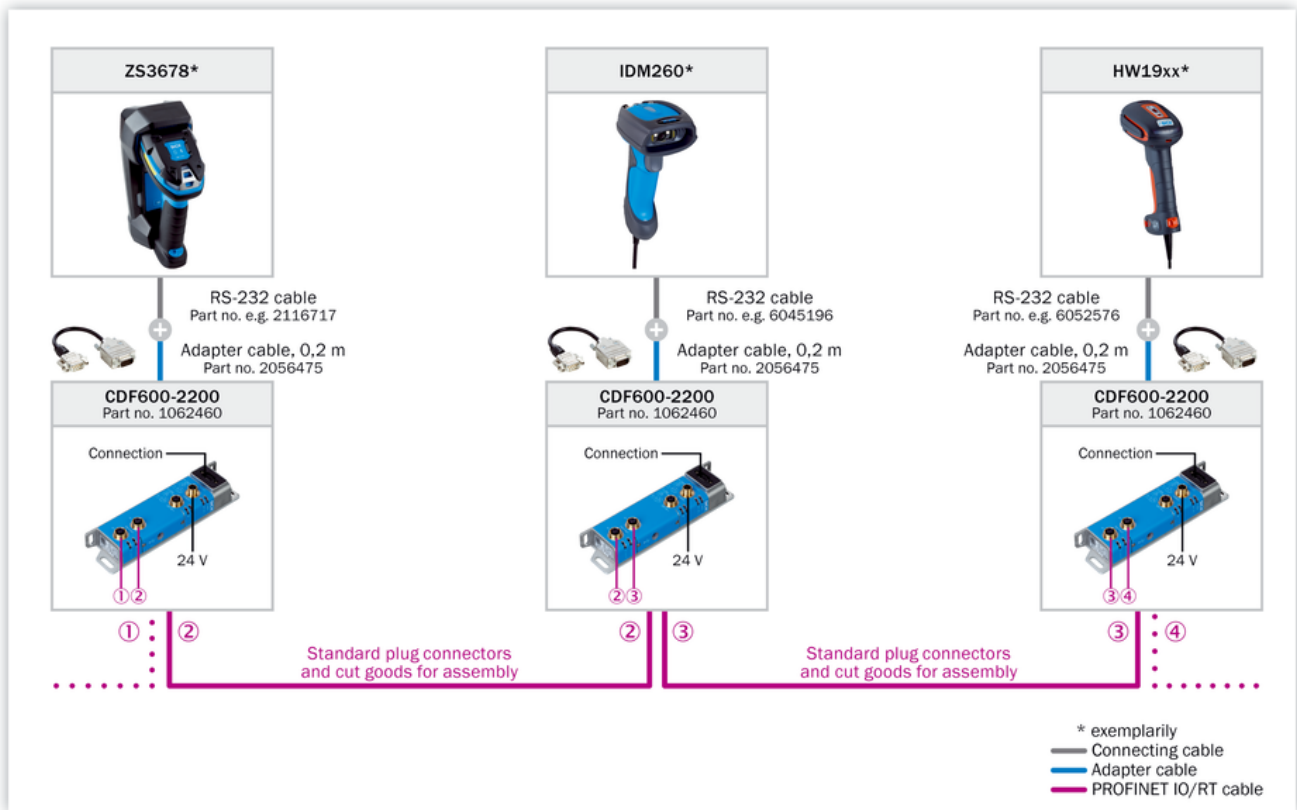

EtherCAT®

EtherCAT®

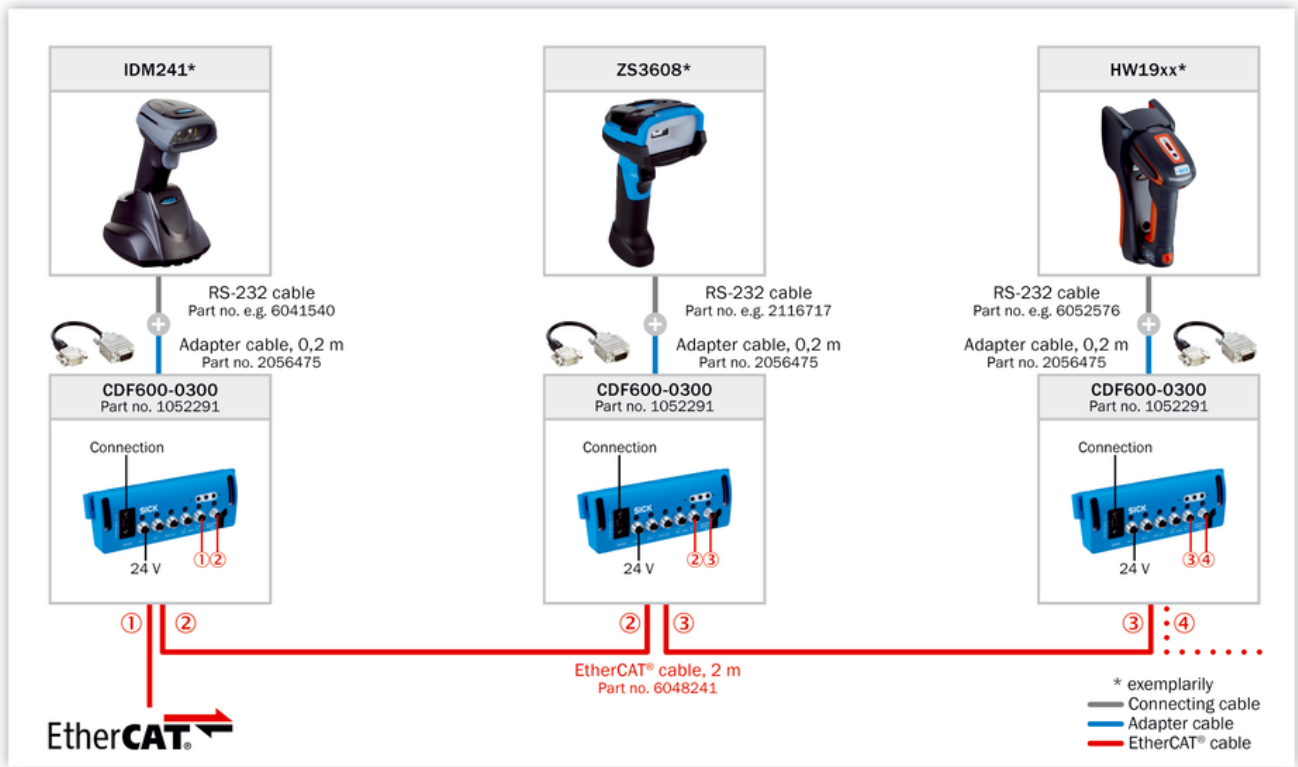

DeviceNet™

## DeviceNet™



AUX looping

## Looping-in via AUX

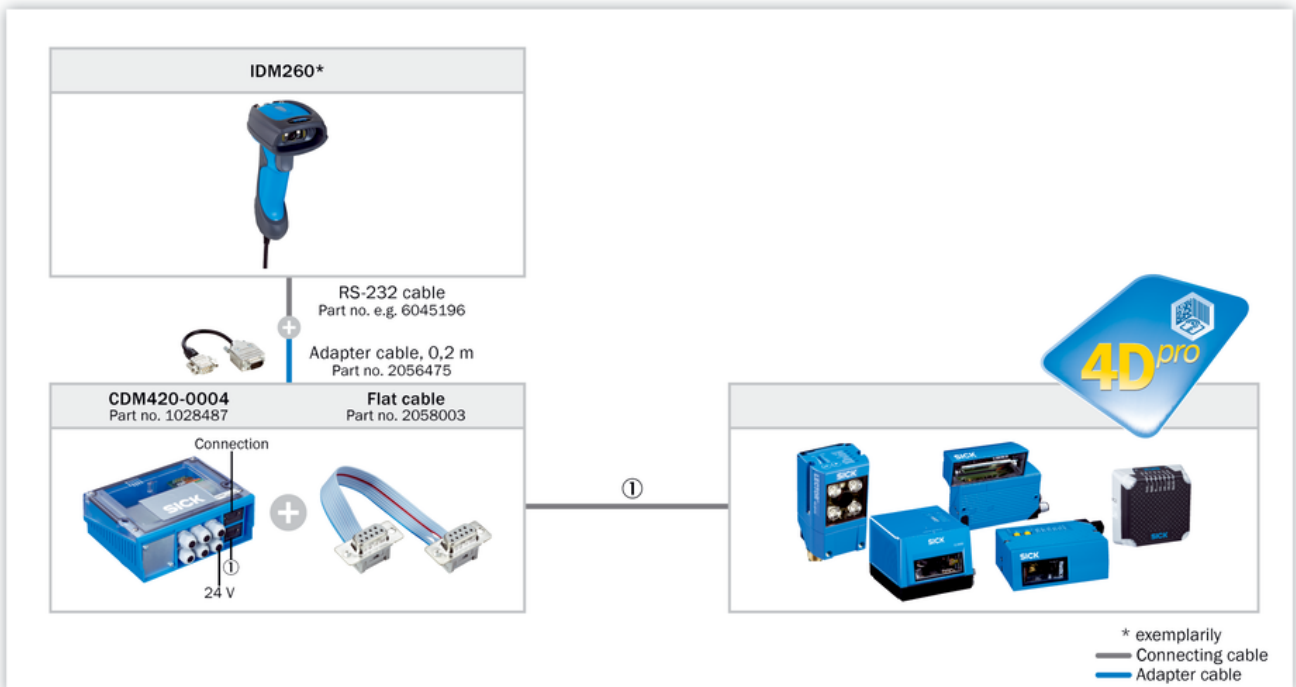



## Selection Guide

### IDMx4x

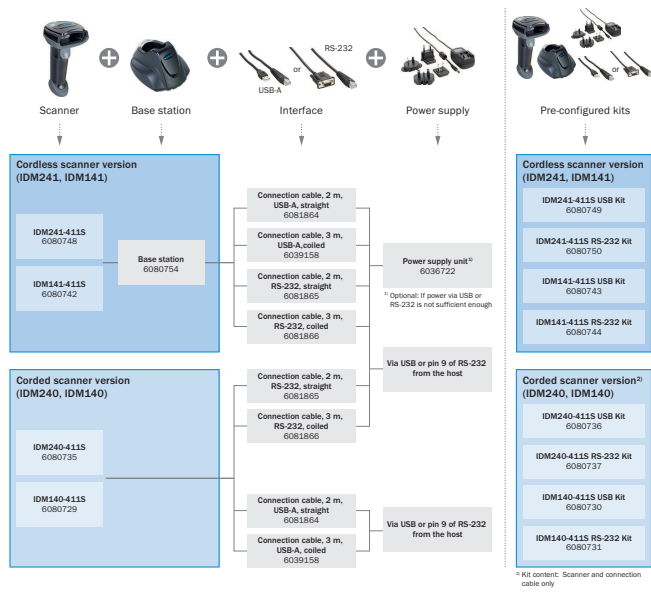

#### Accessories

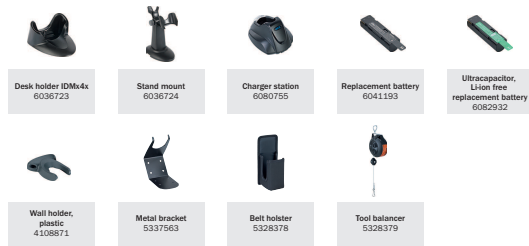

### IDMx6x

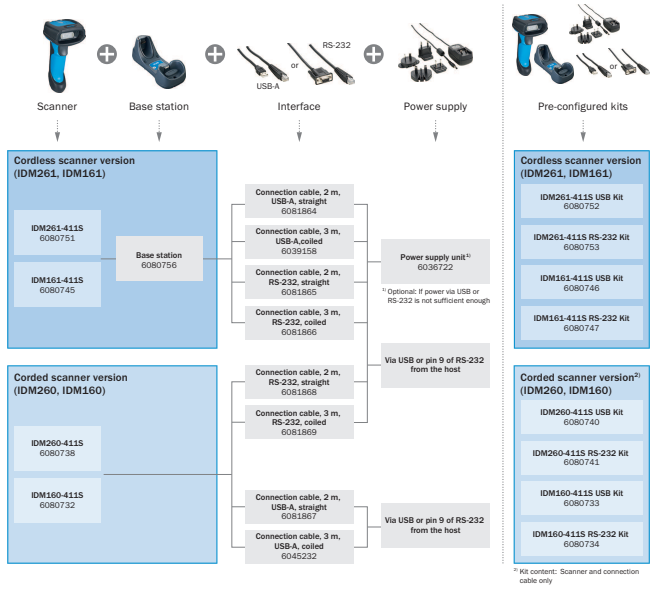

### Accessories

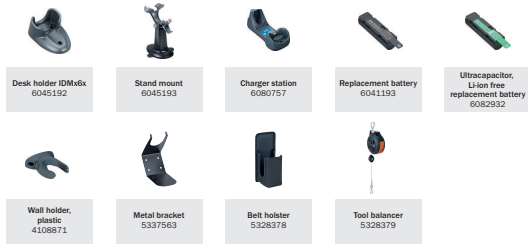



## Recommended services

Additional services → [www.sick.com/IDM](http://www.sick.com/IDM)

	Type	Part no.
Extended warranty		
<ul style="list-style-type: none"> <li><b>Product area:</b> Identification solutions, machine vision, Distance sensors, Detection and ranging solutions</li> <li><b>Range of services:</b> The services correspond to the scope of the statutory manufacturer warranty (SICK general terms of delivery).</li> <li><b>Duration:</b> Five-year warranty from delivery date.</li> </ul>	Extended warranty for a total of five years from delivery date	1680671

## SICK AT A GLANCE

SICK is one of the leading manufacturers of intelligent sensors and sensor solutions for industrial applications. A unique range of products and services creates the perfect basis for controlling processes securely and efficiently, protecting individuals from accidents and preventing damage to the environment.

We have extensive experience in a wide range of industries and understand their processes and requirements. With intelligent sensors, we can deliver exactly what our customers need. In application centers in Europe, Asia and North America, system solutions are tested and optimized in accordance with customer specifications. All this makes us a reliable supplier and development partner.

Comprehensive services complete our offering: SICK LifeTime Services provide support throughout the machine life cycle and ensure safety and productivity.

For us, that is “Sensor Intelligence.”

## WORLDWIDE PRESENCE:

Contacts and other locations –[www.sick.com](http://www.sick.com)