

I.622 | Tapered handles

Technopolymer



- 1
- 2
- 3
- 4
- 5
- 6
- 7
- 8
- 9
- 10
- 11
- 12
- 13
- 14
- 15
- 16
- 17
- 18

MATERIAL

Polyamide based (PA) technopolymer, in Elecolors colours, glossy finish.

STANDARD EXECUTION

Threaded blind hole.

SPECIAL EXECUTIONS ON REQUEST

Different RAL colours.



ELESA Original design

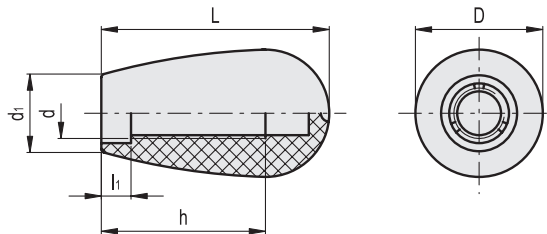

*Complete with colour index, example: 120912 I.622/25-M6-C2



| Code C9 | Code C2 | Code C3 | Code C4 | Code C5 | Code C6 | Code C17 | Description | D | L | d | d1 | h | l1 | ⚖️ |
|---------|---------|---------|---------|---------|---------|----------|----------------|----|------|-----|----|----|-----|----|
| 120911 | 120912 | 120913 | 120914 | 120915 | 120916 | 120917 | I.622/25-M6-* | 16 | 25 | M6 | 12 | 16 | 3.5 | 4 |
| 120951 | 120952 | 120953 | 120954 | 120955 | 120956 | 120957 | I.622/30-M8-* | 20 | 32 | M8 | 14 | 20 | 3.5 | 7 |
| 120991 | 120992 | 120993 | 120994 | 120995 | 120996 | 120997 | I.622/40-M8-* | 26 | 42 | M8 | 17 | 30 | 5 | 18 |
| 121001 | 121002 | 121003 | 121004 | 121005 | 121006 | 121007 | I.622/40-M10-* | 26 | 42 | M10 | 17 | 30 | 5 | 16 |
| 121061 | 121062 | 121063 | 121064 | 121065 | 121066 | 121067 | I.622/55-M10-* | 34 | 54.5 | M10 | 21 | 35 | 8 | 34 |
| 121071 | 121072 | 121073 | 121074 | 121075 | 121076 | 121077 | I.622/55-M12-* | 34 | 54.5 | M12 | 21 | 35 | 8 | 32 |

Fixed & Revolving handles