

Tactile Switches, .236 [6] x .236 [6], Low Profile, Surface Mount

MATERIAL SPECIFICATIONS:

ContactsCopper Alloy, silver clad plated
 Case MaterialPPS
 StemPPS
 Cover.....Steel, tin-plate
 TerminalsCopper alloy, silver plated

TYPICAL PERFORMANCE CHARACTERISTICS:

Contact Rating50mA @ 12 VDC
 Initial Contact Resistance100 Milliohms max.
 Insulation Resistance100 Megohms min. @ 100 VDC
 Dielectric Strength500 VAC, 1 minute
 Actuation ForceSee Below.
 Life ExpectancyUp to 100,000 Cycles

ENVIRONMENTAL SPECIFICATIONS:

Operating Temperature.....-4°F to +185°F (-20°C to +85°C)
 Storage Temperature.....-22°F to +185°F (-30°C to +85°C)
 Solder Heat ResistanceIR Soldering EIA-364-56
 Procedure 5 Level 2, 464°F (240°C)



FSM1LP

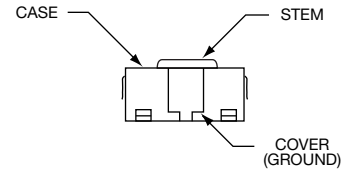
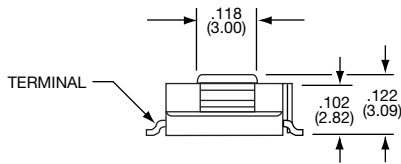
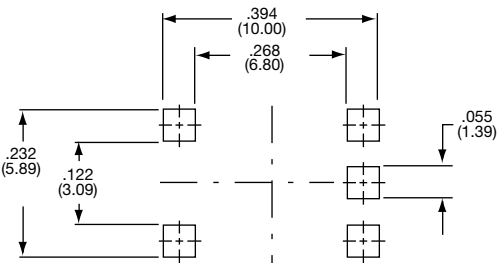
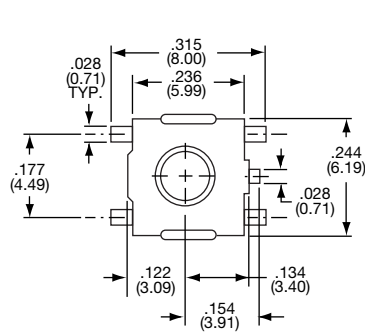

FSM4LP

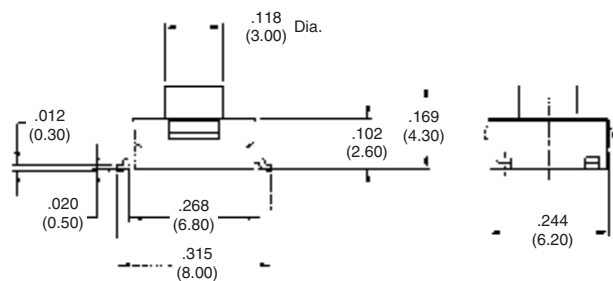
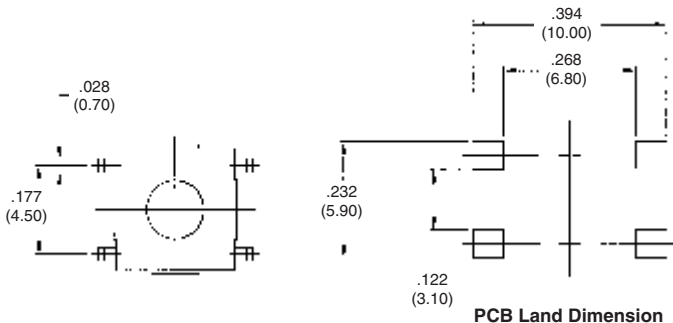

PCB Land Dimension

| Tyco Electronics | Alcoswitch | Force | Actuator Packaging |
|------------------|------------|-------|--------------------|
| 1-1437565-6 | FSM1LP | 160 | Bulk |
| 1-1437565-7 | FSM1LPA | 260 | Bulk |
| 1-1437565-9 | FSM1LPTR | 160 | Tape & Reel |
| 1-1437565-8 | FSM1LPATR | 260 | Tape & Reel |
| 1571621-1 | FSM4LP | 260 | Bulk |
| 4-1437565-3 | FSM4LPTR | 260 | Tape & Reel |

Tactile Switches, .472 [12] x .472 [12], Flush or Extended Actuators

MATERIAL SPECIFICATIONS:

ContactsCopper alloy, silver clad plate
 Case.....PBT
 Actuator ButtonPolyacetal Resin
 Cover.....PET film
 TerminalsCopper alloy, silver plate
 Frame (R/A)Nylon

TYPICAL PERFORMANCE CHARACTERISTICS:

Contact Rating50 mA @ 12 VDC
 Initial Contact Resistance100 Milliohms max.
 Insulation Resistance100 Megohms min. @100 VDC
 Dielectric Strength500 VAC for 1 minute
 Actuation ForceSee below
 Actuator Travel.....0.012"(0.3)
 Life ExpectancyUp to 100,000 cycles

ENVIRONMENTAL SPECIFICATIONS

Operating Temperature.....4°F to +185°F (-20°C to +85°C)
 Storage Temperature.....-22°F to +185°F (-30°C to +85°C)
 Solder Heat ResistanceSee Page M3-4



FSM100

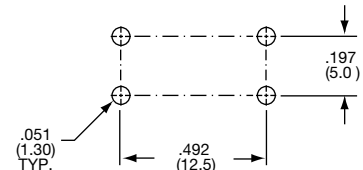
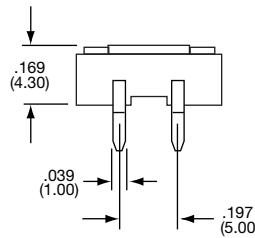
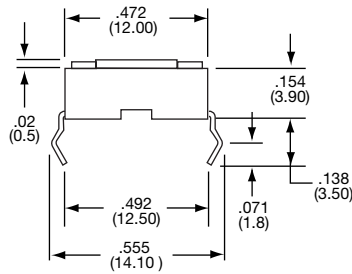
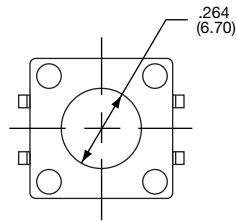

| Tyco Electronics | Alcoswitch | Type | | | Force |
|------------------|------------|------|-----|------|----------|
| 1437565-2 | FSM100 | SPST | Off | (On) | 160±50gf |
| 1571139-1 | FSM100A | SPST | Off | (On) | 260±50gf |

(On) indicates momentary position.



FSM101

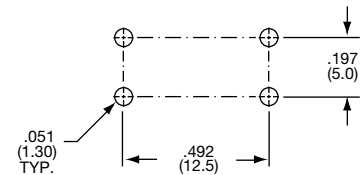
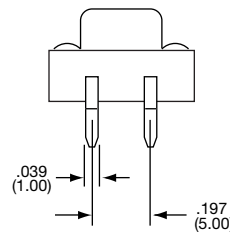
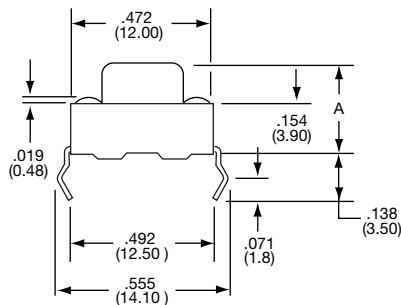
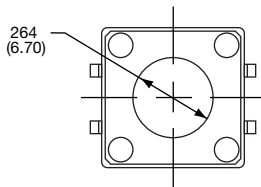

| Tyco Electronics | Alcoswitch | Type | | | Force | Dim A |
|------------------|------------|------|-----|------|----------|--------------|
| 1437565-3 | FSM101 | SPST | Off | (On) | 160±50gf | .295 [7.5mm] |
| 1571140-1 | FSM201A | SPST | Off | (On) | 260±50gf | .335 [8.5mm] |

(On) indicates momentary position.

E
FSM100-104 Series

Tactile Switches, .472 [12] x .472 [12], Vertical or Right Angle

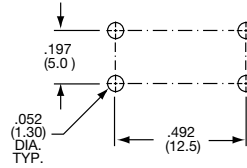
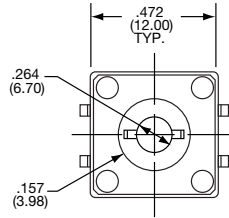
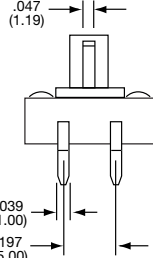
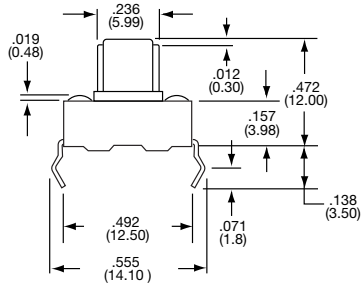

FSM102

| Tyco Electronics | Alcoswitch | Type | | | Force |
|------------------|------------|------|-----|------|----------|
| 1437565-4 | FSM102 | SPST | Off | (On) | 160±50gf |
| 1571061-1 | FSM102A | SPST | Off | (On) | 260±50gf |

(On) indicates momentary position.

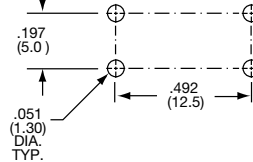
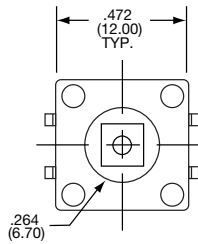
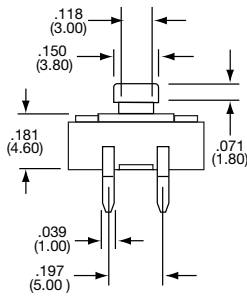
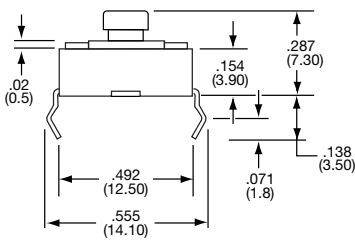

FSM103

| Tyco Electronics | Alcoswitch | Type | | | Force |
|------------------|------------|------|-----|------|----------|
| 1437565-5 | FSM103 | SPST | Off | (On) | 160±50gf |

(On) indicates momentary position.

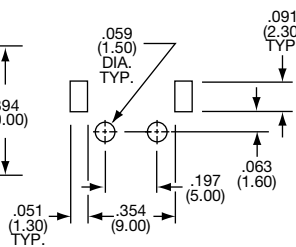
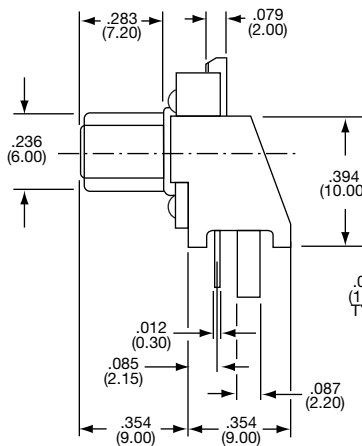
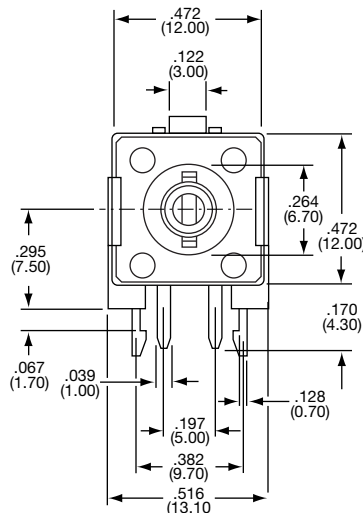

| Tyco Electronics | Alcoswitch | Type | | | Force |
|------------------|------------|------|-----|------|----------|
| 1437565-6 | FSM104 | SPST | Off | (On) | 160±50gf |

(On) indicates momentary position.



Tactile Switches, Sealed .472 [12] x .472 [12], Surface Mount, Projected Actuator

MATERIAL SPECIFICATIONS:

CaseThermoplastic, UL94V-0, Black
 Stem/ActuatorThermoplastic, UL94V-0, Black
 CoverStainless Steel
 SealSilicone Rubber, Black
 Contact.....Stainless Steel, Plating—Silver
 TerminalCopper Alloy, Plating—Silver/Nickel

TYPICAL PERFORMANCE CHARACTERISTICS:

Contact Rating50mA @ 12 V DC
 Initial Contact Resistance100MilliOhms Max
 Insulation Resistance100Megaohms @ 100VDC Min.
 Dielectric Strength500 VAC
 Actuation Travel.....0.014 +/- .008 (.35 +/- .20)
 LifeUp to 1,000,000 Cycles

ENVIRONMENTAL SPECIFICATIONS:

Operating Temperature-4 to +185°F (-20 to +70°C)
 Storage Temperature-4 to +185°F (-20 to +70°C)
 Resistance to solder heatPer EIA-364-56, Procedure 4 & 5, Level 3
 SolderabilityPer EIA RS-186-9E
 SealPer IP67

E

Sealed Tactile Switches

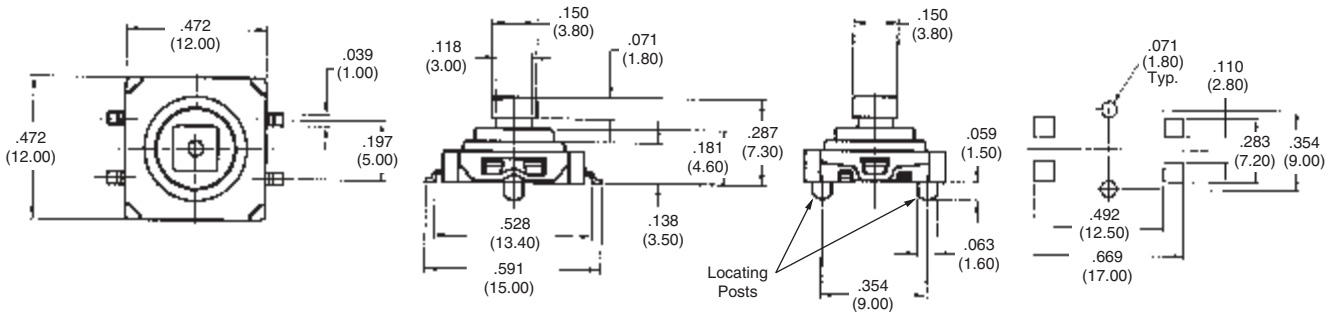

| Tyco Electronics | Locating Post | Packaging | Actuator Height | Force |
|------------------|---------------|-----------|-----------------|----------|
| 1571217-1 | No | Bulk | .287 (7.30) | 160±70gf |
| 1571217-2 | Yes | Bulk | .287 (7.30) | 160±70gf |
| 1571217-3 | No | T&R | .287 (7.30) | 160±70gf |
| 1571217-4 | Yes | T&R | .287 (7.30) | 160±70gf |

Tactile Switches, Sealed .472 [12] x .472 [12], Surface Mount, Flush, Actuator

MATERIAL SPECIFICATIONS:

CaseThermoplastic, UL94V-0, Black
 Stem/ActuatorThermoplastic, UL94V-0, Black
 CoverStainless Steel
 SealSilicone Rubber, Black
 Contact.....Stainless Steel, Plating—Silver
 TerminalCopper Alloy, Plating—Silver/Nickel

TYPICAL PERFORMANCE CHARACTERISTICS:

Contact Rating50mA @ 12 V DC
 Initial Contact Resistance100MilliOhms Max
 Insulation Resistance100Megaohms @ 100VDC Min.
 Dielectric Strength500 VAC
 Actuation Travel.....0.014 +/-0.008 (.35 +/--.20)
 LifeUp to 1,000,000 Cycles

ENVIRONMENTAL SPECIFICATIONS:

Operating Temperature-4 to +185°F (-20 to +85°C)
 Storage Temperature-4 to +185°F (-20 to +85°C)
 Resistance to solder heatPer EIA-364-56, Procedure 4 & 5, Level 3
 SolderabilityPer EIA RS-186-9E
 SealPer IP67

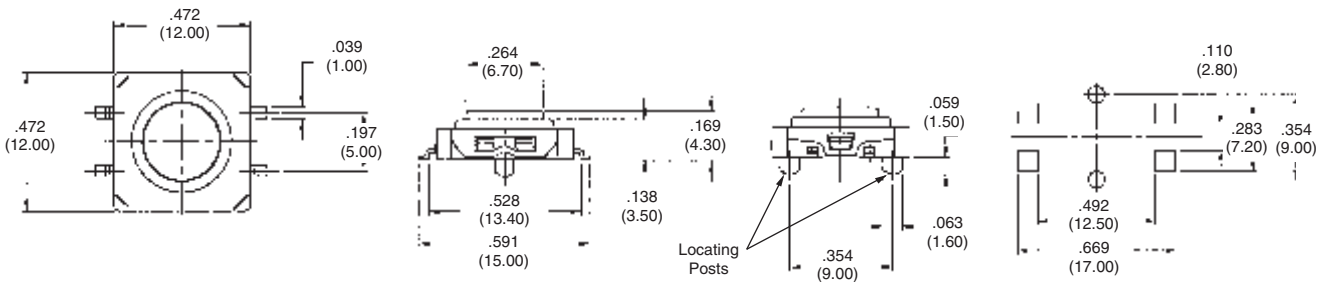

| Tyco Electronics | Locating Post | Packaging | Actuator Height | Force |
|------------------|---------------|-----------|-----------------|----------|
| 1571218-1 | No | Bulk | .169 (4.30) | 160±70gf |
| 1571218-2 | Yes | Bulk | .169 (4.30) | 160±70gf |
| 1571218-3 | No | T&R | .169 (4.30) | 160±70gf |
| 1571218-4 | Yes | T&R | .169 (4.30) | 160±70gf |

E
Sealed Tactile Switches

Tactile Switches, Sealed .472 [12] x .472 [12], Thru-Hole, Projected Actuator

MATERIAL SPECIFICATIONS:

CaseThermoplastic, UL94V-0, Black
 Stem/ActuatorThermoplastic, UL94V-0, Black
 CoverStainless Steel
 SealSilicone Rubber, Black
 Contact.....Stainless Steel, Plating—Silver
 TerminalCopper Alloy, Plating—Silver/Nickel

TYPICAL PERFORMANCE CHARACTERISTICS:

Contact Rating50mA @ 12 V DC
 Initial Contact Resistance100MilliOhms Max
 Insulation Resistance100Megaohms @ 100VDC Min.
 Dielectric Strength500 VAC
 Actuation Travel.....0.014 +/-0.008 (.35 +/- .20)
 Life1,000,000 Cycles

ENVIRONMENTAL SPECIFICATIONS:

Operating Temperature-4 to +185°F (-20 to +85°C)
 Storage Temperature-4 to +185°F (-20 to +85°C)
 Resistance to solder heatPer EIA-364-56, Procedure 3, Test Cond. B
 SolderabilityPer EIA RS-186-9E
 SealPer IP67

E

Sealed Tactile Switches

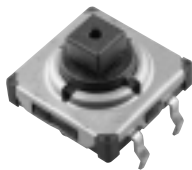
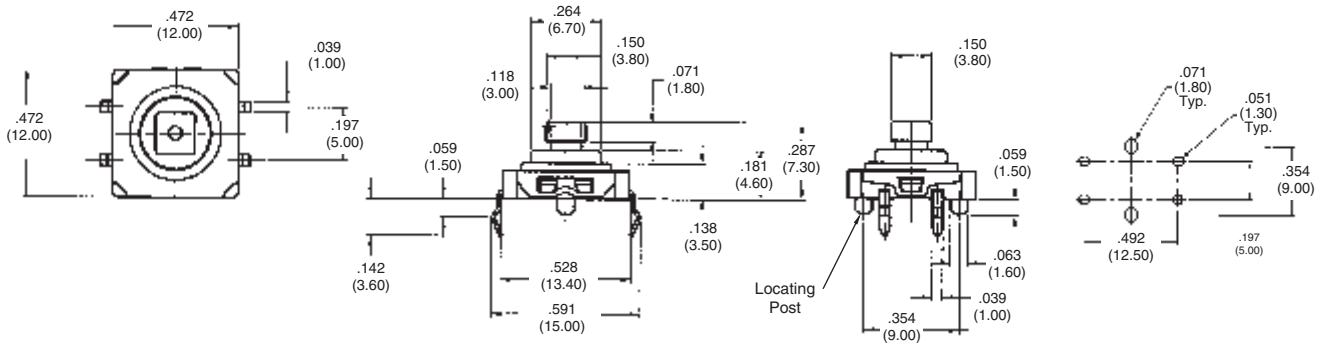

| Tyco Electronics | Locating Post | Packaging | Actuator Height | Force |
|------------------|---------------|-----------|-----------------|----------|
| 1571219-1 | No | Bulk | .287 (7.30) | 160±70gf |
| 1571219-2 | Yes | Bulk | .287 (7.30) | 160±70gf |

Tactile Switches, Sealed .472 [12] x .472 [12], Thru-Hole, Flush Actuator

MATERIAL SPECIFICATIONS:

CaseThermoplastic, UL94V-0, Black
 Stem/ActuatorThermoplastic, UL94V-0, Black
 CoverStainless Steel
 SealSilicone Rubber, Black
 Contact.....Stainless Steel, Plating—Silver
 TerminalCopper Alloy, Plating—Silver/Nickel

TYPICAL PERFORMANCE CHARACTERISTICS:

Contact Rating50mA @ 12 V DC
 Initial Contact Resistance100MilliOhms Max
 Insulation Resistance100Megaohms @ 100VDC Min.
 Dielectric Strength500 VAC
 Actuation Travel.....0.014 +/-0.008 (.35 +/-0.20)
 Life1,000,000 Cycles

ENVIRONMENTAL SPECIFICATIONS:

Operating Temperature-4 to +185°F (-20 to +85°C)
 Storage Temperature-4 to +185°F (-20 to +85°C)
 Resistance to solder heatPer EIA-364-56, Procedure 3, Test Cond. B
 SolderabilityPer EIA RS-186-9E
 SealPer IP67

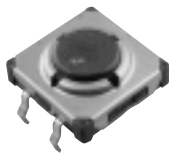
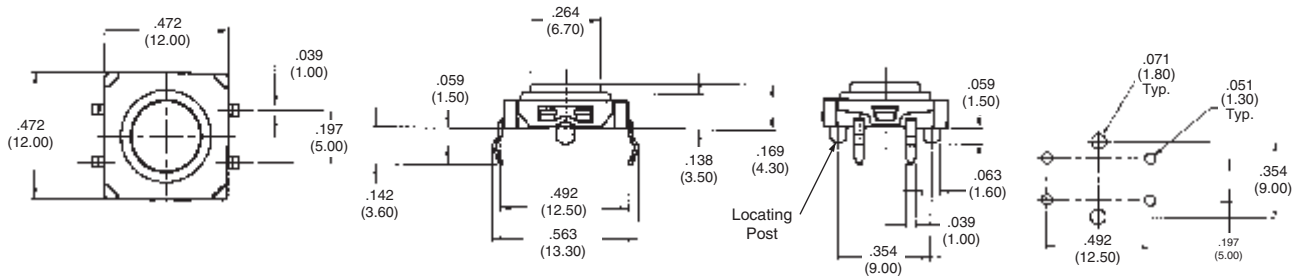

| Tyco Electronics | Locating Post | Packaging | Actuator Height | Force |
|------------------|---------------|-----------|-----------------|----------|
| 1571220-1 | No | Bulk | .169 (4.30) | 160±70gf |
| 1571220-2 | Yes | Bulk | .169 (4.30) | 160±70gf |

E
Sealed Tactile Switches

Tactile Switches, Sealed .299 [7.6] x .287 [7.3], Surface Mount, Extended Actuator

MATERIAL SPECIFICATIONS:

CaseThermoplastic, UL94V-0, Black
 Stem/ActuatorThermoplastic, UL94V-0, Black
 CoverStainless Steel
 SealSilicone Rubber, Black
 Contact.....Stainless Steel, Plating—Silver
 TerminalCopper Alloy, Plating—Silver

TYPICAL PERFORMANCE CHARACTERISTICS:

Contact Rating50mA @ 12 V DC
 Initial Contact Resistance100MilliOhms Max
 Insulation Resistance100Megaohms @ 100VDC Min.
 Dielectric Strength500 VAC
 Actuation Travel.....0.014 +/- .008 (.35 +/- .20)
 LifeUp to 1,000,000 Cycles

ENVIRONMENTAL SPECIFICATIONS:

Operating Temperature-4 to +185°F (-20 to +85°C)
 Storage Temperature-4 to +185°F (-20 to +85°C)
 Resistance to solder heatPer EIA-364-56, Procedure 4 & 5, Level 3
 SolderabilityPer EIA RS-186-9E
 SealPer IP67

E

Sealed Tactile Switches

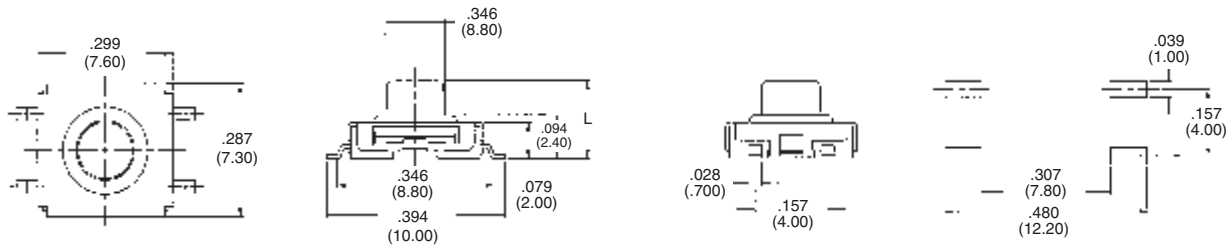

| Tyco Electronics | Packaging | L | Force |
|------------------|-----------|-------------|----------|
| 1571294-1 | Bulk | .169 (4.30) | 160±50gf |
| 1571294-2 | T&R | .169 (4.30) | 160±50gf |
| 1571294-3 | Bulk | .197 (5.00) | 160±50gf |
| 1571294-4 | T&R | .197 (5.00) | 160±50gf |

Tactile Switches, Sealed .299 [7.6] x .287 [7.3], Surface Mount, Flush Actuator

MATERIAL SPECIFICATIONS:

CaseThermoplastic, UL94V-0, Black
 Stem/ActuatorThermoplastic, UL94V-0, Black
 CoverStainless Steel
 SealSilicone Rubber, Black
 Contact.....Stainless Steel, Plating—Silver
 TerminalCopper Alloy, Plating—Silver/Nickel

TYPICAL PERFORMANCE CHARACTERISTICS:

Contact Rating50mA @ 12 V DC
 Initial Contact Resistance100MilliOhms Max
 Insulation Resistance100Megaohms @ 100VDC Min.
 Dielectric Strength500 VAC
 Actuation Travel.....0.014 +/- .008 (.35 +/- .20)
 LifeUp to 1,000,000 Cycles

ENVIRONMENTAL SPECIFICATIONS:

Operating Temperature-4 to +185°F (-20 to +85°C)
 Storage Temperature-4 to +185°F (-20 to +85°C)
 Resistance to solder heatPer EIA-364-56, Procedure 4 & 5, Level 3
 SolderabilityPer EIA RS-186-9E
 SealPer IP67

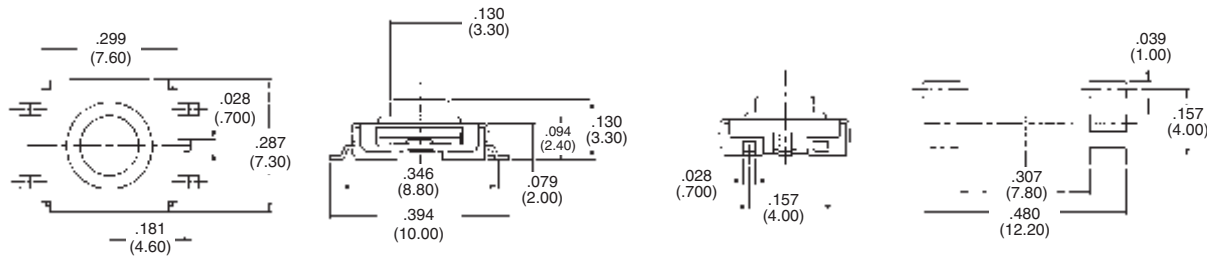

| Tyco Electronics | Packaging | Actuator Height | Force |
|------------------|-----------|-----------------|----------|
| 1571296-1 | Bulk | .130 (3.30) | 160±50gf |
| 1571296-2 | T&R | .130 (3.30) | 160±50gf |

E
Sealed Tactile Switches

Tactile Switches, Sealed .299 [7.6] x .287 [7.3], Thru-Hole, Extended Actuator

MATERIAL SPECIFICATIONS:

CaseThermoplastic, UL94V-0, Black
 ActuatorThermoplastic, UL94V-0, Black
 CoverStainless Steel
 SealSilicone Rubber, Black
 Contact.....Stainless Steel, Plating—Silver
 TerminalCopper Alloy, Plating—Silver/Nickel

TYPICAL PERFORMANCE CHARACTERISTICS:

Contact Rating50mA @ 12 V DC
 Initial Contact Resistance100MilliOhms Max
 Insulation Resistance100Megaohms @ 100VDC Min.
 Dielectric Strength500 VAC
 Actuation Travel0.014 +/-0.008 (.35 +/- .20)
 LifeUp to 1,000,000 Cycles

ENVIRONMENTAL SPECIFICATIONS:

Operating Temperature-4 to +185°F (-20 to +85°C)
 Storage Temperature-4 to +185°F (-20 to +85°C)
 Resistance to solder heatPer EIA-364-56, Procedure 3, Test Cond.B
 SolderabilityPer EIA RS-186-9E
 SealPer IP67

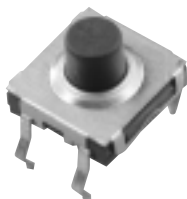
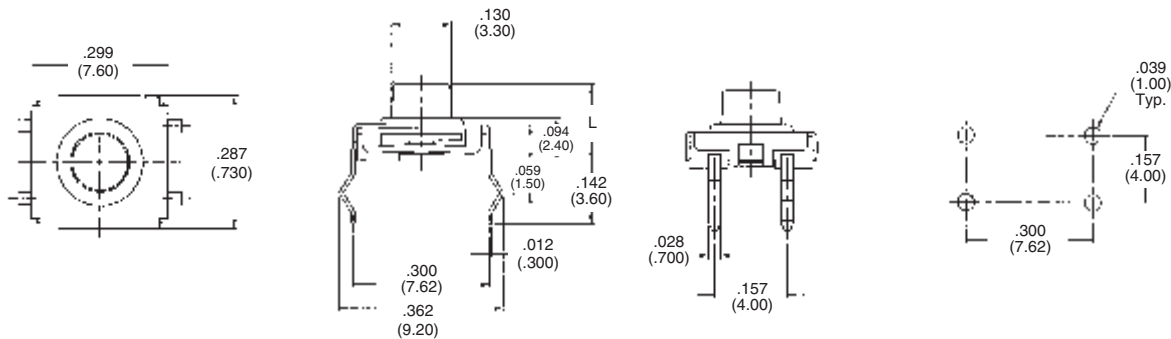

| Tyco Electronics | Packaging | L | Force |
|------------------|-----------|-------------|----------|
| 1571295-1 | Bulk | .169 (4.30) | 160±50gf |
| 1571295-2 | Bulk | .197 (5.00) | 160±50gf |

E

Sealed Tactile Switches

Tactile Switches, Sealed .185 [4.7] x .268 [6.8], Surface Mount

MATERIAL SPECIFICATIONS:

CaseThermoplastic, UL94V-0, Black
 Stem/ActuatorThermoplastic, UL94V-0, Black
 CoverStainless Steel
 SealSilicone Rubber, Black
 Contact.....Stainless Steel, Plating—Silver
 TerminalCopper Alloy, Plating—Silver/Nickel

TYPICAL PERFORMANCE CHARACTERISTICS:

Contact Rating50mA @ 12 V DC
 Initial Contact Resistance100MilliOhms Max
 Insulation Resistance100Megaohms @ 100VDC Min.
 Dielectric Strength500 VAC
 Actuation Travel.....0.014 +/-0.008 (.35 +/- .20)
 LifeUp to 50,000 Cycles

ENVIRONMENTAL SPECIFICATIONS:

Operating Temperature-4 to +185°F (-20 to +85°C)
 Storage Temperature-4 to +185°F (-20 to +85°C)
 Resistance to solder heatPer EIA-364-56, Procedure 4 & 5, Level 3
 SolderabilityPer EIA RS-186-9E
 SealPer IP67

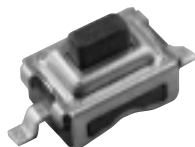
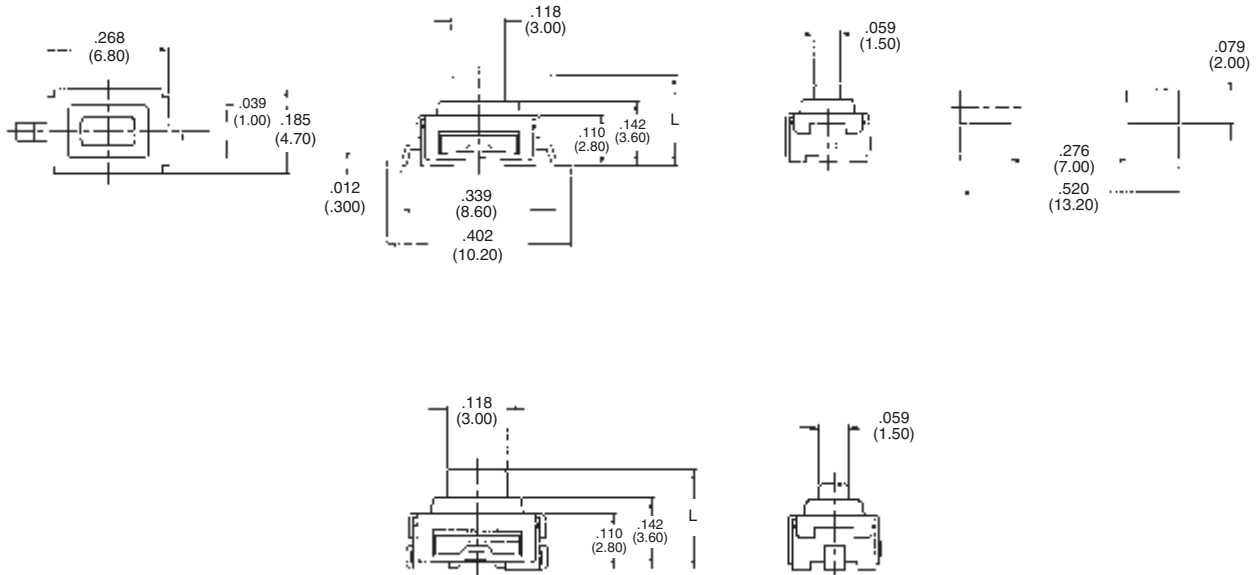

| Tyco Electronics | Packaging | L | Operating Force | Lead Style |
|------------------|-----------|-------------|-----------------|------------|
| 1571298-1 | Bulk | .197 (5.00) | 130 ± 50gf | Gull Wing |
| 1571298-2 | T&R | .197 (5.00) | 130 ± 50gf | Gull Wing |
| 1571299-1 | Bulk | .169 (4.30) | 130 ± 50gf | J Lead |
| 1571299-2 | T&R | .169 (4.30) | 130 ± 50gf | J Lead |
| 1571299-3 | Bulk | .197 (5.00) | 130 ± 50gf | J Lead |
| 1571299-4 | T&R | .197 (5.00) | 130 ± 50gf | J Lead |

E
Sealed Tactile Switches