

NUMBER C-174465



METRIC

DIMENSIONS IN MILLIMETERS. DO NOT SCALE PRINT

PRINT DIST

AMP-J  
REV.10/'83

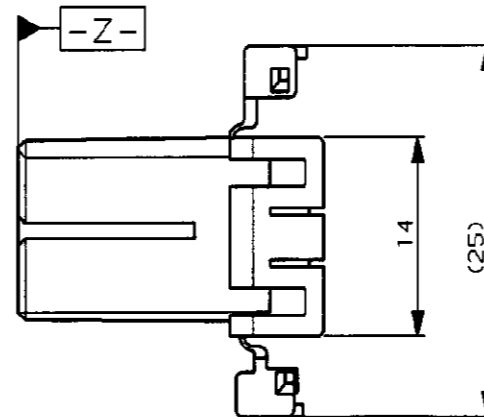
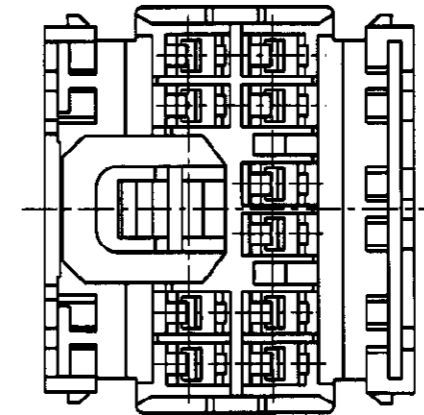
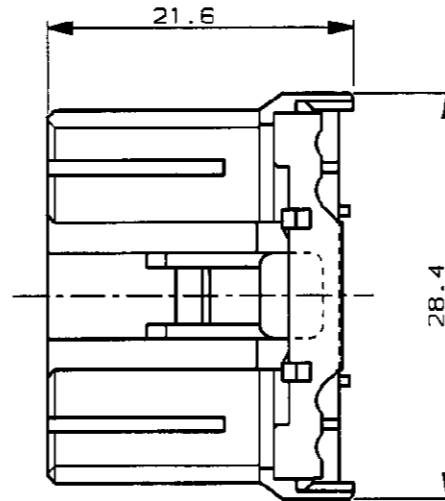
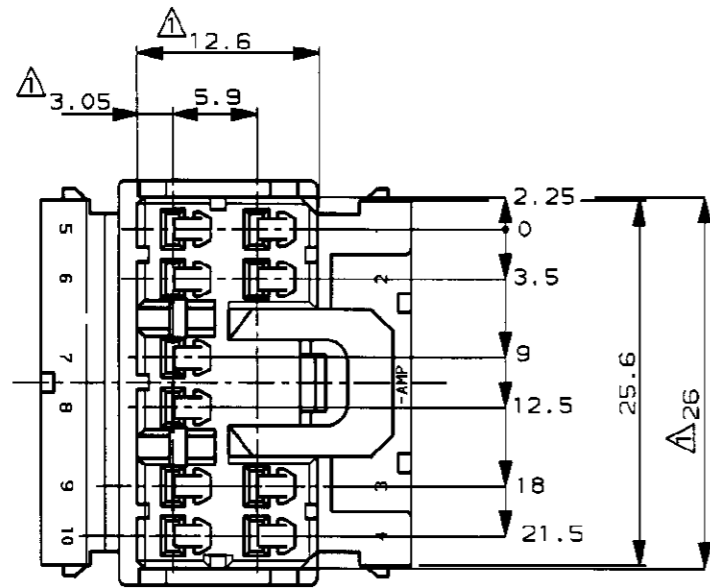

注 ;

- △ -Z- 面より2mmの範囲で測定。
- 2.内装するタブコンタクト型番173630,173631.
- 3.嵌合相手ハウジング型番174468

NOTE:

- △ MUST BE KEPT BETWEEN -A- AND 2.
- 2.APPLIED TAB CONTACT P/N; 173630,173631.
- 3.APPLIED PLUG HSG P/N; 174468

オレンジ (ORANGE)	174465-8
黄 (YELLOW)	174465-7
灰 (GRAY)	174465-6
青 (BLUE)	174465-5
緑 (GREEN)	174465-4
黒 (BLACK)	174465-2
白 (WHITE)	174465-1
色 (COLOR)	型番 (PART NUMBER)

OBSOLETE

				Copyright ©1989年 AMP (Japan) LTD. ALL RIGHTS RESERVED.		Copyright ©1989 AMP (Japan) LTD. ALL RIGHTS RESERVED.		<b>AMP</b> Tyco Electronics AMP K.K.	
				WIRE RANGE mm <sup>2</sup> (AWG)	INSULATION DIA mm		NAME .070シリーズ マルチロック I/Oコネクタ 10極 プラグハウジング .070SERIES MULTILOCK I/O CONNECTOR, 10Pos. PLUG HOUSING		
D1	OBSOLETE -4	FJ00-0279-99	AY	KB	29FEB '00	MATERIAL PBT	FINISH ---	GENERAL TOLERANCE	
D	CHANGE LETTER HEIGHT	FJ00-0599-98	KS	SI	27MAR '98	DR. <i>H. Motomura</i> 6/29'94		DE. <i>H. Motomura</i> 6/29'94	
C	再作成 & 色追加	FJ00-0854-94	HK	KA	6/30 '94	CHK. <i>K. B. ...</i> 6/30'94		APP. <i>S. Ogama</i> 6/30'94	
LTR	REVISION RECORD	DR	CHK	DATE	CHK.	APP.		SCALE 2-1	REV. D1
								LOC B J	NUMBER C-174465
								SHEET 2-1	SHEET #

(CUSTOMER DRAWING) 参 考 図 面