

- 技术指标:
1. 塑件表面应光洁、无毛边、无明显收缩、缺陷、裂纹等现象。
  2. 温度范围: -25° C~85° C.
  3. 额定电压: 50V, AC/DC.
  4. 接触电阻: ≤0.02Ω.
  5. 绝缘电阻: ≥100MΩ.
  6. 额定电流:
- 适用电线型号: a. AWG#28: 1.0A(per pin)  
 b. AWG#30: 1.0A(per pin)  
 c. AWG#32: 0.8A(per pin)

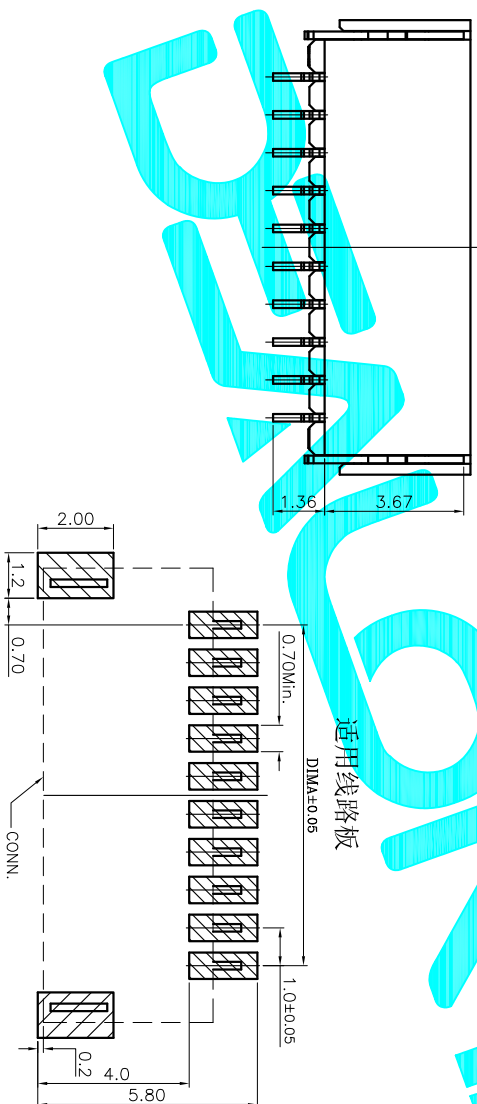
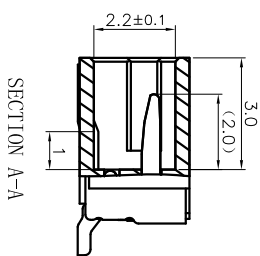
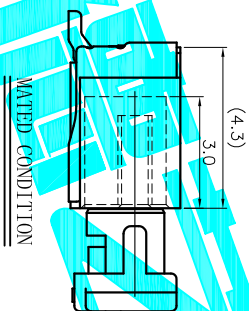
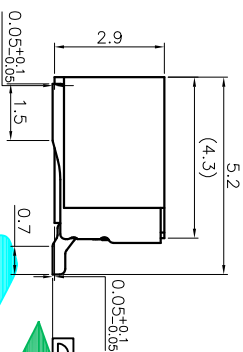
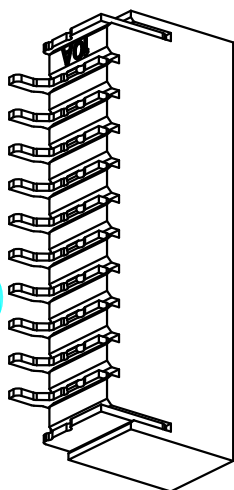

CKT	DIM A	DIM B	DIM C
2	1.00	2.50	4.00
3	2.00	3.50	5.00
4	3.00	4.50	6.00
5	4.00	5.50	7.00
6	5.00	6.50	8.00
7	6.00	7.50	9.00
8	7.00	8.50	10.00
9	8.00	9.50	11.00
10	9.00	10.50	12.00
11	10.00	11.50	13.00
12	11.00	12.50	14.00
13	12.00	13.50	15.00
14	13.00	14.50	16.00
15	14.00	15.50	17.00
16	15.00	16.50	18.00
17	16.00	17.50	19.00
18	17.00	18.50	20.00
19	18.00	19.50	21.00
20	19.00	20.50	22.00
22	21.00	22.50	24.00
24	23.00	24.50	26.00
26	25.00	26.50	28.00

APPROVALS		DATE		TITLE:	
DRAWN	G.M.Chen	2015/7/17		1.0 Pitch 卧式	
CHECKED				ELECTRONICS CO.,LTD	
APPROVALS				PART NO. 1.0-XXPWB	

ECN NO.	REV.	DATE.	DESCRIPTION.	CHANGE.	CHECK.	APPRO.	TOLEANCES ARE	ANGLE	UNIT:	SCALE:	SHEET	PROJ.
	A		NEW				30 <sup>max</sup> ±0.1	±2°	mm	1:1	1 OF 1	
							10 <sup>max</sup> ±0.10					
							5 <sup>max</sup> ±0.13					
							±0.10					