

REV.	DATE	DESCRIPTION
A	06/05/03	UPDATE DRAWING FORMAT

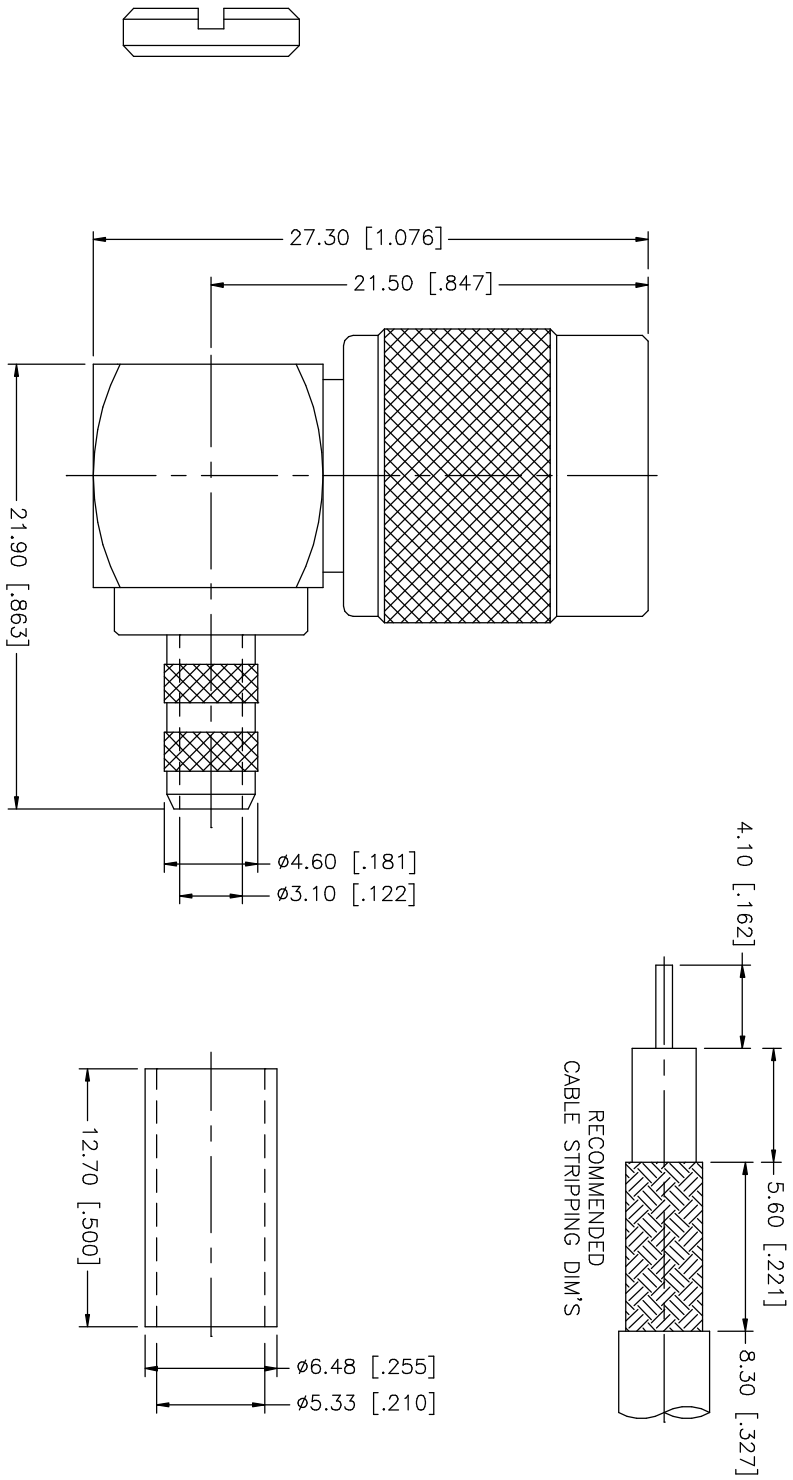

REV.	DATE	DESCRIPTION	MATERIAL	FINISH	QTY
8					
7					
6					
5			BRASS	NICKEL	1
4			COPPER	NICKEL	1
3			BRASS	GOLD	1
2			DELRIIN	NATURAL	1
1			BRASS	NICKEL	1
<p>UNLESS OTHERWISE SPECIFIED DIMENSIONS ARE IN INCHES AND FOR CUSTOMER REFERENCE ONLY.</p> <p>UNLESS OTHERWISE SPECIFIED TOLERANCES FOR MILLIMETERS ARE:</p> <p>0.5 - 8mm ± 0.20mm 8 - 30mm ± 0.40mm 30 - 120mm ± 0.50mm</p> <p>UNLESS OTHERWISE SPECIFIED TOLERANCES FOR INCHES ARE:</p> <p>.020 - .315 = ± 0.007" .315 - 1.180 = ± 0.015" 1.180 - 4.724 = ± 0.020"</p> <p>DO NOT SCALE DRAWING</p>					
APPROVALS		DATE			
DRAWN		G.R.S.	06/05/03		
CHECKED					
ISSUED					
SHEET		1 OF 1			
CAD FILE		C:/122/122140.DWG			
PART DESCRIPTION		<p>Amphenol Connex</p> <p>TNC R/A CRIMP PLUG (FOR RG-58/u, 58C/u, 141/u CABLE)</p>			
PART NO.		122140			
DMG. NO.		122140.DWG			
REV.	A	SIZE	A		
SCALE		NA			