

PRODUCT NO	DIM L	PLATING	RECOMMENDED P.C. BOARD THICKNESS	PRODUCT NO	PLATING
10022676-00ILF	2.70	NOTE 2	1.57mm (0.062") / 2.36mm (0.093")	10022676-001	NOTE 5
10022676-01ILF	3.70			10022676-011	

HOLE	A	REMARK
Hole Diameter after plating	0.45 - 0.55 mm	FOR -XXX & -XXXLF
Drilled hole	0.58 - 0.62 mm	
Copper plating	25 - 50 μ m	
Sn Plating	5 - 15 μ m	FOR -XXXLF ONLY
Sn-Pd Plating	5 - 15 μ m	FOR -XXX ONLY

A

B

C

D

A

B

C

D

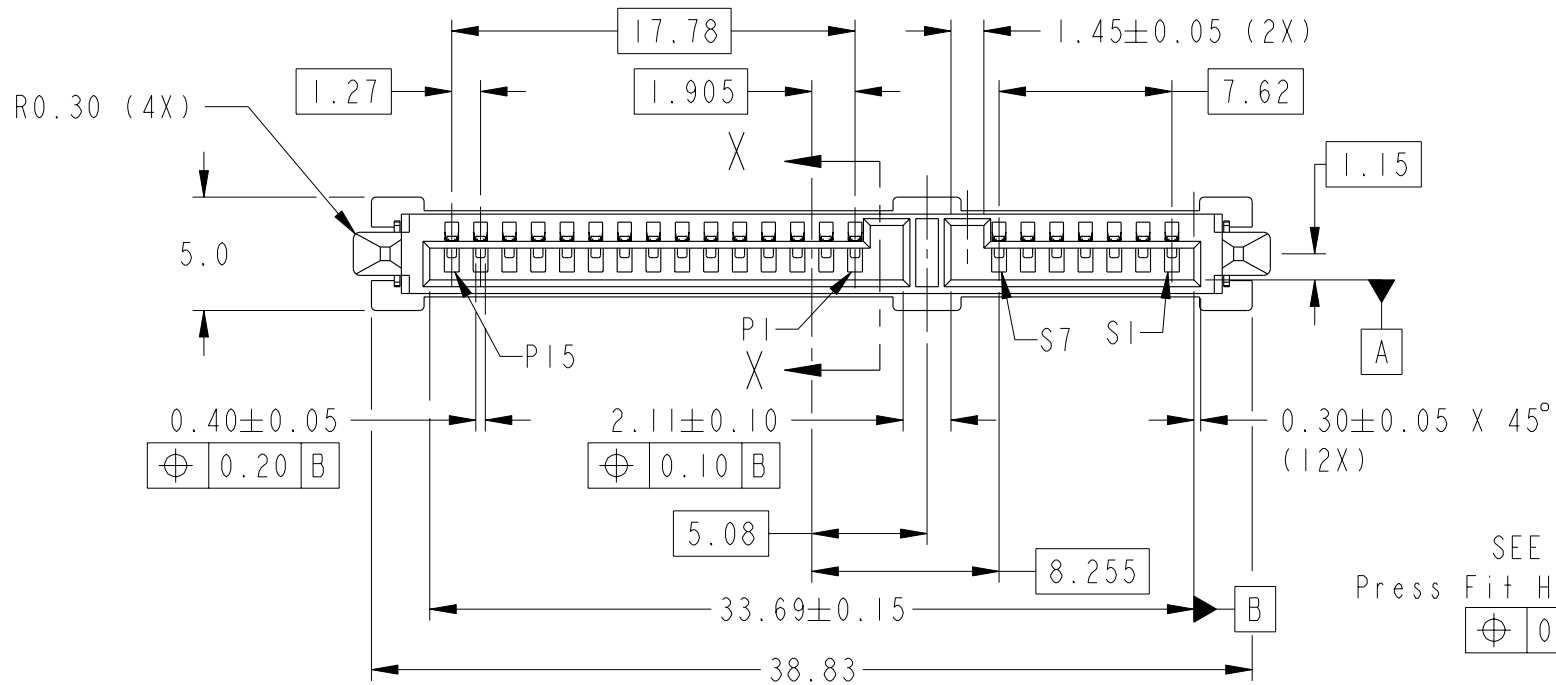

SEE TABLE
Press Fit Holes "A" (22X)
 \varnothing 0.05 D

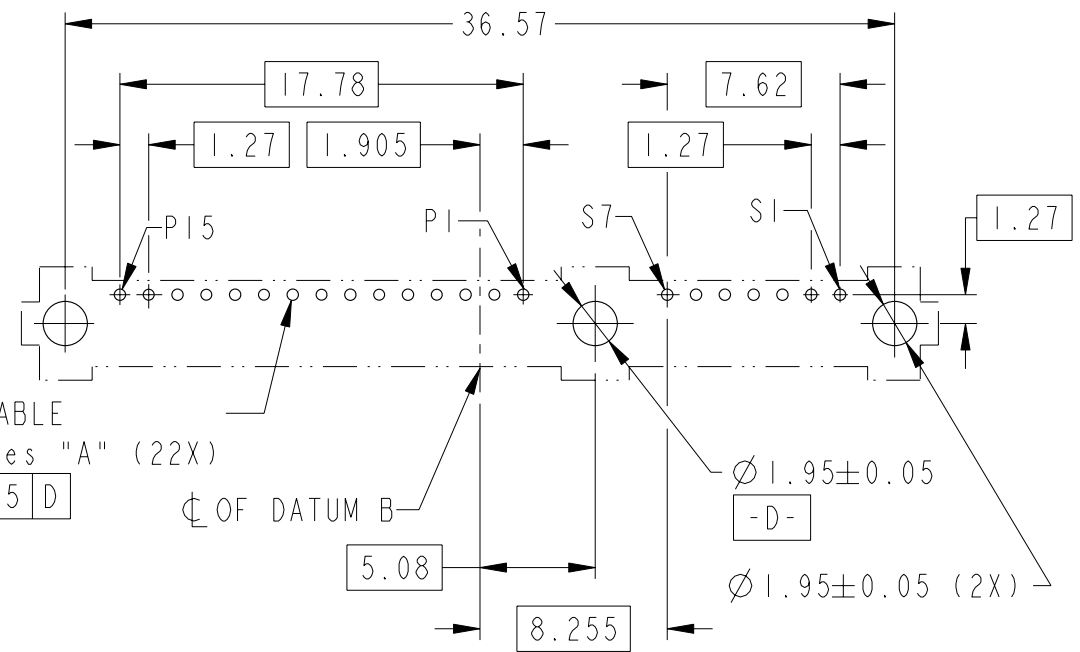

RECOMMENDED P.C.B. LAYOUT

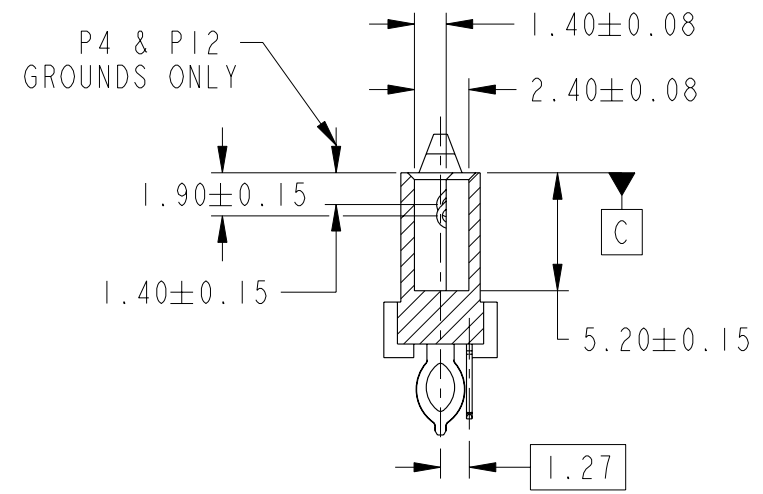

SECTION X-X

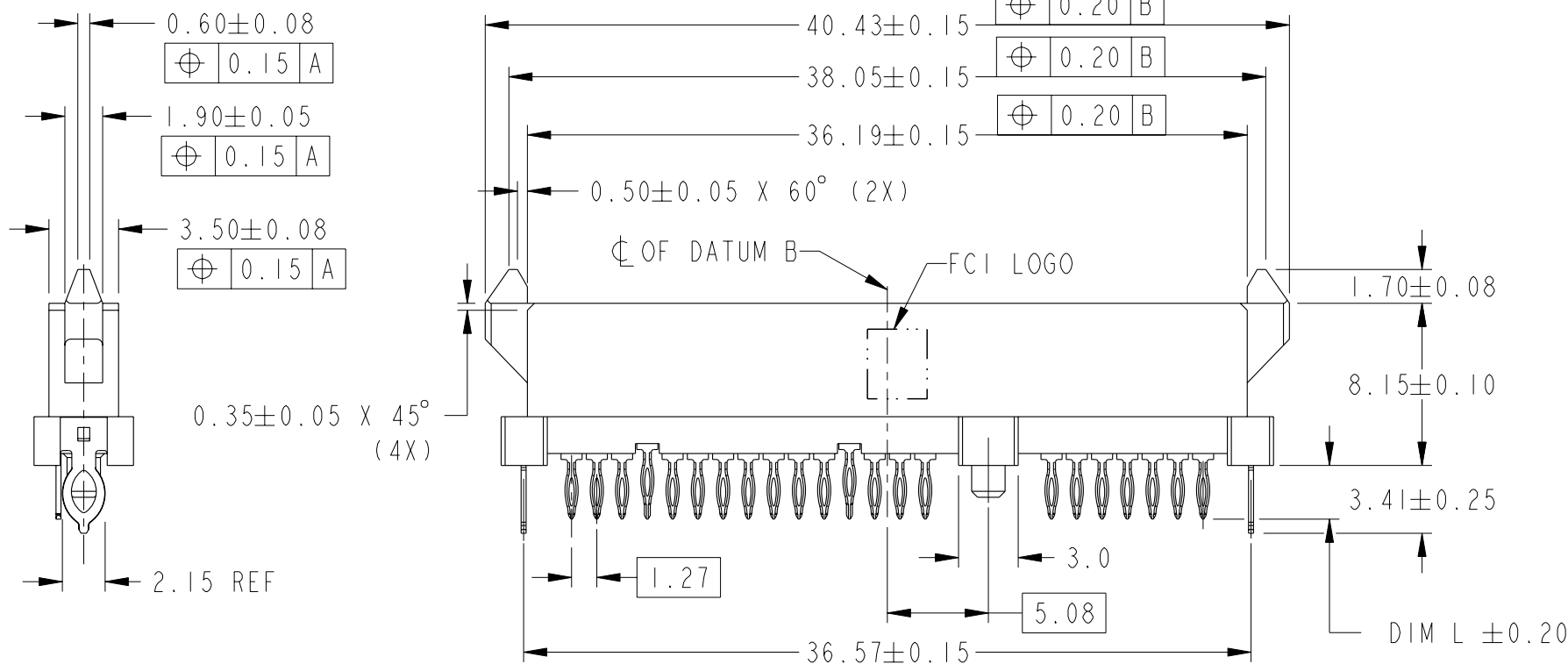

spec ref	-	dr	GL LOO	2004-10-05	projection	MM	size	A3	scale	3:1	
tolerance std	ISO 406 ISO 1101	eng	GL LOO	2004-10-05		← →	ecn no	S10-0228	rel level	-	
TOLERANCES UNLESS OTHERWISE SPECIFIED		chr	GL LOO	2010-10-28							product family
surface	ISO 1302	appr	JOEY NG	2010-10-28	S-ATA COMB RECEP. VERTICAL PF TYPE ASSY		rel level	-	dwg no	10022676	
					www.fci.com	cat. no.	-	Product - Customer Drw	sheet 1 of 2	rev	F

PRODUCT NO	DIM L	PLATING	RECOMMENDED P.C. BOARD THICKNESS	PRODUCT NO	PLATING
10022676-002LF	2.70	NOTE 2	1.57mm (0.062") / 2.36mm (0.093")	10022676-002	NOTE 5
10022676-012LF	3.70		2.36mm (0.093")	10022676-012	

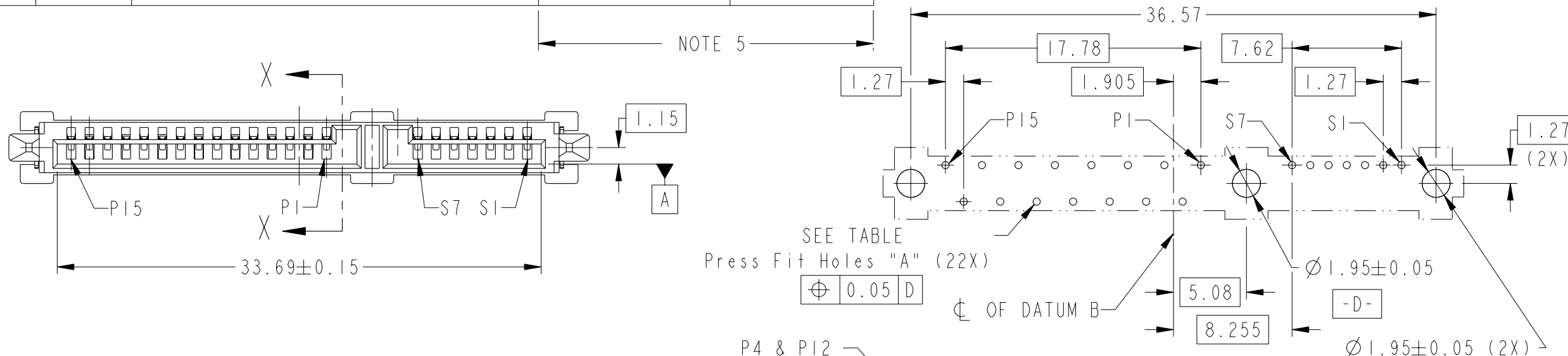

SEE TABLE
Press Fit Holes "A" (22X)

RECOMMENDED P.C.B. LAYOUT

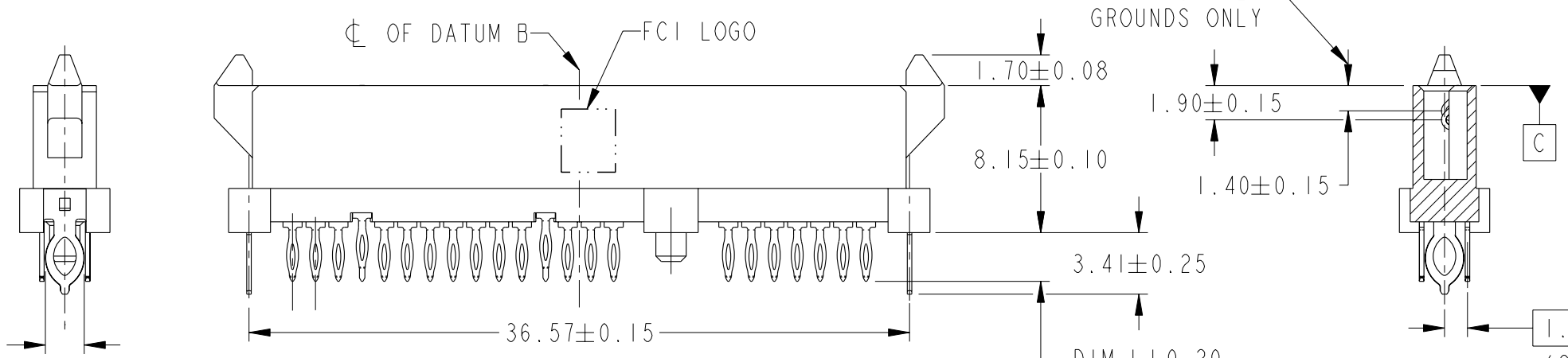

NOTES :
ALL OTHER DIMENSIONS REFER TO SHEET 1.

- NOTES:
- MATERIAL:
 - HOUSING : HIGH TEMP, THERMOPLASTIC, UL 94V-0
COLOR : BLACK
 - TERMINAL : COPPER ALLOY
 - HOLD DOWN : COPPER ALLOY
 - FINISH : FOR XXXXXXXX-XXXLF
 - TERMINAL : 30μ" Au PLATING (CONTACT POINT) OVER 50μ" MIN NICKEL
 - SOLDER TAIL : 20μ" MIN-60μ" MAX TIN OVER 50μ" MIN NICKEL
 - HOLD DOWN : 50μ" MIN TIN OVER 50μ" MIN NICKEL
 - TRUE POSITION NOTES APPLY AT (L= 2.70MM) TERMINAL TIP
 - PER S-ATA SPEC REV 1.0a
 - FINISH : FOR XXXXXXXX-XXX
 - TERMINAL : 30μ" Au PLATING (CONTACT POINT) OVER 50μ" MIN NICKEL
 - SOLDER TAIL : 20μ" MIN-60μ" MAX TIN-LEAD OVER 50μ" MIN NICKEL
 - HOLD DOWN : 50μ" MIN TIN-LEAD OVER 50μ" MIN NICKEL

- THE HOUSING WILL WITHSTAND EXPOSURE TO 260°C PEAK TEMPERATURE FOR 10 SECONDS IN CONVECTION, INFRA-RED OR VAPOR PHASE REFFLOW OVEN
- THIS PRODUCT MEETS EUROPEAN UNION DIRECTIVES AND OTHER COUNTRY REGULATIONS AS DESCRIBED IN GS-22-008
- PART NUMBERS ENDING IN "LF" MEANS FOR NOTE 7 LEAD FREE IDENTIFICATION
- A $\triangle F$ SYMBOL WILL BE NEXT TO ANY DIMENSION, VIEW, OR NOTE WHICH HAS BEEN MODIFIED WITH THE CURRENT DRAWING REVISION.
- THE STD PACKAGING IS IN TRAY.
- NOTE 7 AND 8 DO NOT APPLY TO TIN LEAD PLATING P/N XXXXXXXX-XXX IN TABLE.

spec ref	-	dr	GL LOO	2004-10-05	projection	MM	size	A3	scale	3:1											
tolerance std	ISO 406 ISO 1101	eng	GL LOO	2004-10-05			ecn no	S10-0228	rel level	-											
TOLERANCES UNLESS OTHERWISE SPECIFIED		chr	GL LOO	2010-10-28							product family	S-ATA									
surface	<table border="1"> <tr> <td>linear</td> <td>0.X</td> <td>±-</td> </tr> <tr> <td></td> <td>0.XX</td> <td>±0.20</td> </tr> <tr> <td></td> <td>0.XXX</td> <td>±-</td> </tr> <tr> <td>angular</td> <td>0°</td> <td>±2°</td> </tr> </table>	linear	0.X	±-		0.XX	±0.20		0.XXX	±-	angular	0°	±2°	appr	JOEY NG	2010-10-28	www.fci.com	cat. no.	-	Product - Customer Drw	sheet 2 of 2
linear	0.X	±-																			
	0.XX	±0.20																			
	0.XXX	±-																			
angular	0°	±2°																			
S-ATA COMB RECEP. VERTICAL PF TYPE ASSY						dwg no	10022676	rev	F												

Copyright FCI.