

USB and IEEE 1394 connectors



USB 2.0 chassis plug type A, angular version, for printed circuit boards

24

2410 08

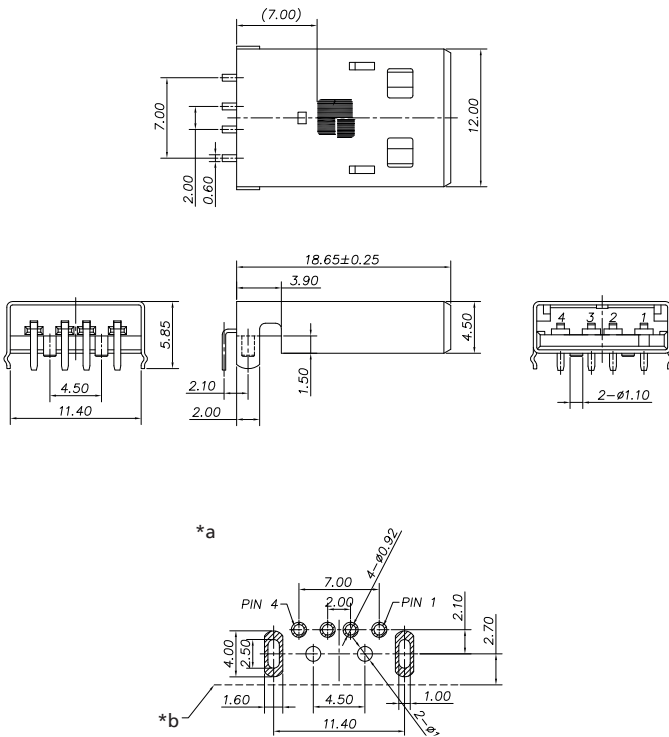

\*a printed circuit board layout, components side view  
\*b printed circuit board edge

**Environmental conditions**

Temperature range -55 °C/+105 °C

**Materials**

Insulating body PBT GF, V-0 according to UL94  
Contact spring Cu alloy, pre-nickel and gold-plated, tin-plated in solder area  
Housing steel, tin-plated

**Mechanical data**

Mating cycles 1500  
Insertion force ≤ 35 N  
Withdrawal force ≥ 18,6 N

**Electrical data (at T<sub>amb</sub> 20 °C)**

Contact resistance ≤ 30 mΩ  
Rated current 1 A  
Rated voltage 30 V AC  
Rated impulse voltage 500 V/60 s  
Insulation resistance ≥ 500 MΩ

**Associated products**

Counterparts  
 ☞ 2410 05      ☞ 2410 09      ☞ 2410 11  
 ☞ 2410 12      ☞ 2410 13      ☞ 2410 14  
 ☞ 2420 01      ☞ 2483 01      ☞ 4512

24

2410 08

Designation	Pole Number	PU (Pieces)	MDQ (Pieces)
2410 08	4	100	500

**Packaging:**  
in a tray