

Installation MS

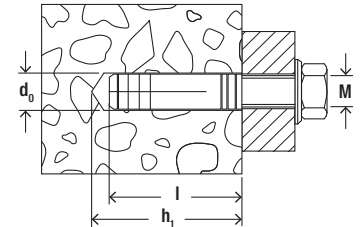
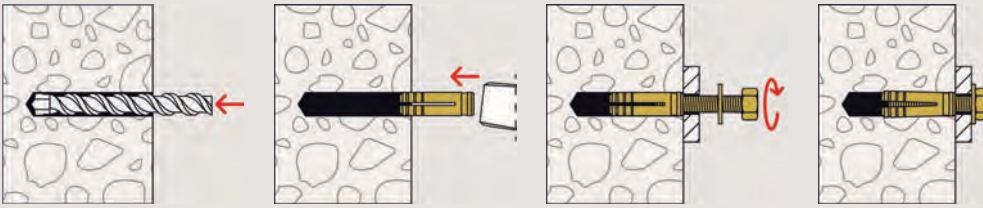

6

Technical data

Brass fixing MS



MS for metric screws

Item	Item No.	Drill hole diameter d_0 [mm]	Min. drill hole depth h_1 [mm]	Anchor length l [mm]	Thread $\emptyset \times$ length [mm]	Min. bolt penetration $l_{E,min}$ [mm]	Sales unit [pcs]
MS 4 x 15	026424	5	20	15	M 4	15	100
MS 5 x 18	026425	6	25	18	M 5	18	100
MS 6 x 22	078660	8	27	22	M 6	22	100
MS 8 x 28	078981	10	35	28	M 8	28	50
MS 10 x 32	078661	12	39	32	M 10	32	25
MS 12 x 37	078662	15	46	37	M 12	37	10
MS 16 x 43	078663	20	50	43	M 16	43	10

Loads

Brass fixing MS

 Highest recommended loads¹⁾ for a single anchor.

The given loads are valid for metric screws with the specified thread size.

Type		MS 4 x 15	MS 5 x 18	MS 6 x 22	MS 8 x 28	MS 10 x 32	MS 12 x 37	MS 16 x 43	
Thread size		M 4	M 5	M 6	M 8	M 10	M 12	M 16	
Recommended loads in the respective base material F_{rec} ²⁾									
Concrete	\geq C20/25	[kN]	0.25	0.40	0.65	1.10	1.60	2.20	3.30
Solid brick	\geq Mz 12	[kN]	0.20	0.35	0.55	0.90	1.30	1.60	2.30

¹⁾ Required safety factors are considered.

²⁾ Valid for tensile load, shear load and oblique load under any angle.