

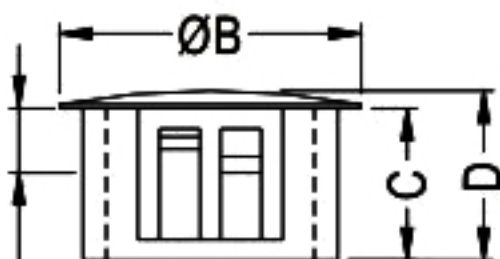

M08

- ◆ MATERIAL: NYLON 66(UL)
- ◆ FLAME CLASS: 94V-2
- ◆ COLOR: BLACK/WHITE
- ◆ UNIT: mm

PART NO	A	B	C	D	THICKNESS	PACKAGE
FIX-M08	8.0	9.5	6.4	7.6	1.6	1000
FIX-M09A	9.0	11.5	8.6	10.1	3.3	
FIX-M09	9.5	11.9	8.6	10.1	3.3	
FIX-M11	11.0	14.0	9.0	10.1	3.3	500
FIX-M12	12.0	14.3	9.0	10.1	3.3	
FIX-M13	12.7	14.6	9.0	10.1	3.3	
FIX-M16	16.0	18.7	9.3	10.6	3.3	
FIX-M19	19.0	23.2	8.7	10.3	3.3	
FIX-M22	22.2	25.4	9.9	11.0	3.3	200
FIX-M25	25.4	28.4	9.6	11.0	3.3	
FIX-M28	28.0	32.0	12.0	13.1	3.3	
FIX-M30	30.0	34.2	10.0	11.3	3.3	

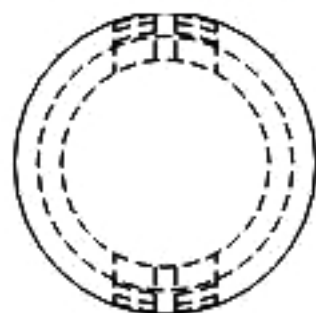

CHASSIS ØA
THICKNESS MAX