

Tact Switch

Q-1457

TYPE: **TS-2201**

SPECIFICATIONS

Contact Type	SPST
Rating	DC 12V, 50mA
Travel	0,5±0,10mm
Contacts Resistance	100mΩ Max
Insulation Resistance	100MΩ Min
Minimum Load	DC 100V
Dielectric Strengths	AC 250V / 1 minute
Life Test	100 000 Cycles Min
Operating temperature range	-30°C to +85°C
Operating Force	130 ± 50gf

Outline Drawing

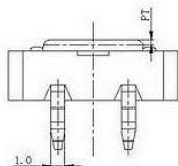
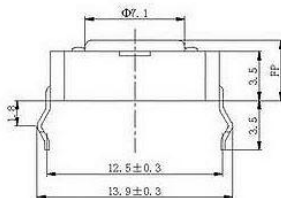
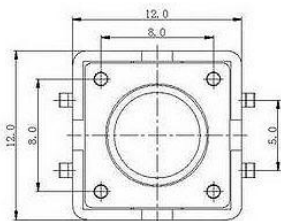

Mounting

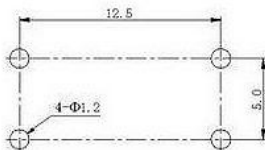

PP=4.3; 5.0; 6.0; 8.0; 9.0; 18.0mm
Circuitry

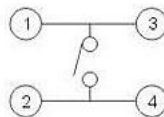

OFF – (ON)

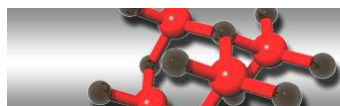

Сеть магазинов
КВАРЦ
Радиодетали и электронные компоненты

107023, Москва, ул. Буженинова, д. 16
 телефон: (495) 963-6120
 факс: (495) 963-4994
 e-mail: quartz1@quartz1.ru

111123, Москва, шоссе Энтузиастов, д31
 телефон/факс: (495) 788-8899 многоканальный
 e-mail: mqz@quartz1.ru