

MPS-MT - Test plugs



0201744

<https://www.phoenixcontact.com/us/products/0201744>

Please be informed that the data shown in this PDF document is generated from our Online Catalog. Please find the complete data in the user documentation. Our General Terms of Use for Downloads are valid.



Test plugs, with solder connection up to 1 mm² conductor cross section, number of positions: 1, color: gray

Your advantages

- The test plug reliably makes contact in the bridge shaft and in all test sockets with a 2.3 mm diameter
- Two-piece test plug for individual plug color combinations
- The test plugs are inserted in the function shaft of terminal blocks from the CLIPLINE complete system or in the test connections provided

Commercial Data

Item number	0201744
Packing unit	1 pc
Minimum order quantity	10 pc
Sales Key	BE19
Product Key	BE1Z3X
Catalog Page	Page 38 (C-1-2019)
GTIN	4017918098803
Weight per Piece (including packing)	1.41 g
Weight per Piece (excluding packing)	1.3 g
Customs tariff number	85366990
Country of origin	DE

MPS-MT - Test plugs

0201744

<https://www.phoenixcontact.com/us/products/0201744>



Technical Data

Product properties

Product type	Test plug terminal block
Number of positions	1
Pitch	5 mm

Dimensions

Width	5 mm
Length	5 mm
Length contact range	10.85 mm
Pin diameter	2.3 mm
Pitch	5 mm
Note on dimensions	Length without insulating sleeve

Material specifications

Color	gray
-------	------

MPS-MT - Test plugs

0201744

<https://www.phoenixcontact.com/us/products/0201744>



Classifications

ECLASS

ECLASS-11.0	27440313
ECLASS-12.0	27440313
ECLASS-13.0	27440313

ETIM

ETIM 8.0	EC002255
----------	----------

UNSPSC

UNSPSC 21.0	20122000
-------------	----------

MPS-MT - Test plugs



0201744
<https://www.phoenixcontact.com/us/products/0201744>

Environmental Product Compliance

REACH SVHC	Lead 7439-92-1
China RoHS	Environmentally Friendly Use Period = 50 years
	For information on hazardous substances, refer to the manufacturer's declaration available under "Downloads"

MPS-MT - Test plugs

0201744

<https://www.phoenixcontact.com/us/products/0201744>



Accessories

MPS-IH WH - Insulating sleeve

0201663

<https://www.phoenixcontact.com/us/products/0201663>

Insulating sleeve, color: white



MPS-IH RD - Insulating sleeve

0201676

<https://www.phoenixcontact.com/us/products/0201676>

Insulating sleeve, color: red



MPS-MT - Test plugs

0201744

<https://www.phoenixcontact.com/us/products/0201744>



MPS-IH BU - Insulating sleeve

0201689

<https://www.phoenixcontact.com/us/products/0201689>

Insulating sleeve, color: blue

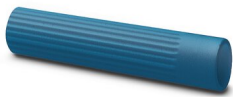

MPS-IH YE - Insulating sleeve

0201692

<https://www.phoenixcontact.com/us/products/0201692>

Insulating sleeve, color: yellow



MPS-MT - Test plugs

0201744

<https://www.phoenixcontact.com/us/products/0201744>



MPS-IH GN - Insulating sleeve

0201702

<https://www.phoenixcontact.com/us/products/0201702>

Insulating sleeve, color: green



MPS-IH GY - Insulating sleeve

0201728

<https://www.phoenixcontact.com/us/products/0201728>

Insulating sleeve, color: gray



MPS-MT - Test plugs

0201744

<https://www.phoenixcontact.com/us/products/0201744>



MPS-IH BK - Insulating sleeve

0201731

<https://www.phoenixcontact.com/us/products/0201731>

Insulating sleeve, color: black



Phoenix Contact 2023 © - all rights reserved

<https://www.phoenixcontact.com>

Phoenix Contact USA
586 Fulling Mill Road
Middletown, PA 17057, United States
(+717) 944-1300
info@phoenixcon.com