

6

5

4

3

2

1

APPROVED: _____

DATE: _____

TITLE: _____

Rev	AWO #	Description	Date	Appr
-		RELEASED	3/19/07	
A		REDRAWN	11/18/13	KW/TW
B		REDRAWN	2/10/15	HR/NP
C		REVISED SPEC.	7/15/15	HR/YC

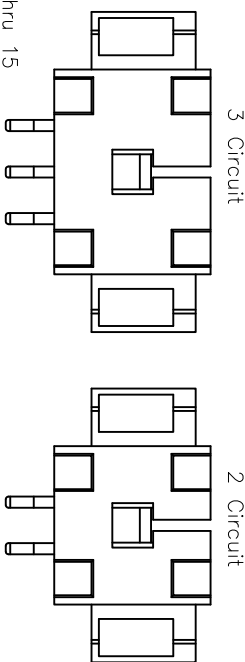
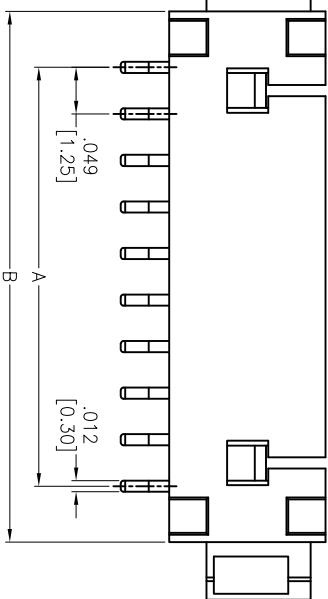
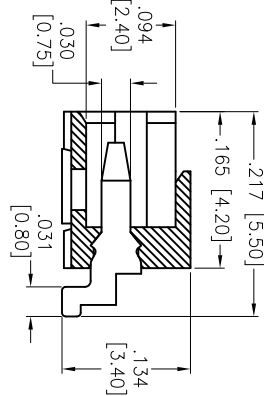
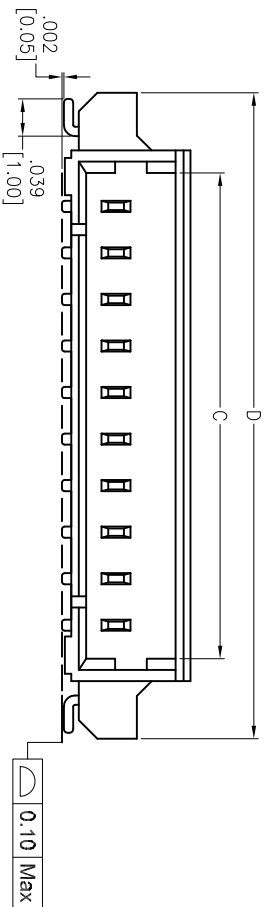
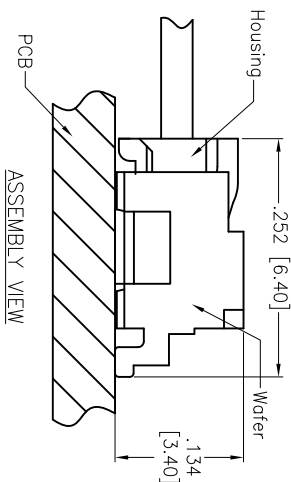
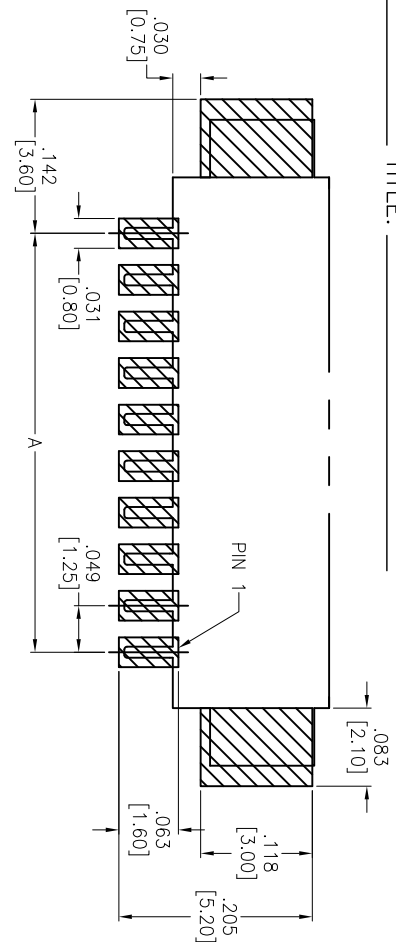

Positions: 02 thru 15

- A = .049 [1.25] x No. of Spaces
- B = .049 [1.25] x No. of Spaces + .118 [3.00]
- C = .049 [1.25] x No. of Spaces + .071 [1.80]
- D = .049 [1.25] x No. of Spaces + .230 [5.85]

SPECIFICATIONS:
 Material: Insulator: Hi-Temp Thermoplastic, rated UL 94V-0
 Insulator color: Natural
 Contacts: Brass
 Solder nail: Brass
Plating: Tin over Nickel underplate overall
Electrical: Current rating: 1 A AC/DC
 Contact resistance: 20 mohms max
 Insulation resistance: 100 Mohms min
 Dielectric withstanding voltage: 250 VAC for 1 minute
Temperature Rating: -40°C to +85°C
 Environmental: Lead free, RoHS compliant.

A

B

C

D

A

B

C

D

ADAM TECH INTERCONNECTS
 909 Rahway Avenue,
 Union, NJ 07083
 Phone: 908-687-5000
 Fax: 908-687-5710

MX 1.25mm WAFER 90° SMT

UNLESS OTHERWISE SPECIFIED ALL DIMENSIONS ARE INCHES [MM]	
TOLERANCES: EXCEPT AS NOTED	
INCHES	HOLDS
.X ± .10	ØX ± .10
.XX ± .020	ØXX ± .015
.XXX ± .015	ØXXX ± .010
APPROVALS	DATE
DRAWN	BW
CHECKED	
APPROVED	

SIZE	PART NO.	REV.
X	125SH-B-XX-TR-SMT	C
REF:	S0072AT	
SCALE:	NIS	
SHEET	1 OF 1	



6

5

4

3

2

1