

MICRO SWITCHFREEPORT ILLINOIS, U.S.A.
A DIVISION OF HONEYWELL

FED. MFG. CODE 91929

**MINIATURE PRECISION
LIMIT SWITCH**

CATALOG LISTING

914CEI-6A**M 914CEI-6A**DRAWING
NUMBER

ISSUE

REPLACES

RELEASE NO. PR - 16701

CHECK

CHECK

CHECK

CHECK

CHECK

REVISIONS

5178-1A

DRAWN

M 29 AUG 88

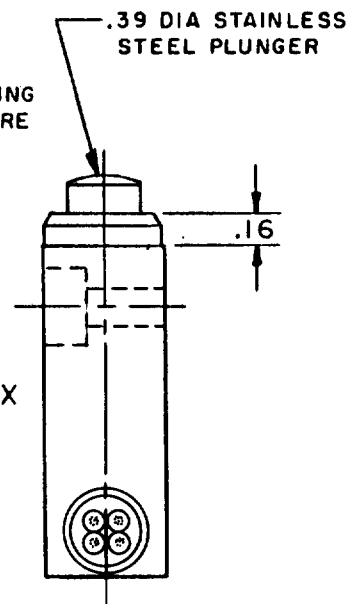
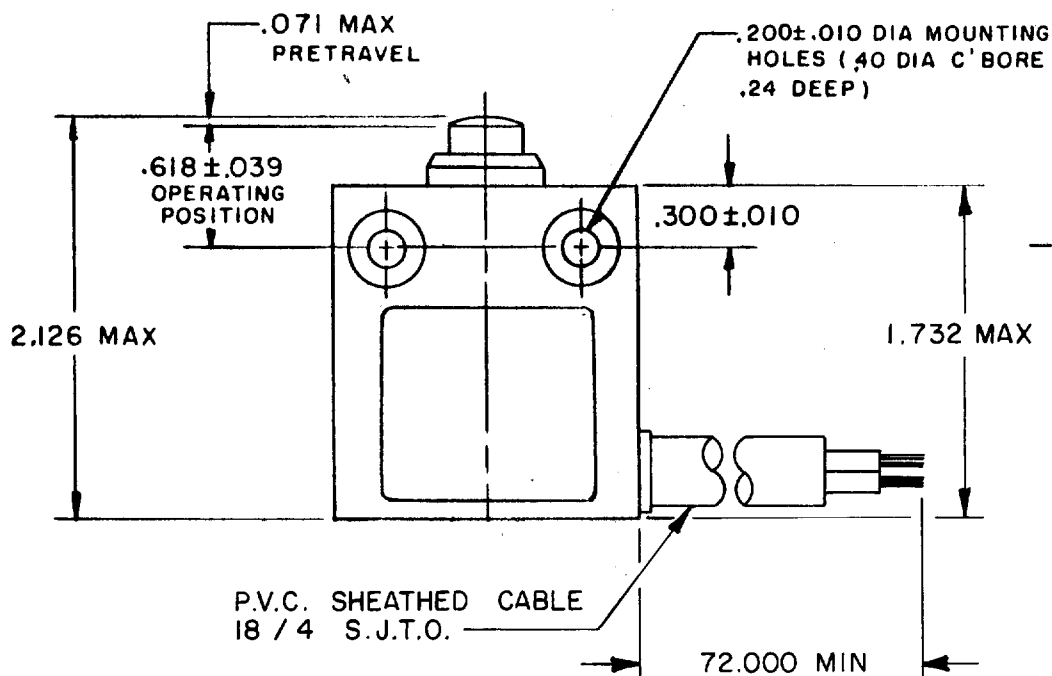
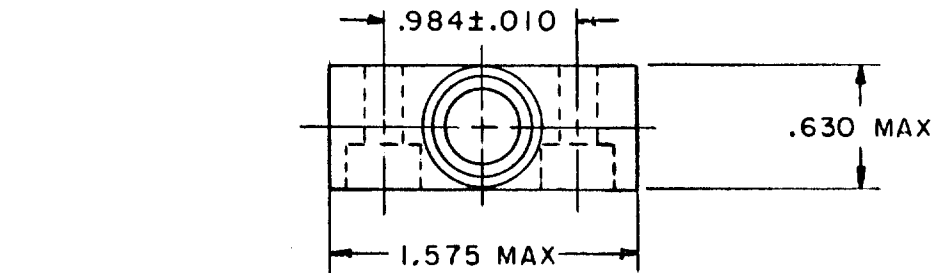
**NOTE**

- 1 - ZINC HOUSING FINISHED WITH GREY PAINT
- 2 - SIDE EXIT CABLE

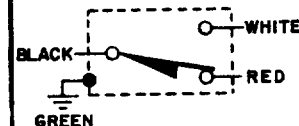
**CIRCUIT DIAGRAM**

THIS DRAWING COVERS A PROPRIETARY ITEM AND IS THE PROPERTY OF MICRO SWITCH, A DIVISION OF HONEYWELL. THIS DRAWING IS NOT TO BE COPIED OR USED WITHOUT THE APPROVAL OF MICRO SWITCH.

CHARACTERISTICS

OPERATING FORCE ——— 2.7 LB MAX
RELEASE FORCE ——— 1.0 LB MAX
DIFFERENTIAL TRAVEL ——— .004 MAX
OVERTRAVEL ——— .118 MIN

ELECTRICAL DATA

CONTACT ARRANGEMENT
SPDT

UL LISTED - HONEYWELL LTD.
FILE E 41859
5A-250 VAC
1/10HP-125 OR 250 VAC



LR-15775

SCALE FULL

DO NOT SCALE PRINT

UNLESS OTHERWISE
NOTED

DIMENSIONS ARE IN INCHES

TOLERANCES ARE:

ONE PLACE	(.0)	±.030
TWO PLACE	(.00)	±.015
THREE PLACE	(.000)	±.005
ANGLES		±

WEIGHT