

Subminiature Pushbutton Switches



Specifications:

| | |
|------------------------|--|
| Contact rating: | 30 V DC, 0,1 A |
| Contact resistance: | < 30 mΩ |
| Insulation resistance: | > 1000 MΩ at 500 V DC |
| Dielectric strength: | 500 V, 50 Hz for the duration of 1 minute |
| Temperature range: | - 30° to + 65° C |
| Mechanical life: | minimum 100 000 operations |
| Contacts: | brass, gold-plated |
| Terminals: | solder tags or PC terminals |
| Material: | case: PPS, button: PA |
| Mounting: | bushing M 4 x 0,70, key 5 mm or on pc-board |
| Soldering conditions: | hand-soldering – max.: 5 sec, 300° C auto-soldering – max.: 5 sec, 260° C |

3

Models: Switching functions

SPDT

MSP 112 BG

Travel 1,8

on – mom

MSP 112 CG

Travel 1,6

off – mom

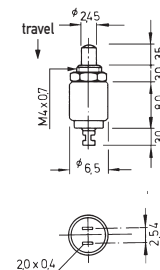

SPDT

MSP 112 CG – RA

off – mom

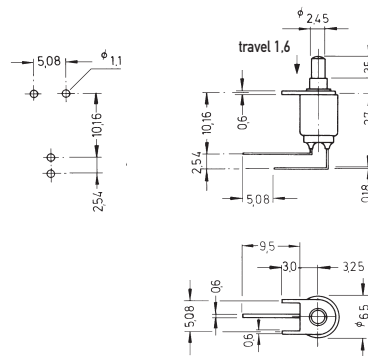

SPDT

MSP 112 CVG – RA

off – mom

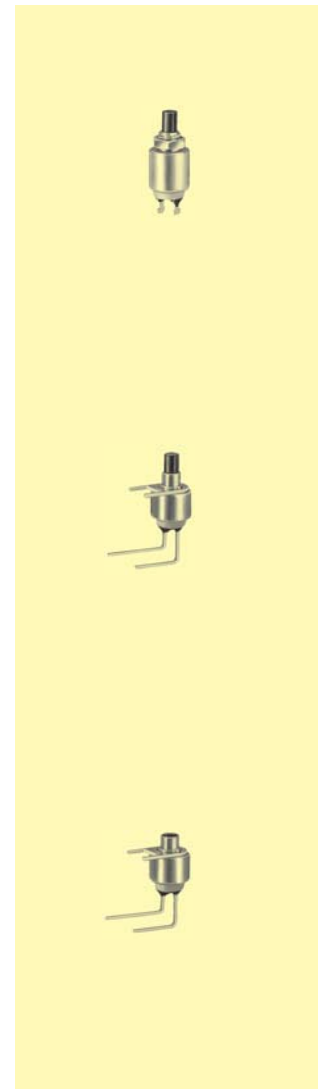
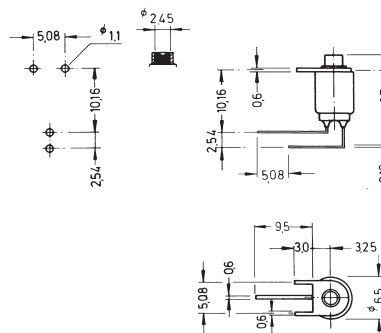



Subminiature Pushbutton Switches

Specifications:

| | |
|------------------------|---|
| Contact rating: | 30 V DC, 650 mA |
| Contact resistance: | < 20 mΩ |
| Insulation resistance: | > 500 MΩ at 500 V DC |
| Dielectric strength: | 500 V, 50 Hz for the duration of 1 minute |
| Mechanical life: | minimum 20 000 operations |
| Contacts: | brass, silver-plated |
| Terminals: | solder tags |
| Material: | phenolformaldehyde, black |
| Mounting: | single-hole |
| Soldering conditions: | hand-soldering – max.: 3 sec, 230° C ± 5° C |

Models:

Contact arrangement

MSP 101 C
button colour: red

normally open

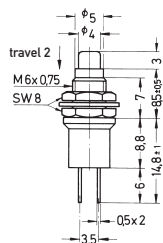
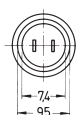

MSP 121 B
button colour: black
red

normally closed

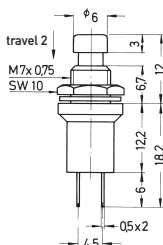
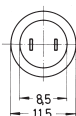

MSP 121 C
button colour: black
red

normally open

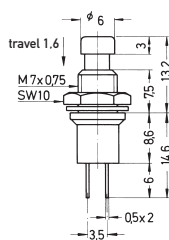
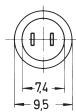

MSP 131 C
button colour: black

normally open

