

# Pushbutton round, IP65

## Equipment consisting of (schematic overview)



Front bezel set

Page 202



Lens

Page 199



Marking Plate

Page 201



Actuator

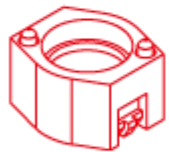

Bayonet flange

Page 203

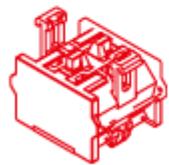

Switching element

Page 213

Each Part Number listed below includes all the black components shown in the 3D-drawing.

To obtain a complete unit, please select the red components from the pages shown.

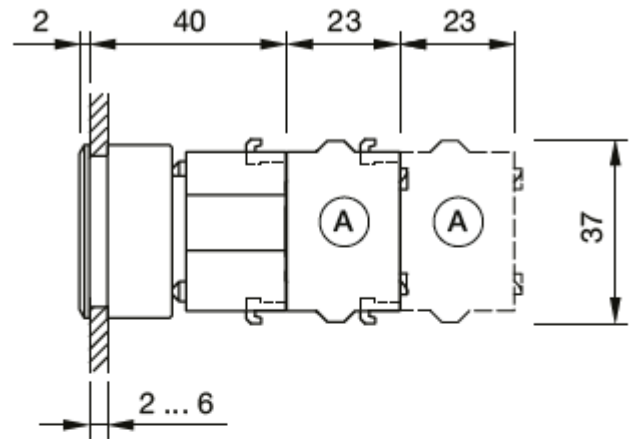

Dimensions [mm]

A = Screw terminal

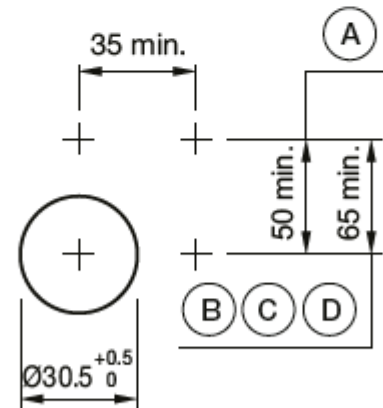

Mounting cut-outs [mm]

A = Screw terminal

B = Push-in terminal (PIT)

C = Plug-in terminal 6.3 mm x 0.8 mm

D = Double plug-in terminal 6.3 mm x 0.8 mm

