

**STRICTLY CONFIDENTIAL**

**SECTION A-A**

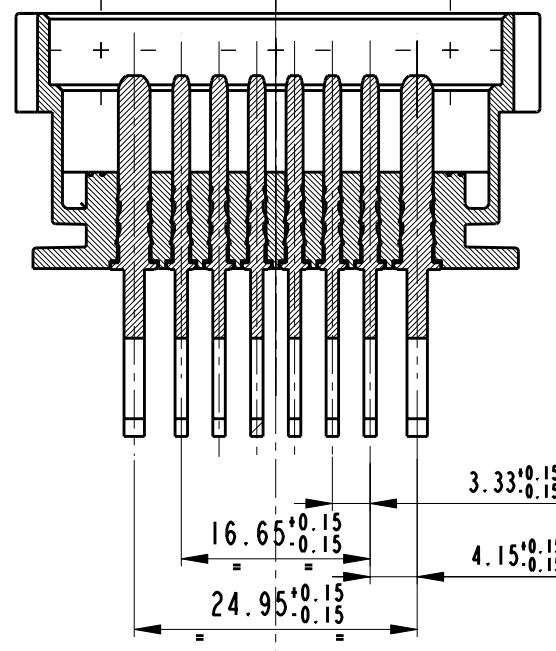

3.33<sup>+0.15</sup><sub>-0.15</sub> TOL NOT CUMULATIVE  
 16.65<sup>+0.15</sup><sub>-0.15</sub>  
 24.95<sup>+0.15</sup><sub>-0.15</sub>  
 4.15<sup>+0.15</sup><sub>-0.15</sub> TOL NOT CUMULATIVE

**KEY CODE**  
**"BLACK" COLOUR**

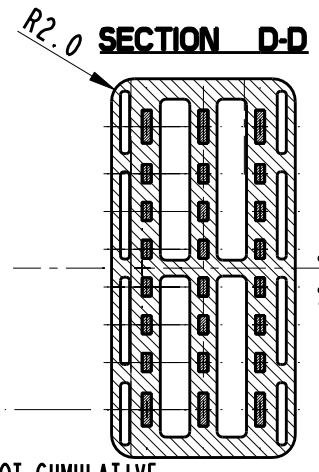

⊕ 0.55	A
⊕ 0.65	A
⊕ 0.75	A

**N° 18 CONTATTI 15 x 0.8**  
**N° 18 CONTACTS 15 x 0.8**  
**N° 6 CONTATTI 28 x 0.8**  
**N° 6 CONTACTS 28 x 0.8**

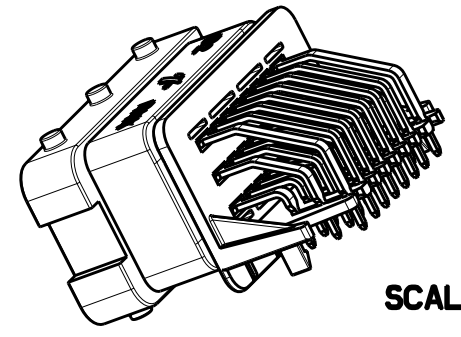
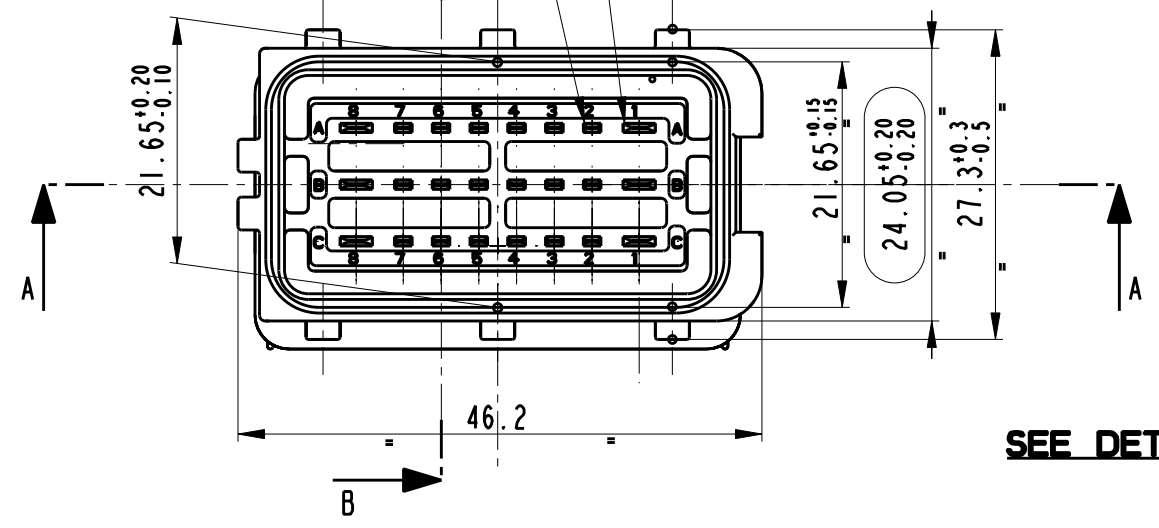

**SCALE 1:1**

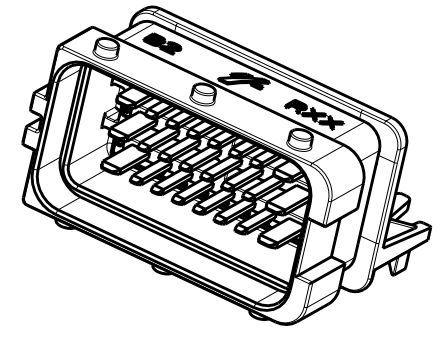

**SEE DETAIL X**

**SECTION B-B**

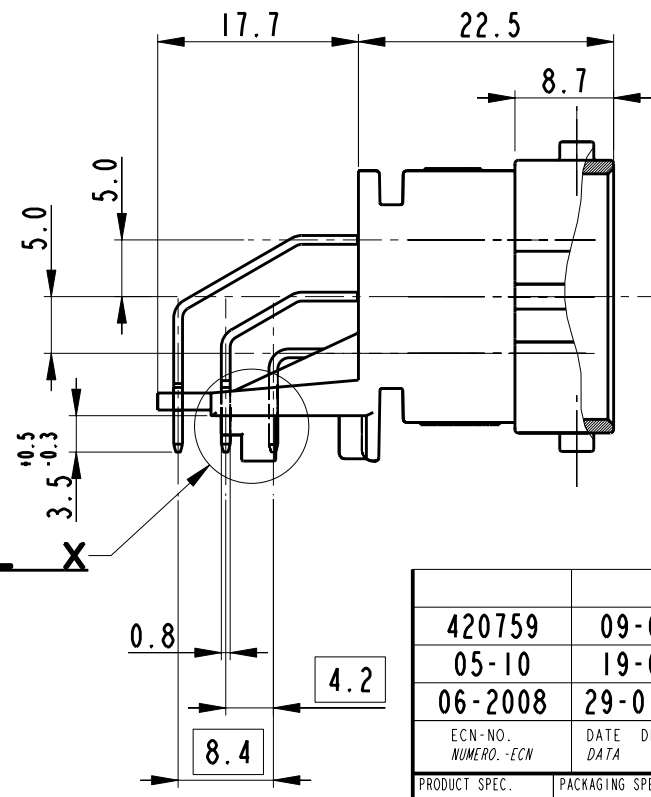

**SCALE 15:1**

**NOTE**

- ① HOUSING RAW MATERIAL: PBT 15 GLASS FIBER  
HOUSING TENSILE MODULUS: 5600 MPa at 20°C
- ② CONTACTS RAW MATERIAL; CuZn37; TIN OR GOLD PLATING
- ③ PRODUCT ACCORDING TO PSA SPECIFICATION: 9604596299
- ④ KEY CODE GREY-BROWN NOT SHOWN

○ CAPABILITY

420759	09-01-13	A	ADDED DELPHI P/N	D.T.	JMH	L.E.		
05-10	19-03-10	12	ADDED TENSILE MODULUS NOTE	D.T.		M.C.		
06-2008	29-01-2008	11	ADDED P/N FOR GOLD VERSION (SHEET 2)	F.G.		M.C.		
ECN-NO. NUMERO - ECN	DATE DD / MM / YY DATA	REVISION REVISIONE	POSITION POSIZIONE	CHANGE DESCRIPTION DESCRIZIONE MODIFICA		DRAWN BY DISEGNATORE	CHK. BY CONTROLLATO	APPR. BY APPROVATO

PRODUCT SPEC. SPEC. DI PRODOTTO	PACKAGING SPEC. SPEC. DI IMBALLAGGIO	APPLICATION SPEC. SPEC. DI APPLICAZIONE	COPYRIGHT DELPHI CORPORATION AND/OR ITS AFFILIATES. ALL RIGHTS RESERVED. REVISED THIS DRAWING IS THE PROPERTY OF DELPHI CORPORATION. THE REPRODUCTION, DISTRIBUTION AND UTILIZATION OF THIS DOCUMENT OR ITS RELATED CAD MATH DATA, AS WELL AS COMMUNICATION OF ANY CONTENT TO OTHERS, WITHOUT EXPRESS AUTHORIZATION IS PROHIBITED.	
TOLERANCES TOLLERANZE ± 0.3 mm / ± 1°		MATERIAL: MATERIALE	SURFACE FINISH FINITURA SUPERFICIALE	
COUNTERPART Nr. CONTROPARTE Nr.		<b>SEE SHEET 1</b>		<p>DELPHI PACKARD ELECTRICAL/ELECTRONIC ARCHITECTURE TORINO, ITALY</p>
DO NOT SCALE DRAWING DISEGNO FUORI SCALA		<b>SEE SHEET 2</b>		
DATE DATA	NAME NOME	TITLE DESCRIZIONE	LOC. CODE NAZIONALITA'	<p>ISO PROJECTION PROIEZIONE ISO</p>
DRAWN BY DISEGNATORE	CHECKED BY CONTROLLATO	APPROVED BY APPROVATO	ESR NO. NUMERO ESR	CAT. NO. NUMERO CAT.
06-12-02	R. Rampone			<b>SEE SHEET 2</b>
06-12-02	T. Ciriello			
DRAWING NUMBER NUMERO DISEGNO		FILE NAME NOME FILE		SCALE SCALA
<b>FSC 308654</b>		<b>FSC308654</b>		<b>3:2</b>

**24 WAY RECEPTACLE 90°**

**DELPHI**  
 DELPHI PACKARD ELECTRICAL/ELECTRONIC ARCHITECTURE  
 TORINO, ITALY

**C** ISO PROJECTION PROIEZIONE ISO

DIMENSION IN MILLIMETERS  
DIMENSIONI IN MILLIMETRI

CAD SYSTEM  
pro / eng.

DWG SIZE  
FORMATO  
**A3**

SHEET  
FOGLIO  
1 of 2  
di 2

**KEY CODE "A"**  
**COLOUR : BLACK**  
**PIN-HEADER CATALOG NUMBER:**

Tin Version		
MVL	PART NUMBER	HCCPHPE24BKA90F
	PART REVISION	A
DELPHI	PART NUMBER	33501039
	PART REVISION	01
Gold Version		
MVL	PART NUMBER	HCCPHPE24BKA90G
	PART REVISION	A
DELPHI	PART NUMBER	-
	PART REVISION	-

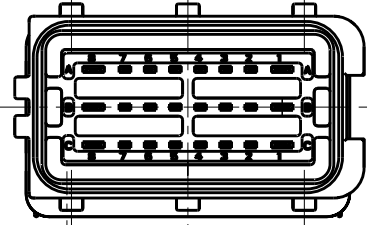

**COUPLING WITH FEMALE HOUSING**  
**CATALOG NUMBER:**  
**211 PC249S00XX**

**KEY CODE "B"**  
**COLOUR : GREY**  
**PIN-HEADER CATALOG NUMBER:**

Tin Version		
MVL	PART NUMBER	HCCPHPE24GYB90F
	PART REVISION	A
DELPHI	PART NUMBER	33501038
	PART REVISION	01
Gold Version		
MVL	PART NUMBER	HCCPHPE24GYB90G
	PART REVISION	A
DELPHI	PART NUMBER	-
	PART REVISION	-

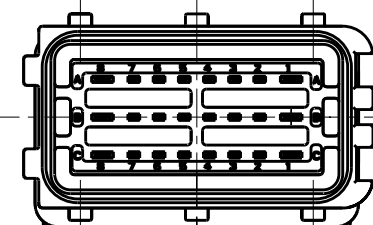

**COUPLING WITH FEMALE HOUSING**  
**CATALOG NUMBER:**  
**211 PC249S80XX**

**KEY CODE "C"**  
**COLOUR : BROWN**  
**PIN-HEADER CATALOG NUMBER:**

Tin Version		
MVL	PART NUMBER	HCCPHPE24BNC90F
	PART REVISION	A
DELPHI	PART NUMBER	-
	PART REVISION	-

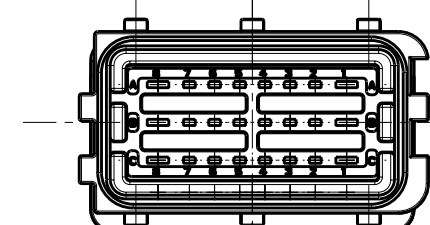

**COUPLING WITH FEMALE HOUSING**  
**CATALOG NUMBER:**  
**211 PC249S10XX**

DRAWING DISEGNO **C**

**STRICTLY CONFIDENTIAL**

**P.C.BOARD LAYOUT (BLACK)**

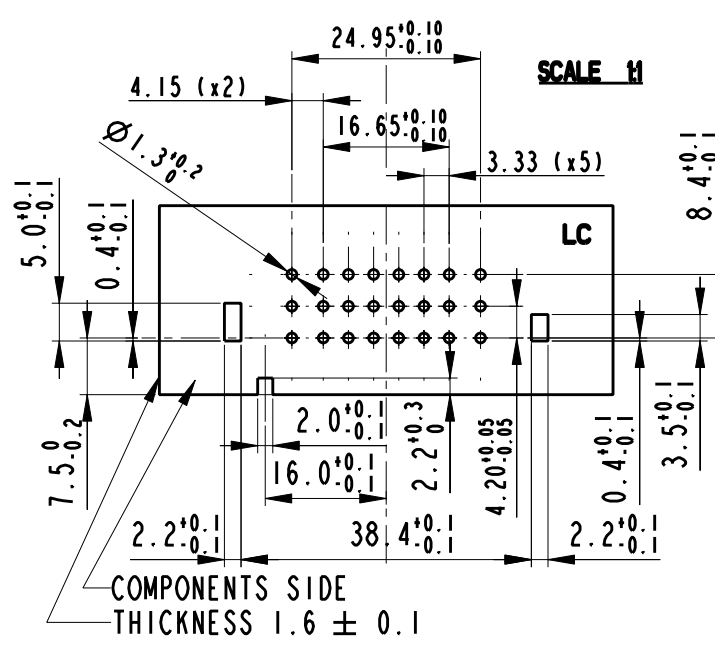

**P.C.BOARD LAYOUT (GREY)**

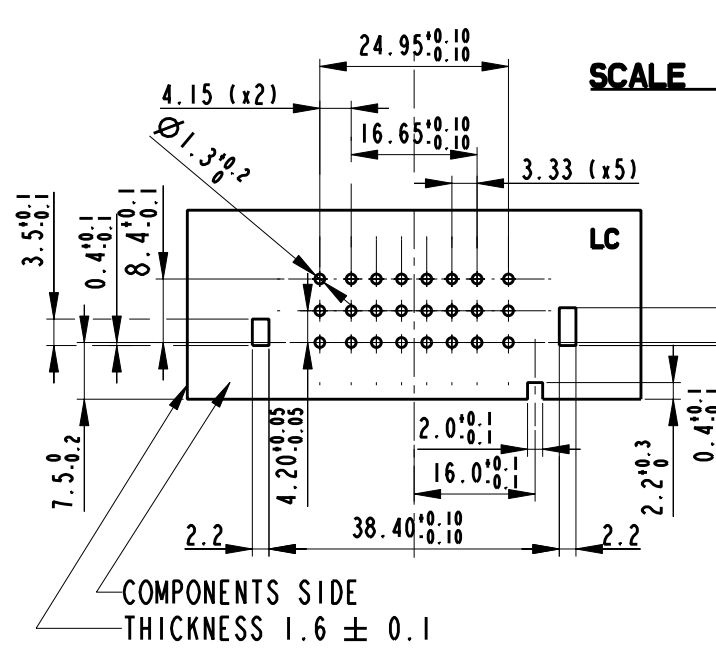

**P.C.BOARD LAYOUT (BROWN)**

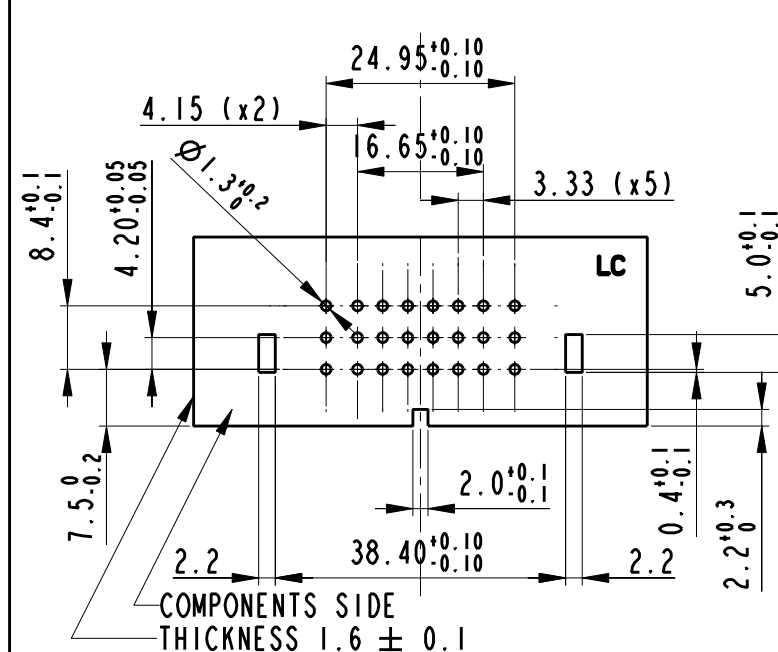

420759	09-01-13	A	ADDED DELPHI PN	D.T.	JMH	L.E.		
05-10	19-03-10	12	ADDED TENSILE MODULUS NOTE	D.T.		M.C.		
06-2008	29-01-2008	11	ADDED P/N FOR GOLD VERSION (SHEET 2)	F.G.		M.C.		
ECN-NO. NUMERO -ECN	DATE DATA	DD / MM / YY	REVISION REVISIONE	POSITION POSIZIONE	CHANGE DESCRIPTION DESCRIZIONE MODIFICA	DRAWN BY DISEGNATORE	CHK. BY CONTROLLATO	APPR. BY APPROVATO
PRODUCT SPEC. SPEC. DI PRODOTTO	PACKAGING SPEC. SPEC. DI IMBALLAGGIO	APPLICATION SPEC. SPEC. DI APPLICAZIONE	COPYRIGHT DELPHI CORPORATION AND/OR ITS AFFILIATES. ALL RIGHTS RESERVED. REVISED THIS DRAWING IS THE PROPERTY OF DELPHI CORPORATION. THE REPRODUCTION, DISTRIBUTION AND UTILIZATION OF THIS DOCUMENT OR ITS RELATED CAD MATH DATA, AS WELL AS COMMUNICATION OF ANY CONTENT TO OTHERS, WITHOUT EXPRESS AUTHORIZATION IS PROHIBITED.				DUE TO THIS DRAWING IS THE PROPERTY OF DELPHI CORPORATION AND/OR ITS AFFILIATES. ALL RIGHTS RESERVED. REVISED DOCUMENTO O DELLE SUE RELATIVE MATEMATICHE CAD, NONCHE LA COMUNICAZIONE DI QUALSIASI CONTENUTO AD ALTRI, SENZA ESPlicitA AUTORIZZAZIONE, E' PROIBITA	
TOLERANCES TOLLERANZE	± 0.3 mm / ± 1°	MATERIAL : MATERIALE :	SURFACE FINISH FINITURA SUPERFICIALE			<b>DELPHI</b> DELPHI PACKARD ELECTRICAL/ELECTRONIC ARCHITECTURE TORINO, ITALY		CAD SYSTEM
COUNTERPART Nr. CONTROPARTE Nr.		<b>SEE SHEET 1</b>				<b>pro / eng.</b>		
DO NOT SCALE DRAWING DISEGNO FUORI SCALA		<b>SEE SHEET 2</b>	LOC. CODE NAZIONALITA' <b>IT</b>			DIMENSION IN MILLIMETERS DIMENSIONI IN MILLIMETRI		
DRAWN BY DISEGNATORE	DATE DATA	NAME NOME	TITLE DESCRIZIONE			DRAWING NUMBER NUMERO DISEGNO		
CHECKED BY CONTROLLATO	06-12-02	R. Rampone	<b>24 WAY RECEPTACLE 90°</b>			<b>FSC 308654</b>		
APPROVED BY APPROVATO	06-12-02	T. Ciriello	ESR NO. NUMERO ESR			FILE NAME NOME FILE		
			<b>SEE SHEET 2</b>			<b>FSC308654</b>		
						SCALE SCALA <b>3:2</b>		