

Oct.1.2018 Copyright 2018 HIROSE ELECTRIC CO., LTD. All Rights Reserved.
 In case that the application demands a high level of reliability, such as automotive,
 please contact a company representative for further information.

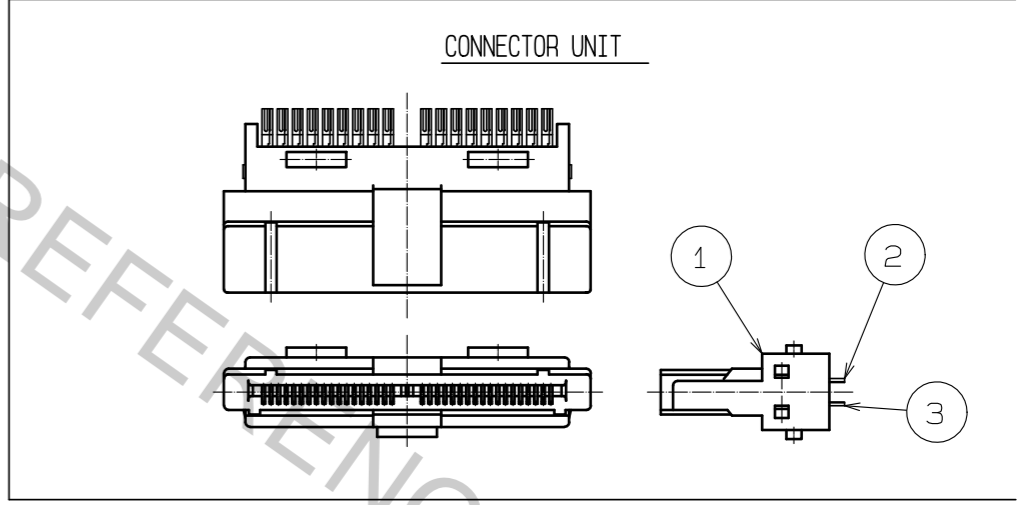
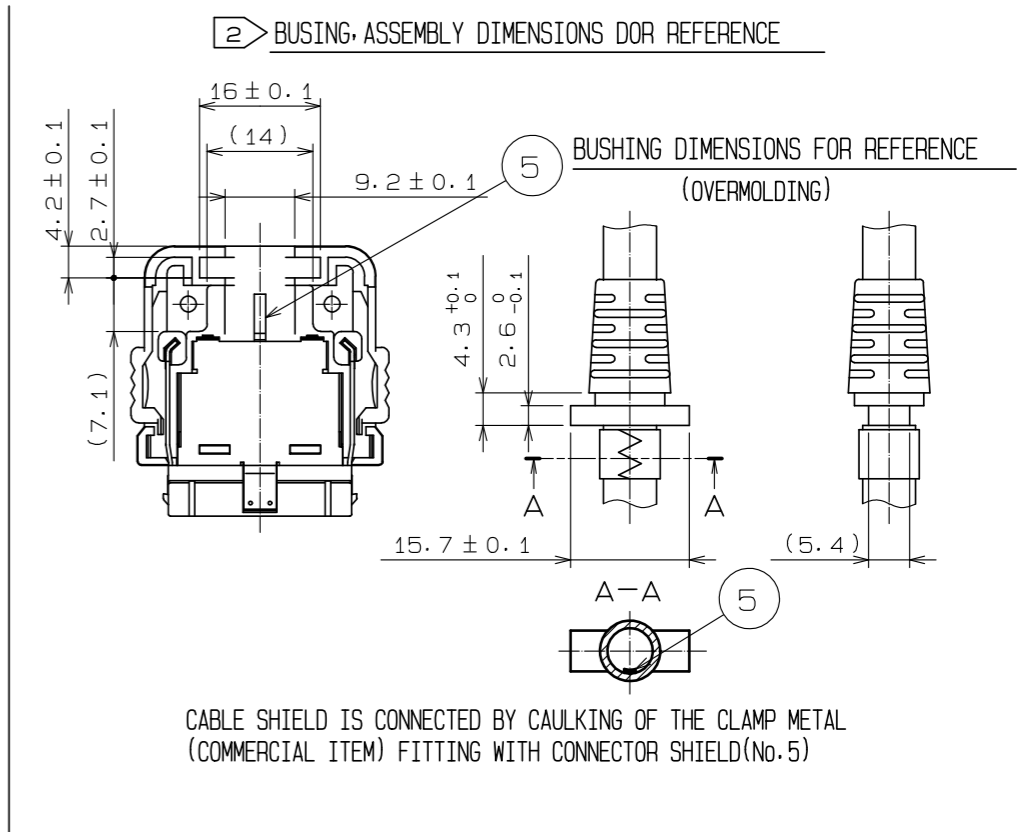
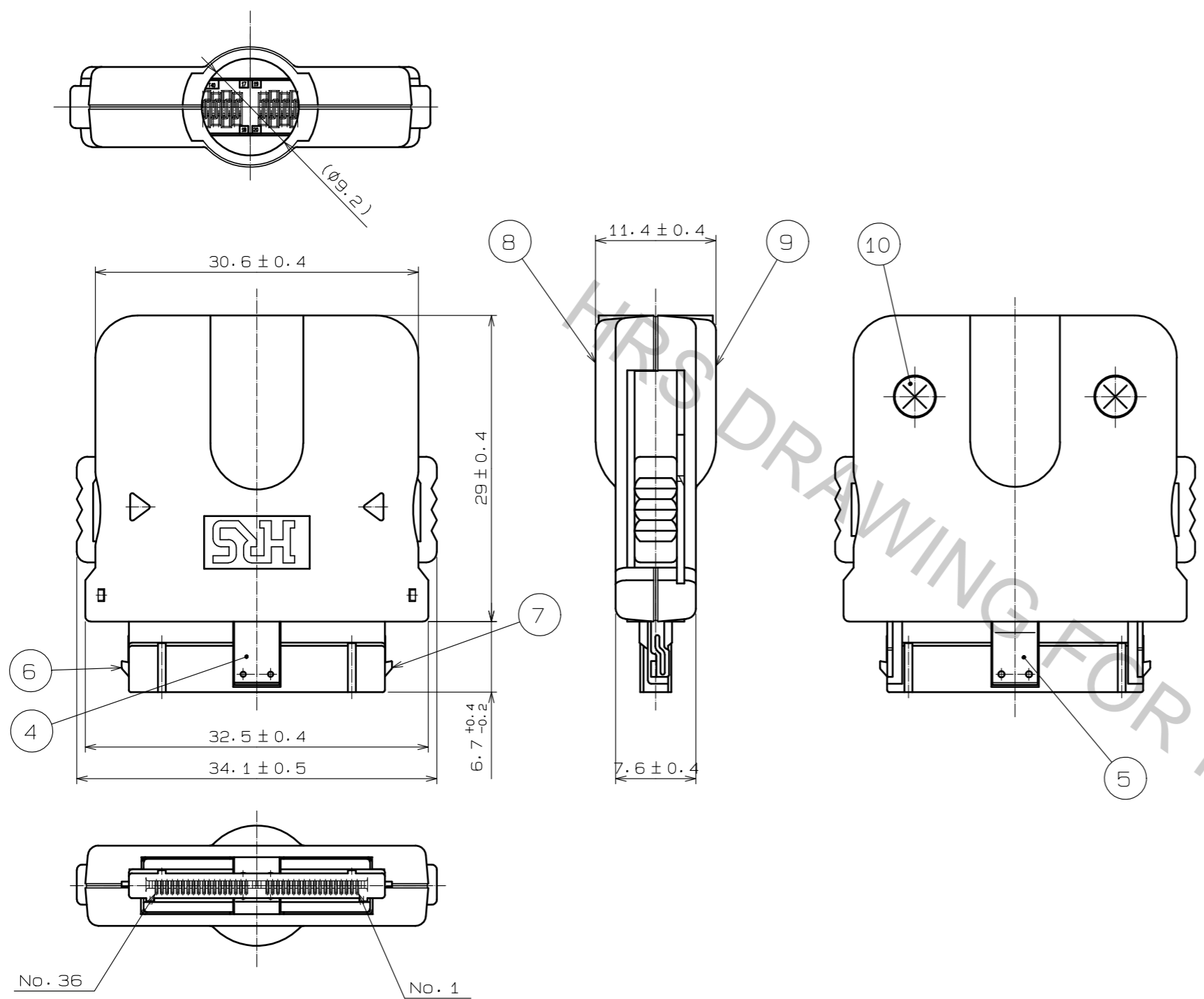

NOTE 1 APPLICABLE IS AWG28 MAX.
 LESS THAN $\phi 7$ mm IS PRESUMED CABLE SIZE.
 ② CABLE SHALL BE OVERMOLDED WITH BUSHING TO FIX.
 USE NON-MIGRATION RESIN FOR OVERMOLDING.
 ③ PLATING
 CONTACT AREA GOLD 0.2 μ m min.
 LEAD AREA GOLD FLASH.
 UNDER PLATING NICKEL 2 μ m min.
 4 THIS PRODUCT IS DELIVERED IN FOLLOWING CONDITIONS:
 UNIT WITH REF ② AND ③ ASSEMBLED TO REF 1.
 COVER WITH REF ⑥ AND ⑦ ASSEMBLED TO REF ⑨, AND
 REF ④ ⑤ ⑧ ⑩ DISASSEMBLED.

5	STAINLESS STEEL		10	STEEL	BLACK DCT(Cr3)
4	STAINLESS STEEL		9	PC-M	BLACK UL94V-0
3	COPPER ALLOY	③	8	PC-M	BLACK UL94V-0
2	COPPER ALLOY	③	7	STAINLESS STEEL	
1	PA-M	BLACK UL94V-0	6	STAINLESS STEEL	
NO.	MATERIAL	FINISH . REMARKS	NO.	MATERIAL	FINISH . REMARKS
UNITS mm		SCALE 2 : 1	COUNT	DESCRIPTION OF REVISIONS	
DESIGNED		CHECKED		DATE	
APPROVED : NM. NISHIMATSU 15.10.27			DRAWING NO. EDC-124423-30-00		
CHECKED : KN. ICHIKAWA 15.10.27			PART NO. ST40X-36S-CV(30)		
DESIGNED : TS. ITO 15.10.27			CODE NO. CL241-0034-4-30		
DRAWN : AK. AKIYAMA 15.10.27			1/1		