

## Features

- Push-pull latching system
- Chrome plated Brass
- IP68
- 360° Screening for full EMC shielding

## RS PRO Industrial Circular Connectors

RS Stock No.: 2406512



RS PRO is the own brand of RS. The RS PRO Seal of Approval is your assurance of professional quality, a guarantee that every part is rigorously tested, inspected, and audited against demanding standards. Making RS PRO the Smart Choice for our customers.

## Product Description

RS Pro's range of waterproof Chrome plated Brass push-pull locking connectors offer exceptional quality that is found in many cutting-edge connectors, including an IP68 rating and full 360° EMC shielding with a high mating life. As has become standard within the RS Pro brand you can expect high quality products but at a reasonable price. These connectors are ideal for use in medical devices, testing equipment, audio equipment and other high-end applications.

## General Specifications

Number of Contacts	3
Housing Material	Chrome Plated Brass
Contact Material	Brass
Contact Plating	Gold
Contact Gender	Female
Mating Type	Cable Mount
Body Orientation	Straight
Contact Carrier	PPS
Mating Cycles	>5,000
Colour	Natural
Application	Instrumentation, Process control, Robotics, Assembly lines and manufacturing, Factory automation, Industrial production and automation, Medical devices

## Electrical Specifications

Plug/Socket	Socket
Current Rating	18A
Test Voltage Contact-Shell k/vAC	1.60
Test Voltage Contact - Contact k/v AC	2.0

## Mechanical Specifications

Connector Size	2F
Termination Method	Solder
Mounting Type	Panel Mount
Cable Outer Diameter	6.7

## Operation Environment Specifications

Operating Temperature	-55°C to +250°C
-----------------------	-----------------

## Protection Category

IP Rating	IP68
-----------	------

## Approvals

Compliance/Certifications	RoHS, CE
---------------------------	----------

FOR MATING PARTS, SEE MATRIX:



### RM-F Series 2F

Plug Cable End			Mates With	Panel Mount			Or	In-Line Cable End		
RS Stock No.	No. of Contacts	Gender		RS Stock No.	No. of Contacts	Gender		RS Stock No.	No. of Contacts	Gender
2406580	2	Male	"	2406427	2	Female	"	2406511	2	Female
2406581	3	Male	"	2406428	3	Female	"	2406512	3	Female
2406582	4	Male	"	2406429	4	Female	"	2406513	4	Female
2406583	6	Male	"	2406430	6	Female	"	2406514	6	Female
2406584	8	Male	"	2406431	8	Female	"	2406515	8	Female
2406585	1+8	Male	"	2406432	1+8	Female	"	2406516	1+8	Female
2406586	16	Male	"	2406433	16	Female	"	2406518	16	Female
2406587	19	Male	"	2406434	19	Female	"	2406519	19	Female

The RS PRO Seal of Approval is only awarded after a rigorous quality process to demanding international standards.



Your smart choice

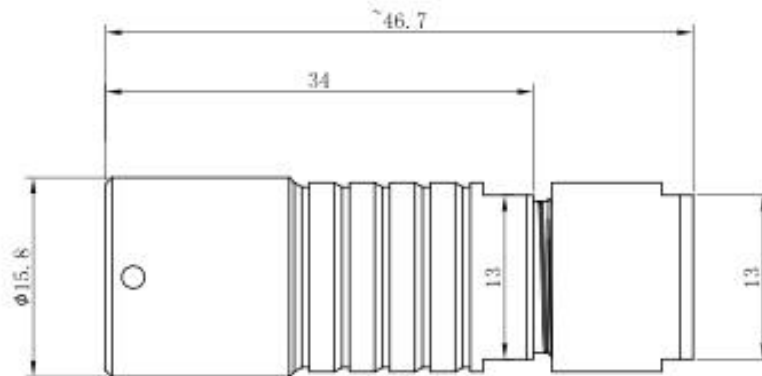

CONNECTOR SOLDER CUP VIEW

● — RED

