

REV	MODIFICATION	DATE	DRAW	APPROVE

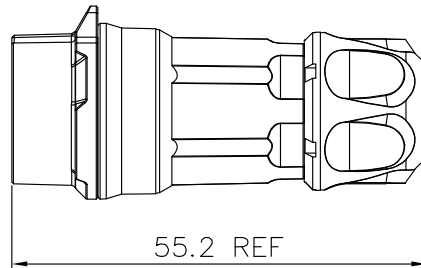
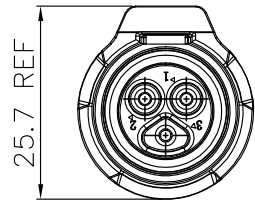
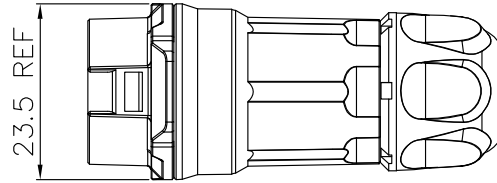
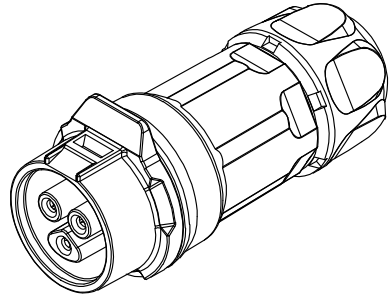

SPECIFICATIONS:
 Current Rating: PIN Number-A 10A; PIN Number-B 5A
 Operating Voltage: 400V MAX.
 Voltate Rating: 2500V MAX.
 Contact Resistance: 5.0mΩ MAX.
 Cable OD: ø3.0-ø8.5mm
 Waterproof Standard: IP 67

2	Contact	Phosphor Bronze	Gold Ptd.	2-9
1	Housing	PBT		5
No.	Description	Material	Treat	Q'ty

-TOLERANCES- UNLESS OTHERWISE SPECIFIED	
X.X ±0.25	X* REF ± 5*
X.XX ±0.15	X.* ± 3*
X.XXX±0.05	X*X* ± 1*
DRAWN	ROBIN
CHECKED	
APPROVED	
SCALE: AS SHOWN	UNIT: mm

Lumberg
 passion for connections

TITLE:
 LP16 Serie 261 Female Connector All Plastic

PRODUCT NO. ---

FILE NAME: ---

REV. A SHEET. A/A

TYPE	PIN NUMBER-A(10A)			PIN NUMBER-B(5A)			
P/N:	0261 02	0261 03	0261 04	0261 05	0261 07	0261 08	0261 09
Female Contact Face View							
Number Of Contact	2	3	4	5	7	8	9