

| | | |
|-----------|----|---|
| V_{RWM} | 22 | V |
| P_{PP} | 40 | W |
| V_{CL} | 38 | V |

● Features

- Small mold type
- High reliability

● Application

- ESD Protection

● Structure

- Silicon Epitaxial Planar

● Absolute Maximum Rating

| Parameter | Symbol | Conditions | Min. | Max. | Unit | |
|----------------------|-----------|--------------------------------|---------|------|------|----|
| Peak Pulse Power | P_{pp} | $t_p=10/1000\mu s$ | - | 40 | W | |
| Power dissipation | P_D | on Glass-epoxy substrate | - | 225 | mW | |
| | | on Alumina substrate | - | 300 | mW | |
| Junction temperature | T_j | - | - | 150 | °C | |
| Storage temperature | T_{stg} | - | -65 | 150 | °C | |
| ESD capability | V_{ESD} | IEC61000-4-2* | Contact | - | 30 | kV |
| | | | Air | - | 30 | kV |
| | | Machine model | - | 2 | kV | |
| | | Human body model (MIL-STD-883) | - | 8 | kV | |
| | | CDM (Charged device model) | - | 500 | V | |

*IEC61000-4-2

C=150pF R=330Ω

● Outline

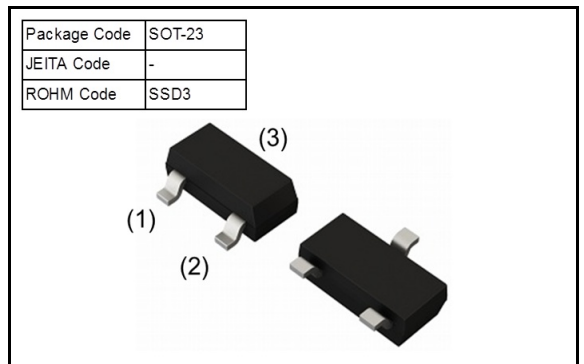

● Inner Circuit

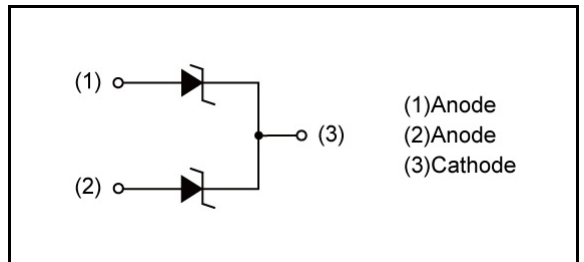

● Packaging Specification

| Packing | Embossed Tape |
|--------------------------|---------------|
| Reel Size(mm) | 180 |
| Taping Width(mm) | 8 |
| Basic Ordering Unit(pcs) | 3000 |
| Taping Code | T116 |
| Marking | 5T |

● Characteristics

| Parameter | Symbol | Conditions | Min. | Typ. | Max. | Unit |
|---------------------------|-----------|----------------------------|-------|------|-------|------|
| Reverse Stand-off voltage | V_{RWM} | - | - | - | 22 | V |
| Breakdown voltage | V_{BR} | $I_T=1mA$ | 25.65 | - | 28.35 | V |
| Reverse current | I_R | $V_R=22V$ | - | - | 50 | nA |
| Clamping voltage | V_{CL} | $I_{pp}=1A, t_p=10/1000us$ | - | - | 38 | V |
| Forward voltage | V_F | $I_F=200mA$ | - | - | 1.1 | V |

Breakdown voltage (V_{BR}) time is 40ms .

● Characteristic Curves

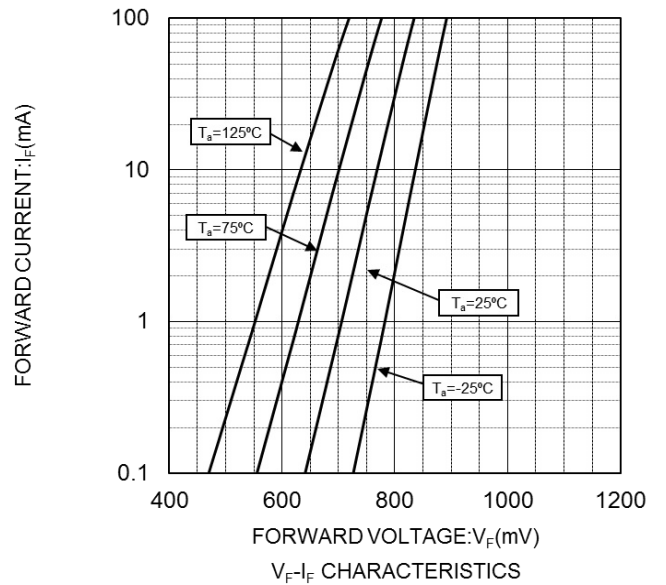
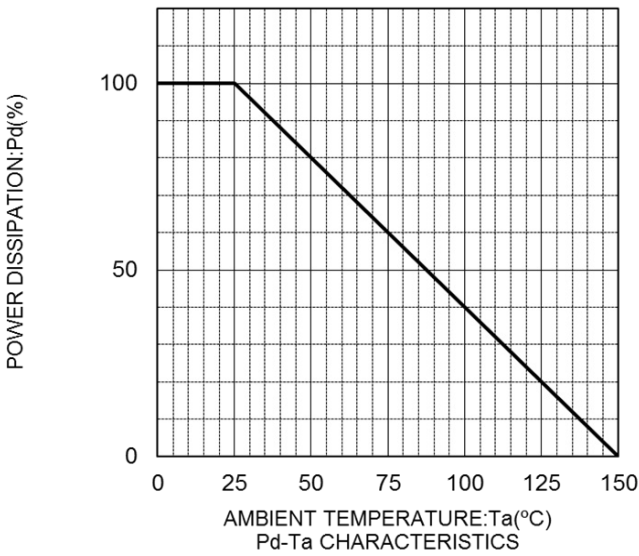
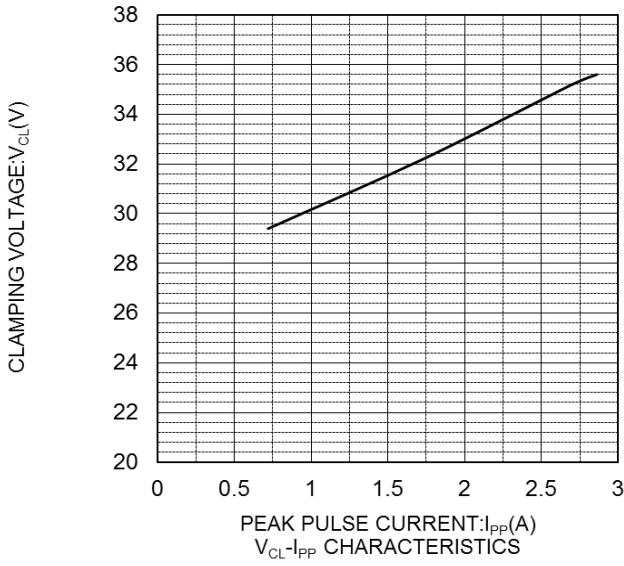

● Characteristic Curves

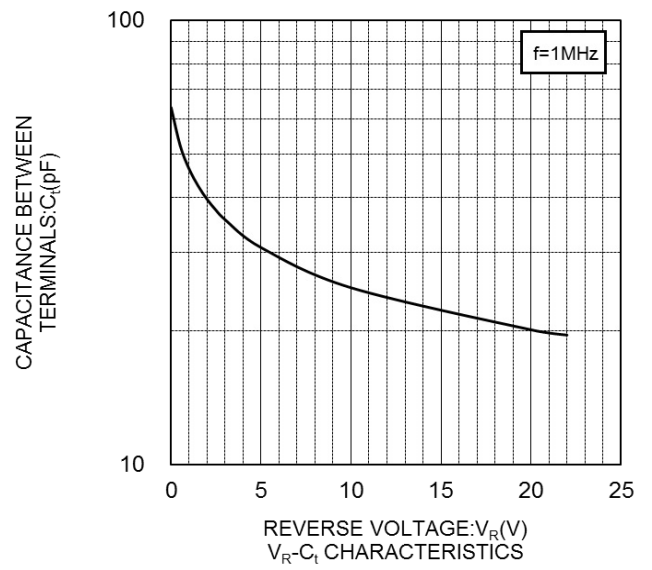
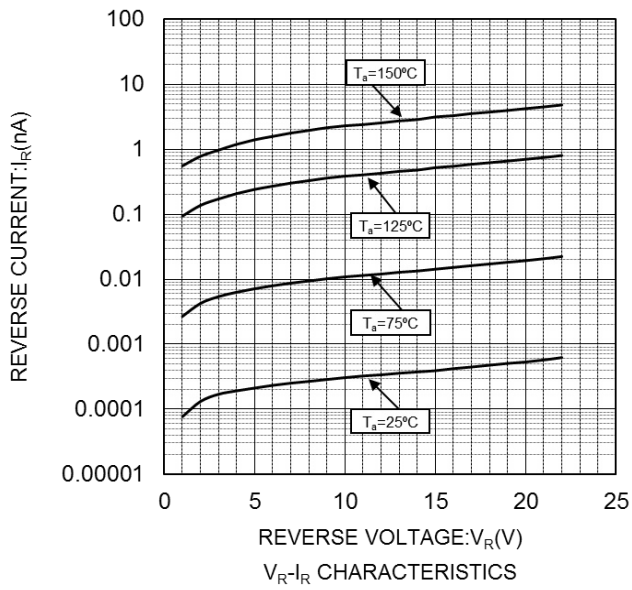

● Dimensions (SOT-23 SSD3)

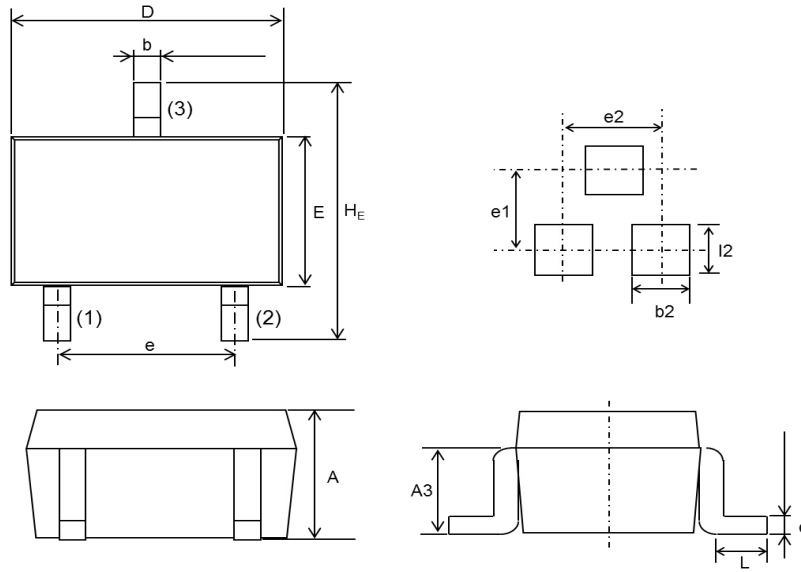

| DIM | Millimeters | | | Inches | | |
|-----|-------------|---------|------|--------|---------|-------|
| | Min. | Average | Max. | Min. | Average | Max. |
| A | 0.85 | 0.95 | 1.15 | 0.033 | 0.037 | 0.045 |
| A3 | 0.35 | 0.40 | 0.50 | 0.014 | 0.016 | 0.020 |
| b | 0.35 | 0.40 | 0.50 | 0.014 | 0.016 | 0.020 |
| c | 0.09 | 0.15 | 0.25 | 0.004 | 0.006 | 0.010 |
| D | 2.70 | 2.90 | 3.10 | 0.106 | 0.114 | 0.122 |
| E | 1.20 | 1.30 | 1.50 | 0.047 | 0.051 | 0.059 |
| HE | 2.20 | 2.40 | 2.60 | 0.087 | 0.094 | 0.102 |
| L | 0.20 | - | - | 0.008 | - | - |
| e | 1.70 | 1.90 | 2.10 | 0.067 | 0.075 | 0.083 |
| l2 | 1.00 | - | - | 0.039 | - | - |
| b2 | 0.80 | - | - | 0.031 | - | - |
| e1 | - | 2.10 | - | - | 0.083 | - |
| e2 | - | 1.90 | - | - | 0.075 | - |

● Taping (Unit:mm)

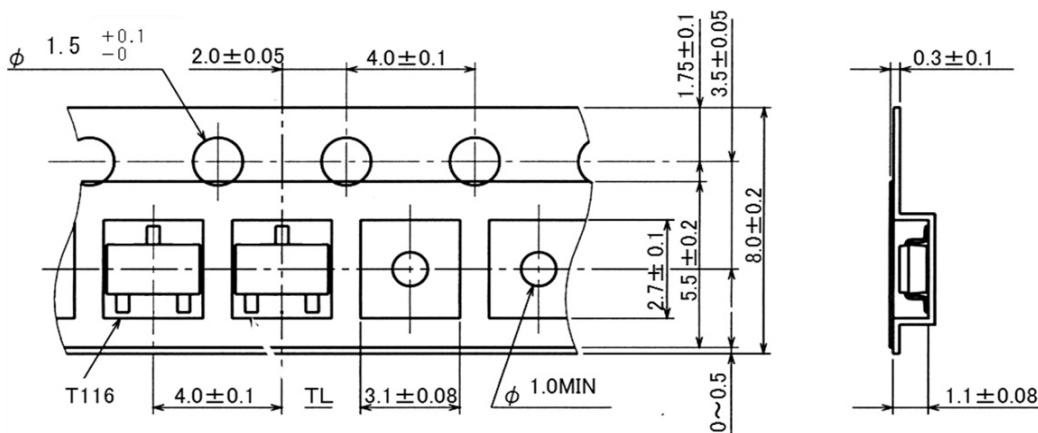



MMBZ27VCLFH - Web Page

[Distribution Inventory](#)

| | |
|-----------------------------|-------------|
| Part Number | MMBZ27VCLFH |
| Package | SOT-23 |
| Unit Quantity | 3000 |
| Minimum Package Quantity | 3000 |
| Packing Type | Taping |
| Constitution Materials List | inquiry |
| RoHS | Yes |