

FEATURES

- 3/2 Direct acting, sensitive action
- Zero pressure starting, suitable for vacuum applications
- Coaxial shut-off design, balanced spool without back pressure, no influence from working medium pressure and excellent sealing

RS PRO Solenoid Valve

RS Stock No.: 2351141



3/2 Direct Acting

Product Description

Part No.	Thread	Voltage
2351141	1/4" BSPP	24 V DC

Features

- 3/2 Direct acting, sensitive action
- Zero pressure starting, suitable for vacuum applications
- Coaxial shut-off design, balanced spool without back pressure, no influence from working medium pressure and excellent sealing

General Specifications

Working pressure	0-1 to 1 MPa
Temperature	-20°C to +70°C

Materials

Body	Aluminium alloy, hard oxidized surface treatment
Seals	NBR

Similar Product

Number	2351140	2351141
Working Medium	Clean air (after 40 µm filtration)	
Acting Type	Direct Acting	
Sectional Area(mm)	3.2(CV=0.18)	3.4(CV=0.19)
Port Size	G1/8	G1/4
Lubrication	Not required	
Working Pressure	-0.1-1 MPa	
Max.Pressure	1.5 MPa	
Working Temperature	-20-70°C no freezing	
Voltage Range	-15%-10%	
Power Consumption	DC:3W	
Insulation Class	F Class	
Protective Class	IP65(DIN40050)	
Max.acting Frequency	10 Cycles/s	
Seals Material	NBR	
Response Time	15ms Below	
Weight	163g	159g
Remark: Max.acting frequency on unload status.		

Dimensions

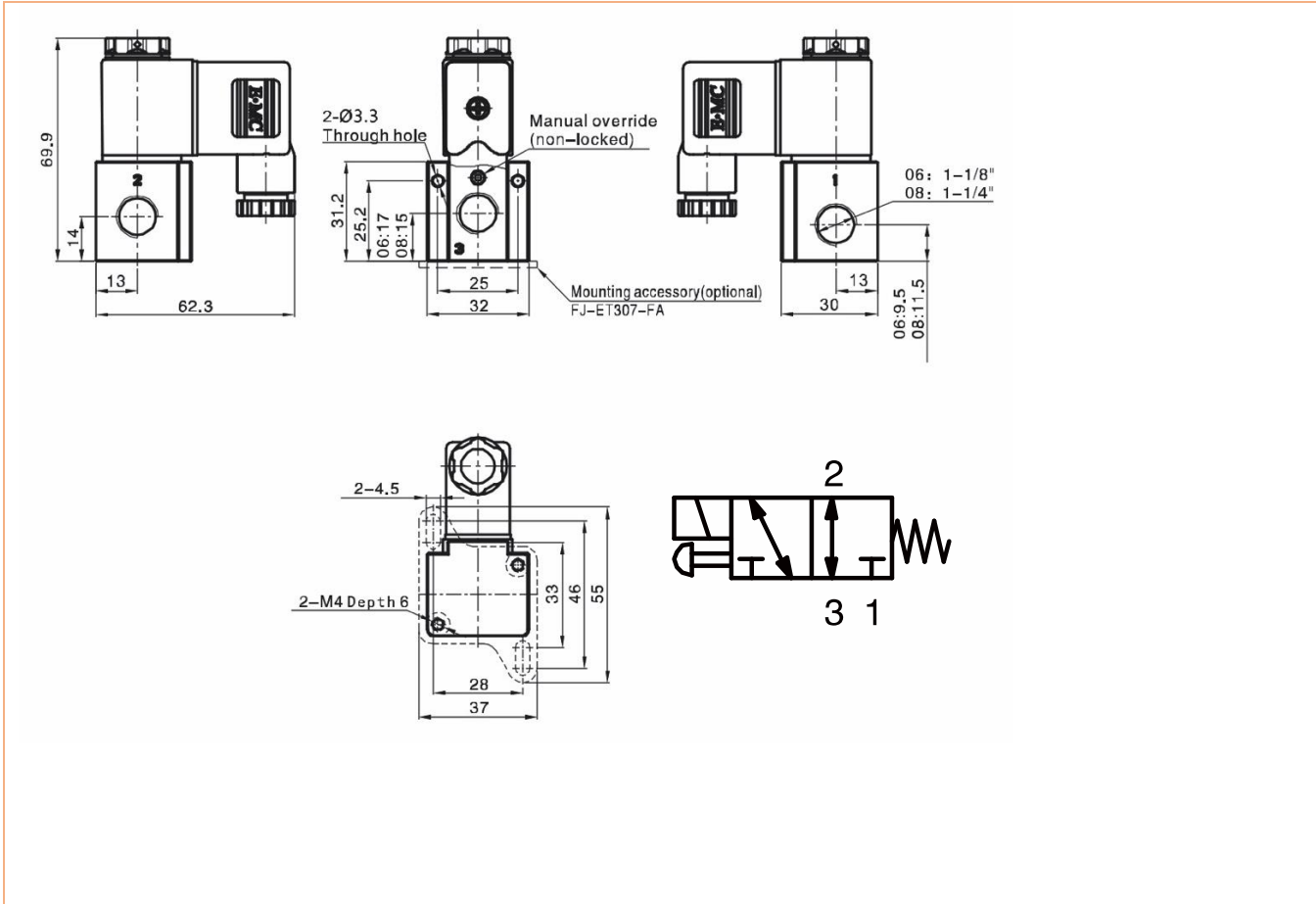

Similar Products

Part No.	Thread	Voltage
2351140	1/8" BSPP	24 V DC