

Receptacle, crimped A

KS-075 35 G

Item KS-07535G



ingun[®]

Partner for Future Technology

INGUN SELECTION

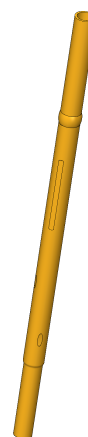

1:1

Receptacle, crimped A

KS-075 35 G

Item KS-07535G



ingun[®]

Partner for Future Technology

General data

Product group	Receptacles (KS)
Series	KS-075
Sub-series	KS-075 press-in version
Type of receptacle connection	Plug / open
Press ring	Yes
Surface area	Gold
Collar diameter	1.47 mm [.057 in]
Collar height	7.6 mm [.299 in]
Knurl	No
Vacuum-tight	No
RoHS-compliant	Yes

INGUN SELECTION

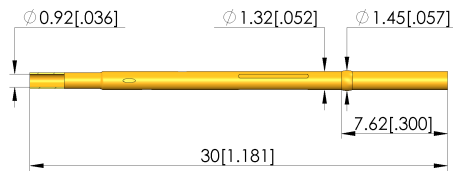

Mounting hole

Mounting hole in CEM1	1.30 - 1.32 mm [.051 - .051 in]
Mounting hole in FR4	1.31 - 1.33 mm [.051 - .052 in]
Mounting hole with press ring in CEM1	1.39 - 1.40 mm [.054 - .055 in]
Mounting hole with press ring in FR4	1.39 - 1.40 mm [.054 - .055 in]

Mechanical data

Total length	30 mm [1.18 in]
Outer diameter	1.32 mm [.051 in]

INGUN Prüfmittelbau GmbH

Max-Stromeyer-Straße 162
78467, Constance, Germany
Phone +49 7531 8105-0
Customer hotline +49 7531 8105-888
Fax +49 7531 8105-65
info@ingun.com



Prices and delivery times on request.
Technical changes reserved. 11/22 EN

Weitere Informationen zum Thema
Test probes



RECEPTACLES