

# Cellular Flexible Antennas

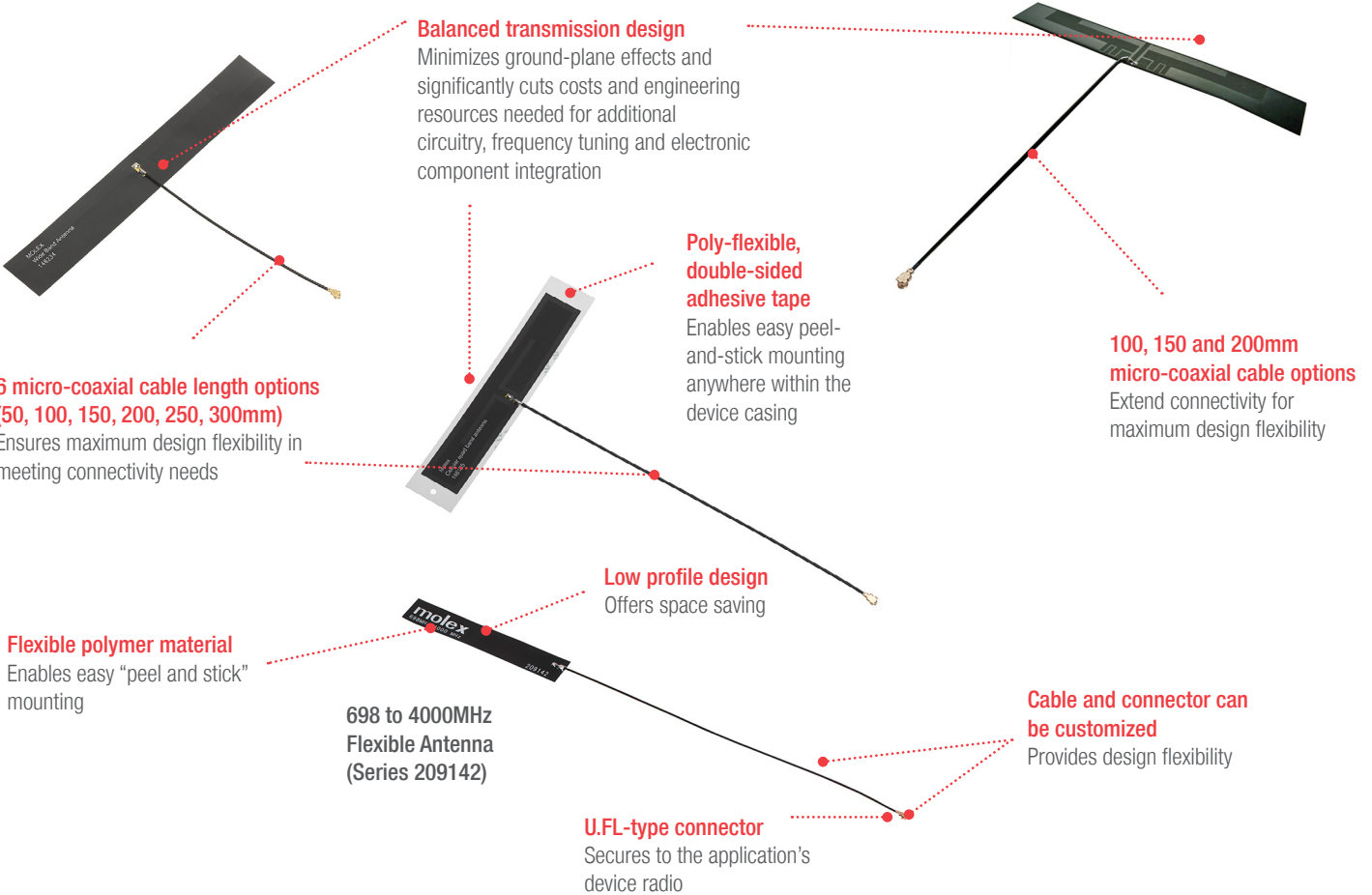

Wide-band antenna future-proofs wireless application developments to support evolving LTE and 4G cellular technologies

## Features and Advantages



## Applications

### Telecommunications/Networking

Infrastructure/Networking

### Industrial Automation

- Smart grid concentrators
- Smart meters
- Home energy displays
- Remote sensors
- Alarm and monitoring systems

### Consumer

- Home entertainment
- Home office



Networking Servers



Alarm and Monitoring Systems



Home Entertainment Systems

## Specifications

### REFERENCE INFORMATION

Designed In: Millimeters  
 Mates With: Surface-mount, micro-coaxial jack  
 (Part Number: 73412-0110) or other compatible  
 RoHS: Yes  
 Halogen Free: Yes  
 Glow Wire Capable: No

### ELECTRICAL

Voltage (Watt): 2  
 Input Impedance (Ohms): 50

### MECHANICAL

Cable Pull Force (min.): 8.0N  
 Un-mating force (min.): 0.5 kgf

### PHYSICAL

Cable Outer Diameter (mm): 1.13  
 Operating Temperature: -40 to +85°C

Series	212570	207235	146185	105263	209142	146234	207901
Packaging	PET film	PET film	PET film	Tray	PET film	PET film	PET film
Frequency	824 to 960 MHz / 1.7 to 2.17 GHz				698 to 960 MHz / 1.5 to 3 GHz / 3 to 6 GHz		600 to 960 MHz / 1.5 to 3 GHz / 3 to 6 GHz
Dimensions (mm)	40.40 by 15.40 by 0.10	40.40 by 15.40 by 0.10	84.00 by 15.00 by 0.10	106.60 by 13.00 by 0.10	85.00 by 14.50 by 0.10	140.00 by 20.00 by 0.10	147.00 by 25.00 by 0.10
Return Loss	<-4 / <-3	<-4 / <-6	<-4	<-6	<-10 / <-5 / <-5	<-4 / <-5 / <-5	<-3 / <-5 / <-5
Average Total Radiation Efficiency	>25% / >50%	30% / 60%	>60% / >65%	>66% / >60%	>45% / >55% / >55%	>69% / >68% / >67%	>70% / >65% / >70%
Peak Gain (dBi)	-0.45 / 1.76	0 / 4.3	1.4 / 3.0	2.3 / 3.1	1.2 / 5.2 / 2.7	1.7 / 2.65 / 4.8	2.6 / 4.9 / 5.4

## Ordering Information

Series No.	Description	Frequency Bands	Dimension (mm)
<a href="#">146234</a>	Wide-band Cellular Flexible Antenna	698 to 960 MHz / 1.5 to 6 and 2.7 to 6 GHz	140.00 by 20.00 by 0.10
<a href="#">146185</a>	Cellular Quad-band Flexible Antenna	824 to 960 MHz; 1.71 to 2.7 GHz and 3 to 6 GHz	84.00 by 15.00 by 0.10
<a href="#">105263</a>	Multi(6)-band Flexible Antenna	824 to 960 MHz; 1.71 to 2.7 GHz	106.60 by 13.00 by 0.10
<a href="#">207235</a>	Cellular Flexible Antenna	824 to 960MHz; 1.71 to 2.17GHz	40.40 by 15.40 by 0.10
<a href="#">207901</a>	Flexible Antenna	600 to 960MHz; 1.50 to 3GHz; 3 to 6GHz	147.00 by 25.00 by 0.16
<a href="#">209142</a>	Flexible Antenna	698 to 960MHz; 1710 to 2690MHz; 3300 to 4000MHz	85.00 by 14.50 by 0.10
<a href="#">212570</a>	Flexible Antenna, Side-Fed	824 to 960MHz; 1.71 to 2.17GHz	40.40 by 15.40