

# Standard terminal blocks

## Compression clamp

DIN 1 - 3

End stop	th. 9 mm	<b>BADL V0</b>	<b>0199 408.02</b>
End stop	th. 9,1 mm	<b>BAM</b>	<b>0103 002.26</b>
Rail	35 x 7,5 x 1	<b>PR30</b> prepunched	<b>0173 220.05</b>
Rail	35 x 15 x 2,3	<b>PR4</b>	<b>0168 500.12</b>
Rail	35 x 15 x 1,5	<b>PR5</b> prepunched	<b>0101 598.26</b>
Rail	32 x 15 x 1,5	<b>PR1Z2</b>	<b>0163 050.04</b>

Other end stops and rails : See Accessories section

### Characteristics

#### Wire size

		IEC	UL	CSA
		NFC DIN		
Compression clamp	Solid wire	0,5-25 mm <sup>2</sup>	18-4 AWG	18-4 AWG
	Stranded wire	0,5-16 mm <sup>2</sup>	18-4 AWG	18-4 AWG

#### Voltage

	800 V	600 V	600 V
Rated			
Pulse	8 kV		
Pollution degree	3		

#### Current

	85 A	85 A	100 A
Rated			

#### Wire size

Rated / Gauge	16 mm <sup>2</sup> / B7	4 AWG	4 AWG
Wire stripping length	Recomm. Screwdriver	Recomm. torque	Protection
14 mm	5,5 mm	1,2-1,4 Nm	IP 20
55"	.22"	10.6-12.3 lb.in	NEMA 1

### Notes

The use of some accessories may decrease the block's voltage rating. For more information, consult us.

## M 16/12...

Spacing 12 mm - 0,1 (.473")

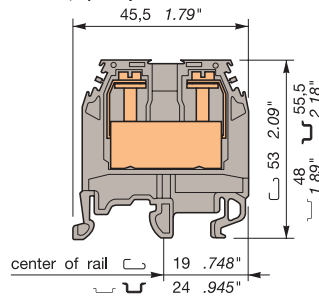

Standard 12 mm block with partition.

0115 129.14

Color	Type	Part numbers
<b>Standard blocks</b>		
Grey	<b>M 16/12</b>	<b>0115 129.14</b>
Blue	<b>M 16/12.N</b>	<b>0125 129.16</b>
Yellow	<b>M 16/12</b>	<b>0105 129.23</b>
Beige V0	<b>M 16/12.V0</b>	<b>0195 129.15</b>
Blue V0	<b>M 16/12.N.V0</b>	<b>0199 005.21</b>



### Accessories

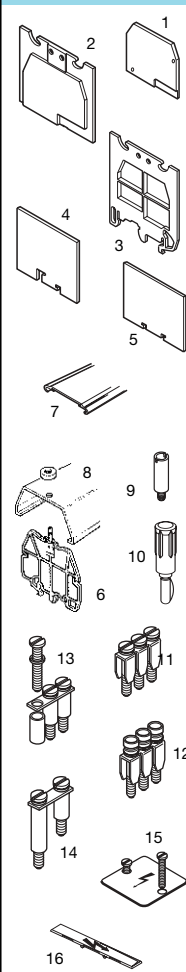

Type	Part numbers
<b>1</b> End section	grey <b>FEM12</b> th. 3,0 mm <b>0118 618.01</b> blue <b>FEM12</b> th. 3,0 mm <b>0128 618.03</b> yellow <b>FEM12</b> th. 3,0 mm <b>0103 065.24</b> beige <b>FEM12 V0</b> V0 th. 3,0 mm <b>0198 618.02</b> blue <b>FEM12 V0</b> V0 th. 3,0 mm <b>0199 303.00</b>
<b>2</b> Separator end section	grey <b>SCF12</b> th. 3,0 mm <b>0113 102.10</b> beige <b>SCF12 V0</b> V0 th. 3,0 mm <b>0193 102.11</b>
<b>3</b> Separator end section	grey <b>SCFM6</b> (1) th. 3,0 mm <b>0114 825.05</b>
<b>4</b> Separator end section	grey <b>SCFEX1</b> (1) th. 2,4 mm <b>0103 619.04</b>
<b>5</b> Separator end section	grey <b>SCFEX3</b> (1) th. 2,4 mm <b>0103 620.01</b>
<b>6</b> Separator end section for cover CPV	grey <b>SCFCV 1.2</b> th. 3,0 mm <b>0116 795.11</b> beige <b>SCFCV 1.2 V0</b> V0 th. 3,0 mm <b>0196 795.12</b>
<b>7</b> Protective cover	<b>CPM</b> (for SCF12..., SCFM6) <b>0187 312.14</b>
<b>8</b> Protective cover	<b>CPV 1.2</b> (for SCFCV1.2...) <b>0176 816.12</b>
<b>9</b> Test socket	<b>AL2</b> DIA. 2,0 mm <b>0163 043.21</b> <b>AL3</b> DIA. 3,0 mm <b>0163 261.00</b> <b>AL4</b> DIA. 4,0 mm <b>0163 262.01</b> <b>FC2</b> DIA. 2,0 mm <b>0007 865.26</b> <b>FC4</b> DIA. 4,0 mm <b>0167 860.01</b>
<b>10</b> Test plug	
<b>11</b> Assembled jumper bar	76 A <b>BJM 12</b> (2) 2 poles <b>0179 618.16</b> 76 A <b>BJM 12</b> (2) 3 poles <b>0179 619.17</b> 76 A <b>BJM 12</b> (2) 4 poles <b>0179 620.14</b> 76 A <b>BJM 12</b> (2) 5 poles <b>0179 621.01</b> 76 A <b>BJM 12</b> (2) 10 poles <b>0179 622.02</b>
<b>12</b> Assembled jumper bar (with IP20 protection)	76 A <b>BJMI 12</b> (2) 2 poles <b>0179 626.06</b> 76 A <b>BJMI 12</b> (2) 3 poles <b>0179 628.10</b> 76 A <b>BJMI 12</b> (2) 4 poles <b>0179 629.11</b> 76 A <b>BJMI 12</b> (2) 5 poles <b>0179 630.16</b> 76 A <b>BJMI 12</b> (2) 10 poles <b>0179 631.03</b>
<b>13</b> Jumper bar not assembled post + screw + washer	57 A <b>BJS 12</b> (2) 20 poles <b>0177 653.07</b> <b>EV12</b> <b>0168 664.11</b>
<b>14</b> Universal jumper bar	95 A <b>BJDP2</b> (2)(3) spacing 12 <-> spacing 16 <b>0179 624.04</b> 70 A <b>BJDP3</b> (2)(3) spacing 12 <-> spacing 6-6,5-8 or 10 <b>0179 625.05</b>
<b>15</b> Protection label	<b>EP10</b> 3 blocks <b>0163 429.21</b> <b>EP12</b> 4 blocks <b>0163 430.26</b> <b>VSP12</b> <b>0163 432.14</b>
Screw for protection label	<b>EPU6</b> <b>0107 038.25</b>
<b>16</b> Protection label	

**R** See section on markers marking method

Note : (1) Separator end sections snapped on rails. (2) Use of these accessories requires the user to cut out the partition. (3) See column : "Various applications". (4) Use 2 labels EPU6 (spacing 12 mm).