

UGD

Gearboxes

UGD

Dimensions (mm)	55 x 65,6
Max. torque (cNm)	32
Ratios	4 1/6 ... 6.048.000
Internal slipping clutch	optional
Standard shaft (mm)	∅ 4 x 10
Weight (g)	35
Motor combination	Series UB and UD; Series UF without UFR3/4 and UFB3/4



Standard Data

Mounting	any position
Axial thrust F_A	10 N
Lateral force F_R	50 N
Lateral torque M_R	50 cNm
Slipping clutches/free wheel	Single-way clockwise/anti clockwise function and two way
Slipping-/free wheel torque	1 ... 32 cNm
Output shafts	∅ 4 x 10, other on request
Climatic class	"wide-spread" according to IEC 721, part 2-1
Ambient temperature operation	°C -15 ... +55
Ambient temperature storage	°C -40 ... +80

Ratios	4 1/6	5	8 1/3	10	12 1/2	15	16 2/3	20 5/6	25	30	33 1/3	40		
	41 2/3	45	50	60	62 1/2	83 1/3	100	120	125	150	166 2/3	200	250	
	300	375	500	600	625	750	900	1000	1200	1500	1800	2000	2400	
	2500	3000	3600	3750	4500	5000	6000	7500	9000	10000	12000	15000	18000	
	21600	22500	30000	36000	45000	54000	60000	72000	90000	108000	112500	120000	180000	
	216000	225000	270000	300000	360000	432000	450000	720000	864000	1800000	5040000	6048000		

Order Reference

Type	Gearbox	UGD	100	N	5cNm	N
Ratio	100					
Slipping clutch	N without slipping clutch ER One-way slipping clutch, clockwise EL One-way slipping clutch, anti clockwise Z Two-way slipping clutch					
Slipping torque	5 cNm					
Shaft end	N ∅ 4 x 10, other on request					

Drawing

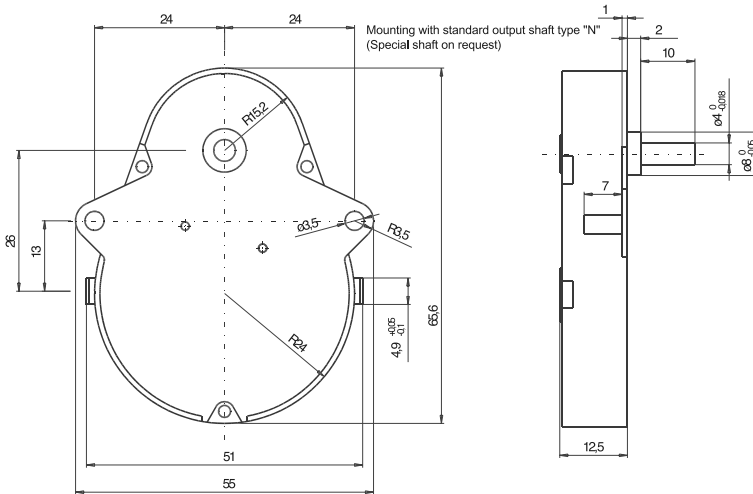

Slipping clutches

	max. torque available at output shaft (cNm)	free wheel-/clutch torque (cNm)
Roller-type free wheel	32	1
Single-way slipping clutches	32	4 ... 25 anti clockwise or clockwise function
Two-way slipping clutches	3 ... 15	2 ... 32

Torque / ratio / life graph

