

DO NOT SCALE DRAWING

REVISION

A INITIAL DRAWING 25.01.16

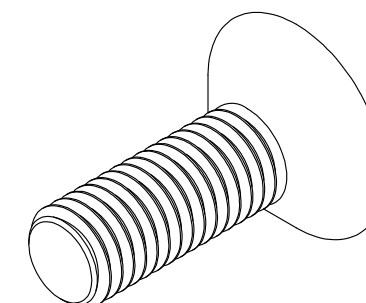
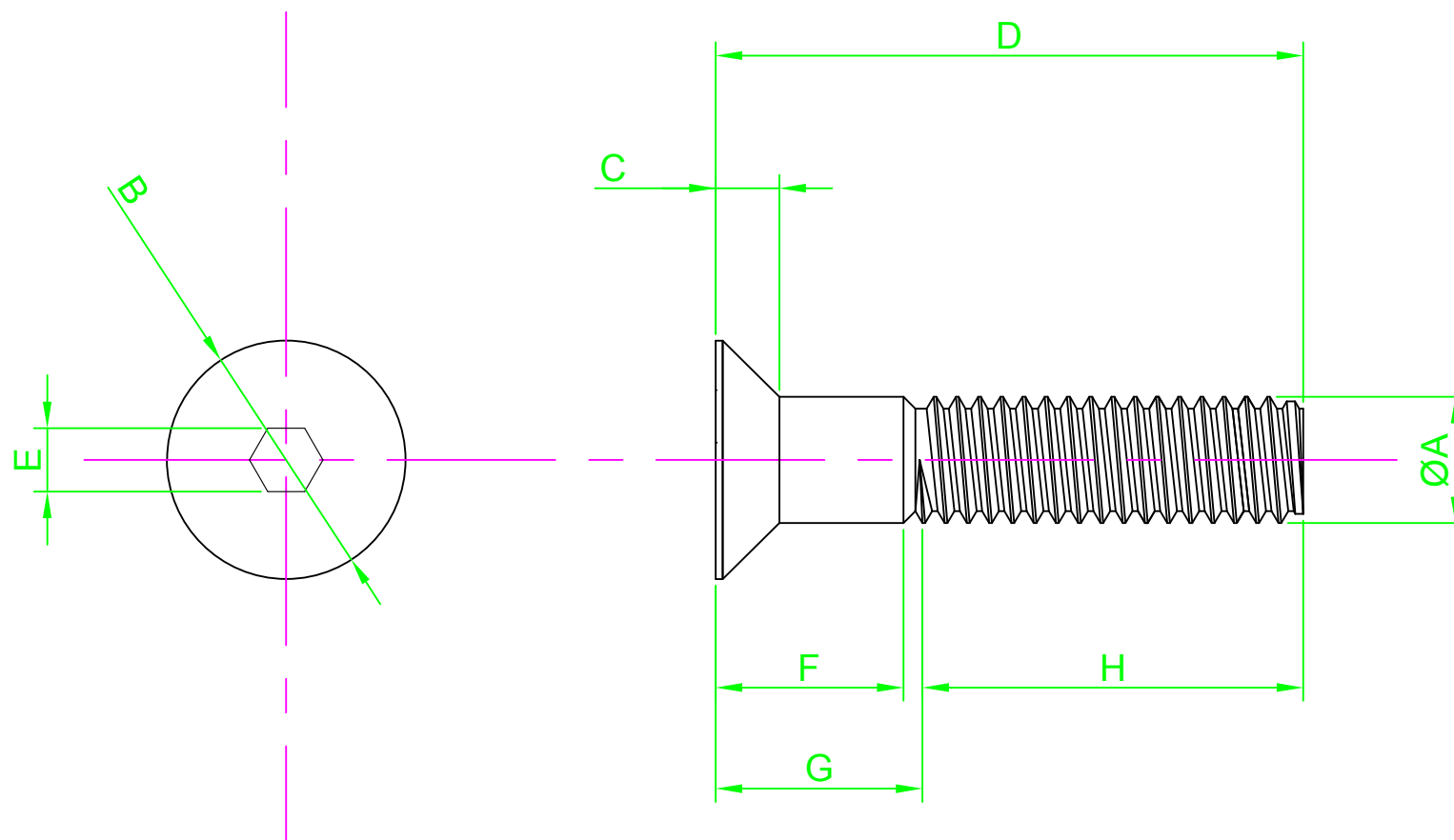

Part Number	ØA	B Nom	C Max	D Length	E Nom	F Min	G Max	H Ref
M4 8 KH10MC Z50	M4-0.7	8.0	2.3	8.0	2.5	N/A	4.40	N/A
M4 10 KH10MC Z50				10.0				
M4 12 KH10MC Z50				12.0				
M4 16 KH10MC Z50				16.0				
M5 10 KH10MC Z50	M5-0.8	10.0	2.8	10.0	3.0	N/A	5.20	N/A
M5 12 KH10MC Z50				12.0				
M5 16 KH10MC Z50				16.0				
M5 20 KH10MC Z50				20.0				
M6 12 KH10MC Z50	M6-1.0	12.0	3.3	12.0	4.0	N/A	6.30	N/A
M6 16 KH10MC Z50				16.0				
M6 20 KH10MC Z50				20.0				

NOTES:



UNLESS OTHERWISE SPECIFIED:  
DIMENSIONS ARE IN MM (MILLIMETERS).  
SURFACE FINISH:  
TOLERANCES: DIN 7991

MATERIAL:  
Steel

TITLE:  
Hex Socket Csk Head Cap Screw DIN 7991

	NAME	DATE
DRAWN	Darryl Wilson	25.01.16
CHK'D		
APPVD		

HEAT TREATMENT:  
Grade 10.9

DESIGN RIGHT. TR FASTENINGS LTD, 2003  
UNDER NO CIRCUMSTANCES MUST THIS  
DRAWING BE COPIED OR DISCLOSED  
WITHOUT FIRST OBTAINING WRITTEN  
AUTHORITY.

CUSTOMER PART NUMBER:  
N/A

FINISH:  
TC1D - Commercial Zinc/Clear Cr3  
De-Embrittled

DRAWING NUMBER:  
TR32KH10MCZ50

A4

PROJECTION

