

# CD43 TYPE DTAT SHEET

Dimensions (mm)

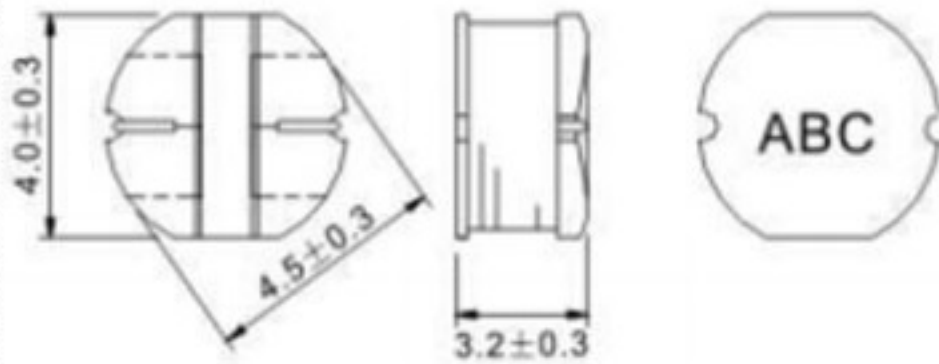

Land patterns (mm)

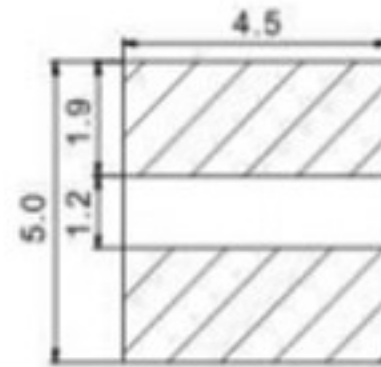

Construction



Model no.	Test condition	Inductance (μH)	Tolerance (%)	DC resistance MAX (Ω)	Rated current (A)
CD43-1R0	100KHZ, 0.3V	1.0	±20	0.033	3.80
CD43-2R2	100KHZ, 0.3V	2.2	±20	0.047	2.60
CD43-2R7	100KHZ, 0.3V	2.7	±20	0.052	2.43
CD43-3R3	100KHZ, 0.3V	3.3	±20	0.058	2.15
CD43-4R7	100KHZ, 0.3V	4.7	±20	0.094	1.70
CD43-6R8	100KHZ, 0.3V	6.8	±20	0.117	1.41
CD43-8R2	100KHZ, 0.3V	8.2	±20	0.132	1.26
CD43-100	1KHZ, 0.3V	100.0	±20	0.182	1.15
CD43-120	1KHZ, 0.3V	120.0	±20	0.21	1.05
CD43-150	1KHZ, 0.3V	150.0	±20	0.235	0.92
CD43-180	1KHZ, 0.3V	180.0	±20	0.338	0.84
CD43-220	1KHZ, 0.3V	22.0	±20	0.378	0.76
CD43-270	1KHZ, 0.3V	27.0	±20	0.522	0.71
CD43-330	1KHZ, 0.3V	33.0	±20	0.54	0.64
CD43-390	1KHZ, 0.3V	390.0	±20	0.587	0.59
CD43-470	1KHZ, 0.3V	470.0	±20	0.844	0.54
CD43-560	1KHZ, 0.3V	560.0	±20	0.937	0.5
CD43-680	1KHZ, 0.3V	680.0	±20	1.117	0.46
CD43-820	1KHZ, 0.3V	820.0	±20	1.180	0.43
CD43-101	1KHZ, 0.3V	100.0	±20	1.190	0.41
CD43-121	1KHZ, 0.3V	120.0	±20	1.220	0.38
CD43-151	1KHZ, 0.3V	150.0	±20	1.400	0.35
CD43-181	1KHZ, 0.3V	180.0	±20	1.500	0.31
CD43-221	1KHZ, 0.3V	220.0	±20	1.641	0.29
CD43-271	1KHZ, 0.3V	270.0	±20	2.890	0.26
CD43-331	1KHZ, 0.3V	330.0	±20	3.760	0.20