

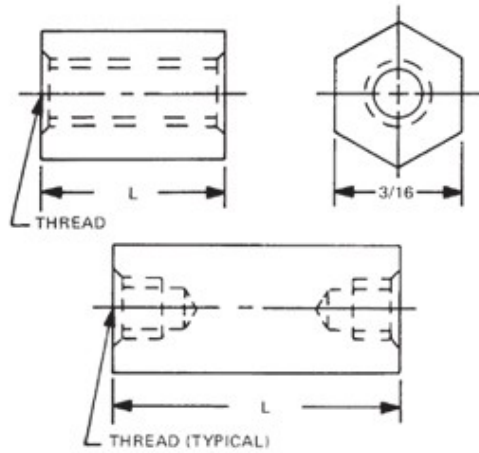

Home > [3/16 Hex Female Standoffs](#)

3/16 HEX FEMALE STANDOFFS



[Home](#) [Next](#)
[Related Metric](#)

xxxxx	xxx	xx	x
Length	Thread	Material	Finish

PART: 2060 440 SS 20

Red ?'s show missing selections. [Help](#)

- [Thread depth information](#)
- [Material Specifications](#)
- [Ordering non-standard items](#)
- [Request a Drawing](#)

Add to Cart

CALL NOW:
203 888-2133



Qty1 *

Qty2

Qty3

<input type="radio"/>	2058	19/32
<input type="radio"/>	2058T	19/32
<input type="radio"/>	2059	5/8
<input type="radio"/>	2059T	21/32

Thread *

Select	Code	Thread
<input type="radio"/>	256	2-56



<input checked="" type="radio"/>	2060	11/16
<input type="radio"/>	2060T	23/32
<input type="radio"/>	2061	3/4
<input type="radio"/>	2061T	25/32
<input type="radio"/>	2062	13/16
<input type="radio"/>	2062T	27/32
<input type="radio"/>	2063	7/8
<input type="radio"/>	2063T	29/32
<input type="radio"/>	2064	15/16
<input type="radio"/>	2064T	31/32

Select	Code	Thread
<input checked="" type="radio"/>	440	4-40

Material *

Select	Code	Material	RoHS
<input type="radio"/>	AL	Aluminum	YES
<input type="radio"/>	B	Brass	YES
<input checked="" type="radio"/>	SS	Stainless Steel	YES
<input type="radio"/>	S	Steel	YES
<input type="radio"/>	N	Nylon	YES

<input type="radio"/>	13-Bright dip - brass
<input type="radio"/>	14-Bright tin/copper flash
<input type="radio"/>	15-Hot tin dip*
<input type="radio"/>	16-Electro tin
<input type="radio"/>	19-Caustic etch
<input checked="" type="radio"/>	20-Passivation
<input type="radio"/>	21-Dark grey anodize
<input type="radio"/>	22-Clear anodize
<input type="radio"/>	23-Yellow green anodize
<input type="radio"/>	24-Black anodize
<input type="radio"/>	25-Black oxide brass
<input type="radio"/>	26-Black oxide SS
<input type="radio"/>	27-Electro tin solder 60/40*

