

PRODUCT DESCRIPTION CODE :

10131933-YXXXLF

PLATING :   
 ————— RoHS COMPATIBLE, SEE NOTE 3   
 ————— PACKAGING : "A" TAPE & REEL   
 "U" TUBE   
 ————— TOTAL NUMBER OF POSITIONS 04 TO 50

1 = 0.76 μm GOLD ON CONTACT AREA   
 2.00 μm MIN MATTE TIN ON TAIL

2 = 0.38 μm GOLD ON CONTACT AREA   
 2.00 μm MIN MATTE TIN ON TAIL

3 = 0.20 μm GOLD ON CONTACT AREA   
 2.00 μm MIN MATTE TIN ON TAIL

4 = 0.76 μm GXT ON CONTACT AREA   
 2.00 μm MIN MATTE TIN ON TAIL

5 = 0.38 μm GXT ON CONTACT AREA   
 2.00 μm MIN MATTE TIN ON TAIL

6 = 0.20 μm GXT ON CONTACT AREA   
 2.00 μm MIN MATTE TIN ON TAIL

9 = 2.54 μm MIN MATTE TIN ON CONTACT AREA   
 2.00 μm MIN MATTE TIN ON TAIL

1.27 μm NICKEL MIN UNDERLAYER

NOTES :

1 - MATERIAL   
 HOUSING : HIGH TEMPERATURE GLASS FILLED FLAME   
 RETARDANT PER UL 94 V-0   
 TERMINAL: COPPER ALLOY

2- TO DETERMINE DIMENSIONS :   
 N = NUMBER OF POSITIONS PER ROW   
 EXAMPLE : 8 POS N x 2 = 16mm   
 UP TO N = 24 TOLERANCE : 0   
 -0.10   
 FROM N = 26 TOLERANCE : 0.05   
 -0.10

3 - RoHS COMPATIBLE PRODUCT SPECIFICATIONS

a - PLATING :   
 "LF" MEANS THE PRODUCT IS LEAD-FREE, 2 μm MINIMUM MATTE   
 TIN OVER 1.27 μm MINIMUM NICKEL UNDERPLATE   
 b - MANUFACTURING PROCESS COMPATIBILITY   
 THE HOUSING WILL WITHSTAND EXPOSURE TO 260°C PEAK   
 TEMPERATURE FOR 30 SECONDS MAX IN A CONVECTION, INFRA-RED   
 OR VAPOR PHASE OR REFLOW OVEN

c - LABELLING :   
 MEETS PACKAGING SPECS AS PER GS-14-920   
 d - LEGAL STATEMENT : SEE GS-47-0004

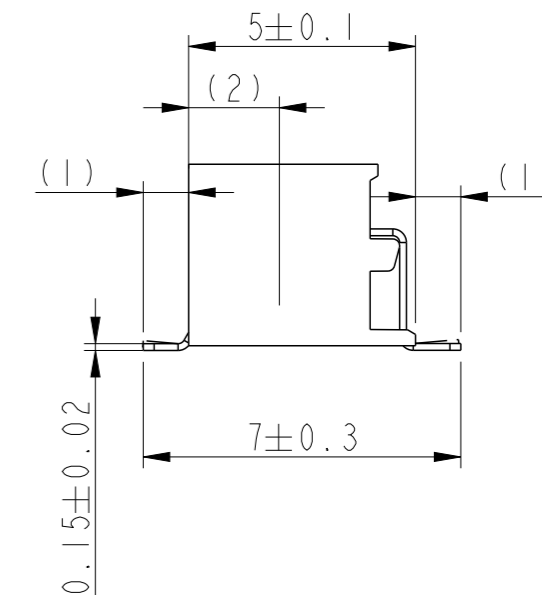
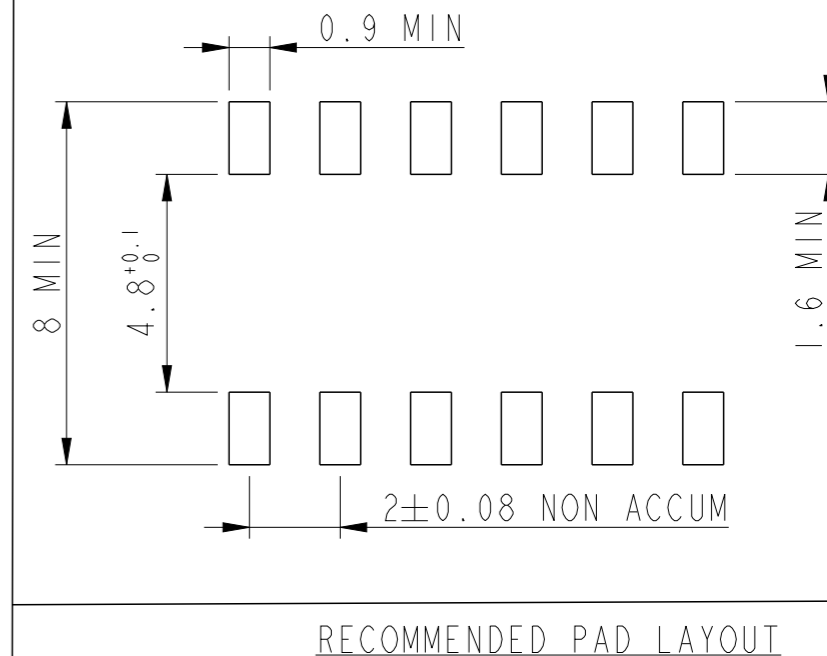
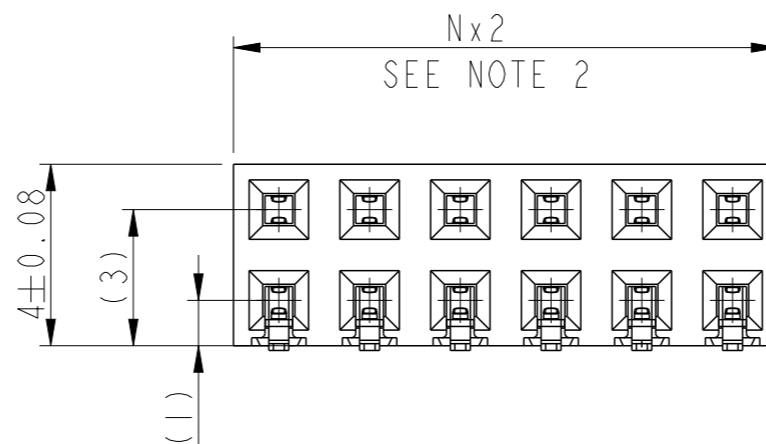
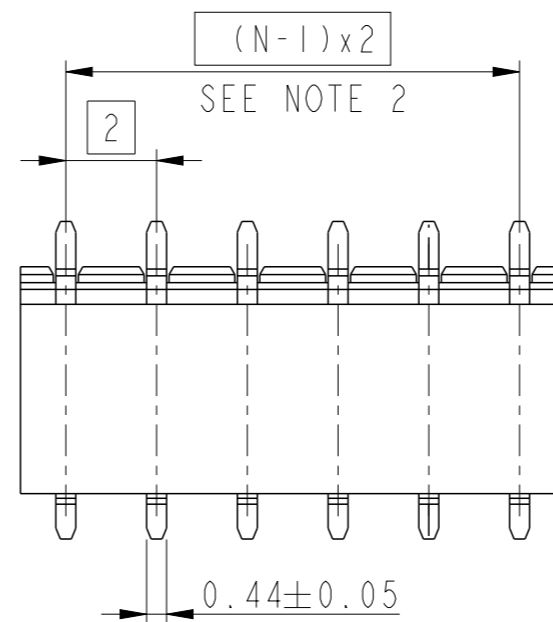

|                                       |                     |             |                |            |                        |    |                        |              |           |          |
|---------------------------------------|---------------------|-------------|----------------|------------|------------------------|----|------------------------|--------------|-----------|----------|
| spec ref                              | GS-12-1326          | dr          | Cyril Jeune    | 2014/12/02 | projection             | mm | size                   | A3           | scale     | 6:1      |
| tolerance std                         | ISO 406<br>ISO 1101 | eng         | Detouillon, Da | 2020/12/23 |                        |    | ecn no                 | -            | rel level | Released |
| TOLERANCES UNLESS OTHERWISE SPECIFIED |                     | chr         | -              | -          |                        |    |                        |              |           |          |
| surface                               | linear              | appr        | Wollin, Severi | 2020/12/21 | product family         | -  | rel level              | Released     |           |          |
| ISO 1302                              | angular             |             |                |            | MINITEK RECEPTACLE 2MM |    | dwg no                 | 10131933     | rev       | A        |
|                                       |                     |             |                |            | ASSEMBLY HCC DR SMT    |    |                        |              |           |          |
|                                       |                     | www.fci.com |                |            | cat. no.               | -  | Product - Customer Drw | sheet 1 of 1 |           |          |