

REMARK:  
 1. CHARACTERISTICS:  
 RATED VOLTAGE: 250V  
 RATED CURRENT: 2.5AMP  
 CONTACT RESISTANCE: 25mohms MAX (40mohms MAX FOR AFTER TEST).  
 INSULATION RESISTANCE: 5000Mohms MIN. at 500V DC  
 DIELECTRIC STRENGTH: 750VRMS  
 OPERATING TEMPERATURE RANGE: -55° C~105° C  
 INSERTION/EXTRACTION FORCE PER CONTACT: .5N Max./0.2N Min.  
 MATING/UNMATING CYCLES: 200MATINGS MIN FOR GOLD-FLASH  
 500MATINGS MIN FOR 30u" GOLD.

2. MATERIAL:  
 INSULATORS: THERMOPLASTIC G. F.(UL94V-0), BLACK  
 CONTACTS: COPPER ALLOY, GOLD(G/F or 30u")TOP OVER CONTACT AREA,  
 100u" Min MATTE TIN TOP OVER SOLDER AREA,  
 50u" Min NICKEL UNDER PLATE.  
 SHELL: CARBON STEEL, 100u" Min NICKEL TOP OVER,  
 50u" Min COPPER UNDER PLATE.  
 Z BRACKET: COPPER ALLOY, 100u" Min. MATTE TIN PLATED.  
 SCREW LOCK: COPPER ALLOY , 50u" Min NICKEL PLATED.

3. PART NUMBER DESCRIPTION:

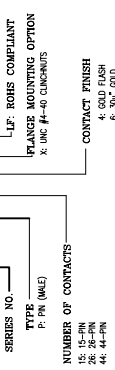

POS.	PART NO.	THREAD TYPE
15P	10090926-P15*XLF	UNC #4-40
26P	10090926-P26*XLF	UNC #4-40
44P	10090926-P44*XLF	UNC #4-40

POS.	A	B	C	D	H
15P	30.81	24.99	16.92	2.29	5.90±0.25
26P	39.24	33.32	25.25	2.29	5.90±0.25
44P	53.04	47.04	38.96	2.29	5.70±0.25

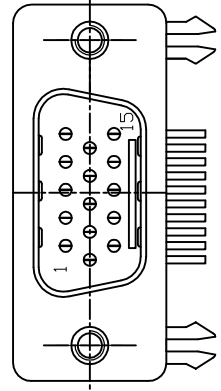
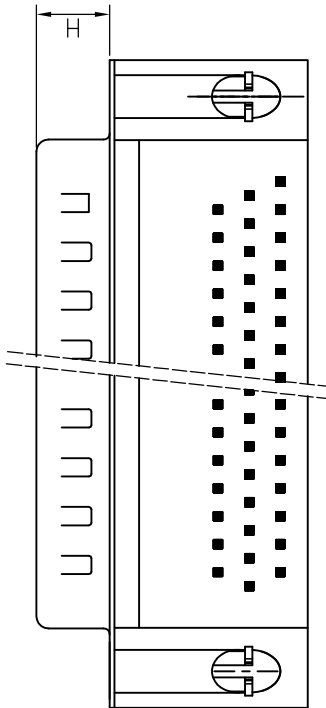
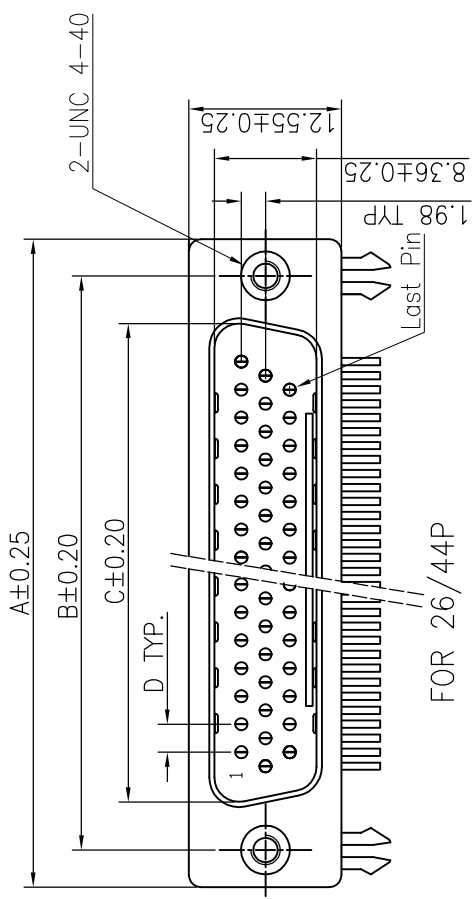
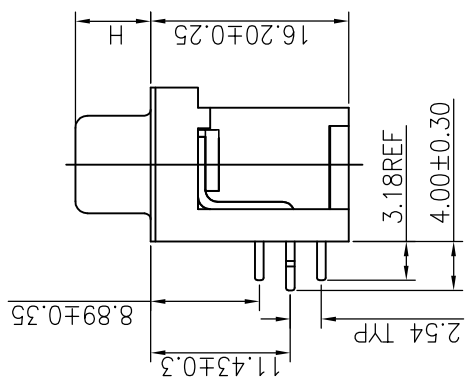

mat'l. code		surface	tolerance	projection	product family
ISO 1302	ISO 406 ISO 1000	ISO 1302	ISO 406 ISO 1000	projection	D-SUB
ISO 1302	ISO 406 ISO 1000	Tolerances unless otherwise specified	Tolerances unless otherwise specified	mm	
angles	linear	linear	linear	mm	
0°±2'	.00±0.25	.00±0.25	.00±0.25	scale 1:1	
df	MITHUN PAUL 2014/11/22	df	MITHUN PAUL 2014/11/22	dwg no	sheet 1 of 3 size
chr	GREGAR MATHW 2016/12/13	chr	GREGAR MATHW 2016/12/13	Product	Customer Drawing
appd	BIJU K PAUL 2016/12/13	appd	BIJU K PAUL 2016/12/13	type	Product Customer Drawing
revision	H H H	revision	H H H		
sheet	1 2 3	sheet	1 2 3		
index		index			

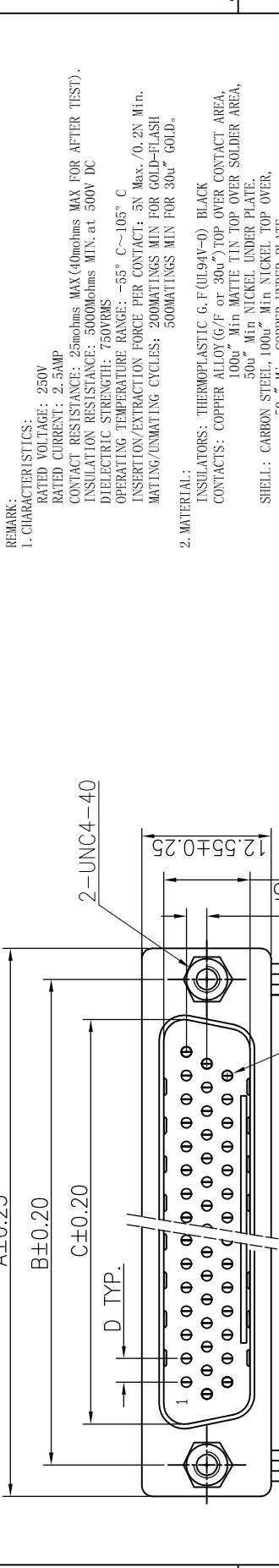

FOR 26/44P

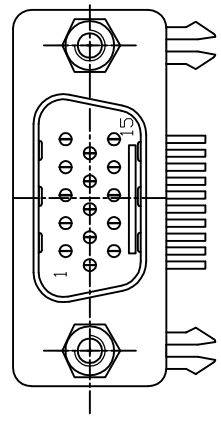
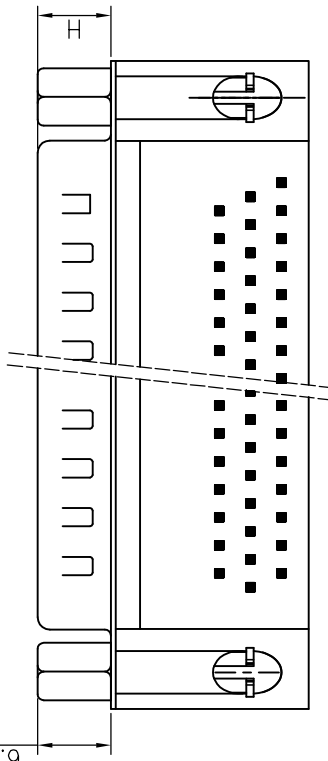

FOR 15P

REMARK:  
1. CHARACTERISTICS:  
RATED VOLTAGE: 250V  
RATED CURRENT: 2.5AMP  
CONTACT RESISTANCE: 25mohms MAX (40mohms MAX FOR AFTER TEST).  
INSULATION RESISTANCE: 5000Mohms MIN. at 500V DC  
DIELECTRIC STRENGTH: 750VRMS  
OPERATING TEMPERATURE RANGE: -55° C~105° C  
INSERTION/EXTRACTION FORCE PER CONTACT: 5N Max./0.2N Min.  
MATING/UNMATING CYCLES: 200MATINGS MIN FOR GOLD-FLASH  
500MATINGS MIN FOR 30u" GOLD.

2. MATERIAL:  
INSULATORS: THERMOPLASTIC G. F.(UL94V-0) BLACK  
CONTACTS: COPPER ALLOY (G/P or 30u") TOP OVER CONTACT AREA,  
100u" Min MATTE TIN TOP OVER SOLDER AREA,  
50u" Min NICKEL UNDER PLATE.  
SHELL: CARBON STEEL, 100u" Min NICKEL TOP OVER,  
50u" Min COPPER UNDER PLATE.  
Z BRACKET: COPPER ALLOY, 100u" Min MATTE TIN PLATED.  
SCREW LOCK: COPPER ALLOY, 50u" Min NICKEL PLATED.  
NUT: COPPER ALLOY, 50u" Min NICKEL PLATED.  
3. PART NUMBER DESCRIPTION:

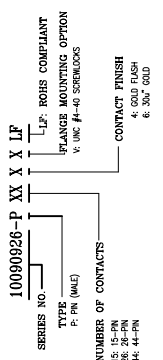

POS.	PART NO.	A	B	C	D	H
15P	10090926-P15*VLF	30.81	24.99	16.92	2.29	5.90±0.25
26P	10090926-P26*VLF	39.24	33.32	25.25	2.29	5.90±0.25
44P	10090926-P44*VLF	53.04	47.04	38.96	2.29	5.90±0.25

mat'l. code		surface	tolerance	projection	product family
ISO 1302	ISO 406	ISO 1000	ISO 1000	D-SUB	
tr	ecn no	dr	date	tolerances unless otherwise specified	title
H	ED-25672	GREGAR	2016/12/13	.0±0.38	H/D D-SUB MALE RIGHT ANGLE
				angles linear	dwg no
				0°±2'	sheet 2 of 3 size
				dr	A4
				edr	10090926
				chr	Product Customer Drawing
				appr	
sheet	revision	H	H	scale	
index	sheet	1	2	1:1	
		3			
		4			

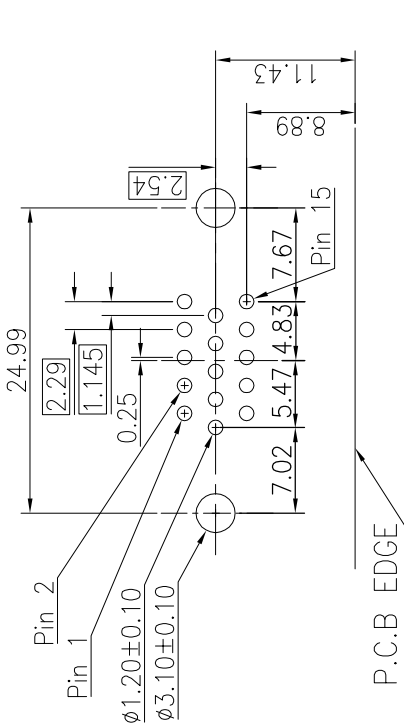

P.C.B LAYOUT (FOR 15P)

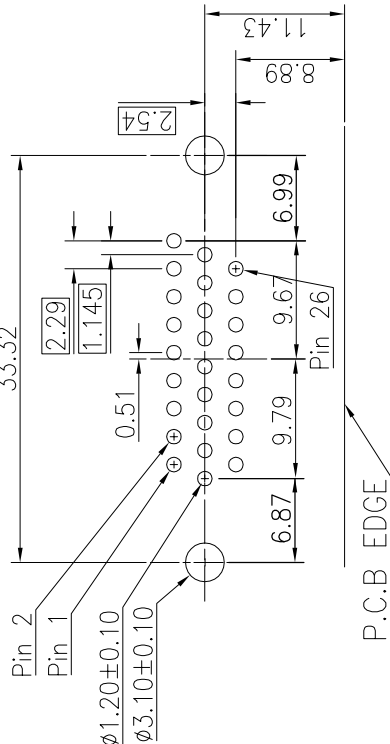

P.C.B LAYOUT (FOR 26P)

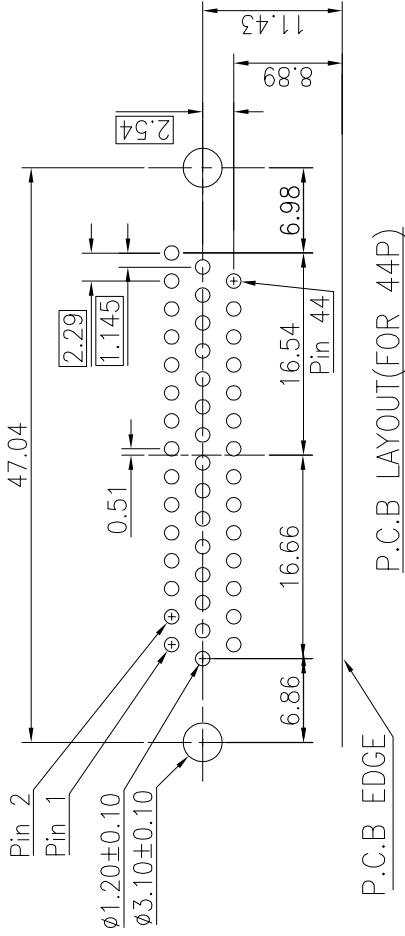

P.C.B LAYOUT (FOR 44P)

mat'l. code	surface	tolerance	projection	product family
	ISO 1302	ISO 406 ISO 1001		D-SUB
ltr	ec'n no	date	title	
H	ED-25612 (REGAR)	2016/12/13	H/D D-SUB MALE RIGHT ANGLE	
	angles	linear	mm	
		.0±0.38		
	0°±2'	.00±0.25	scale	1:1
	dr	MITHUN PAUL 2014/11/22	dwg no	sheet 3 of 3 size
	chr	REGAR MATHW 2016/12/13	Amphenol	A4
	app'd	BIJU K PAUL 2016/12/13	FCI	Product Customer Drawing
sheet index	revision	H H		
	sheet	1 2 3		