



## PCFTR50-XL

### Flanged housing unit

Schaeffler ID:  
0008318400000

Housing units PCFTR, three-bolt flanged housing units, cast iron, eccentric locking collar, P seals

X-life

## Technical information

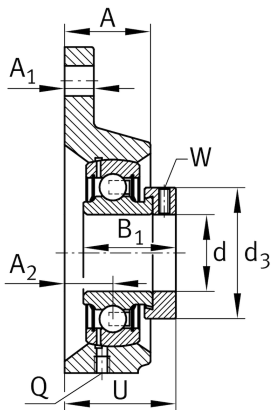
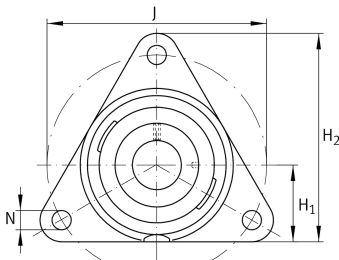

### Main Dimensions & Performance Data

d	50 mm	Bore diameter
H <sub>2</sub>	150 mm	Height flange
U	51.9 mm	Total height unit
C <sub>r</sub>	35,000 N	Basic dynamic load rating, radial
C <sub>0r</sub>	23,200 N	Basic static load rating, radial
	2.03 kg	Weight

### Mounting dimensions

J	160 mm	Pitch circle diameter (holes)
N	14 mm	Fixing bore
n	3	Number of screwing holes

### Dimensions

A <sub>1</sub>	16 mm	Thickness of flange
A <sub>2</sub>	19.2 mm	Distance raceway
H <sub>1</sub>	55 mm	Distance shaft axis
Q	M6	Connection thread lubrication
d <sub>3</sub>	69 mm	Outside diameter eccentric locking collar

### Additional information

GRAE50-XL-NPP-B	Bearing designation
-----------------	---------------------