

PRODUCT NUMBER	NO. OF POS	DIM K	DIM J	DIM C	DIM W DIM Z
78211-003	LF 3	7.47	5.08	1.35	0.05
78211-004	LF 4	10.01	7.62	1.35	0.05
78211-005	LF 5	12.55	10.16	1.35	0.05
78211-006	LF 6	15.09	12.70	1.35	0.10
78211-007	LF 7	17.63	15.24	1.35	0.10
78211-008	LF 8	20.17	17.78	1.35	0.10
78211-009	LF 9	22.71	20.32	1.35	0.10
78211-010	LF 10	25.25	22.86	1.35	0.10
78211-011	LF 11	27.79	25.40	1.35	0.15
78211-012	LF 12	30.33	27.94	1.35	0.15
78211-013	LF 13	32.87	30.48	1.35	0.15
78211-014	LF 14	35.41	33.02	1.35	0.15
78211-015	LF 15	37.95	35.56	1.35	0.15
78211-103	LF 3	7.47	5.08	2.54	0.05
78211-105	LF 5	12.55	10.16	2.54	0.05
78211-106	LF 6	15.09	12.70	2.54	0.10

NOTES:

- MOLDING MATERIAL : MODIFIED POLYPHELYNYENE
COLOR BLACK; UL 94 V0
- LATCH MUST WITHSTAND 18N MIN PULL OUT FORCE
- STANDARD PACKAGING IN POLYBAGS
- TERMINALS MUST BE CRIMPED PROPERLY FOR SATISFACTORY LATCHING :
 - FOR CRIMPING INSTRUCTIONS, SEE TA-75 AND TA-295
 - FOR TERMINAL APPLICATION SEE TA-531.
- THIS HOUSING IS INTENDED FOR USE WITH MINI PV TERMINAL WITH 22-36 GAUGE WIRE
- ROHS COMPLIANT PRODUCT SPECIFICATIONS :
 - MEETS PACKAGING SPECS AS PER GS-14-920
 - PRODUCT MEETS EUROPEAN UNION DIRECTIVES AND OTHER COUNTRY REGULATIONS AS DESCRIBED IN GS-22-008.
 - THE PRODUCT IS NOT INTENDED TO BE EXPOSED TO A MANUFACTURING SOLDER PROCESS.

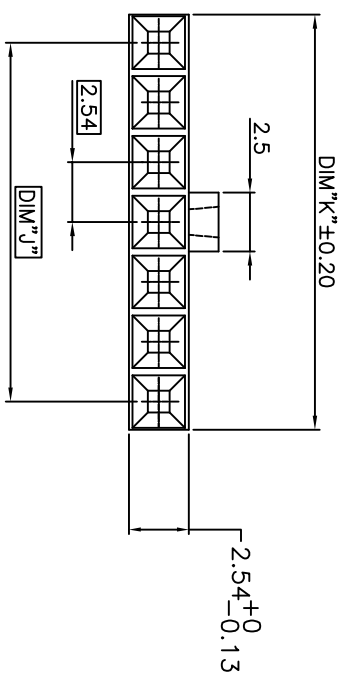
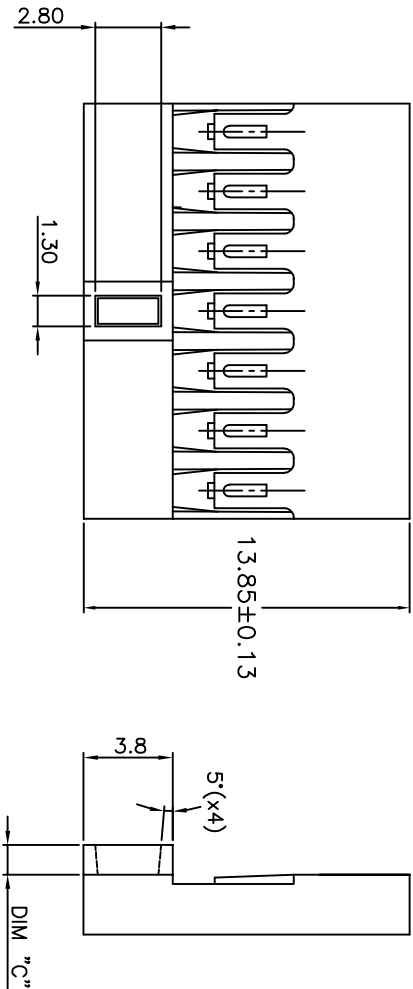

mat'l. code	10036738	surface	ISO 1302	tolerance	ISO 406	ISO 1101	projection	product family	BERGCON
lfr	ecn no	dr	date	tolerances unless otherwise specified	linear	angular	mm	title	MINI LATCH
K	W7-0533	HTB	07.08.21		.XX	±0.13		HOUSING SR POLARIZED	
L	B-14321	LMU	13.03.21		.XXX	±0.05	scale 5:1	dwg no	78211
M	F-30075	DDE	18.05.03					sheet 1 of 1	A3
		dr	LMULN					size	
		eng	LMULN					type	CUSTOMER Drawing
		chr	JCOMPANION						
		app	LMU						
sheet index	revision	sheet							