

PRODUCT NR	PCB THICKNESS
70292-101LF	1.6 & 2.4

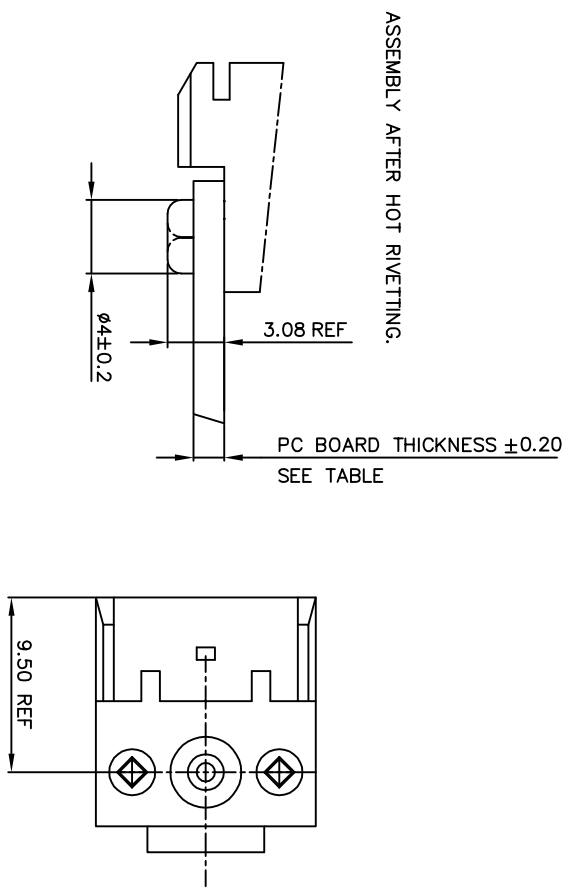
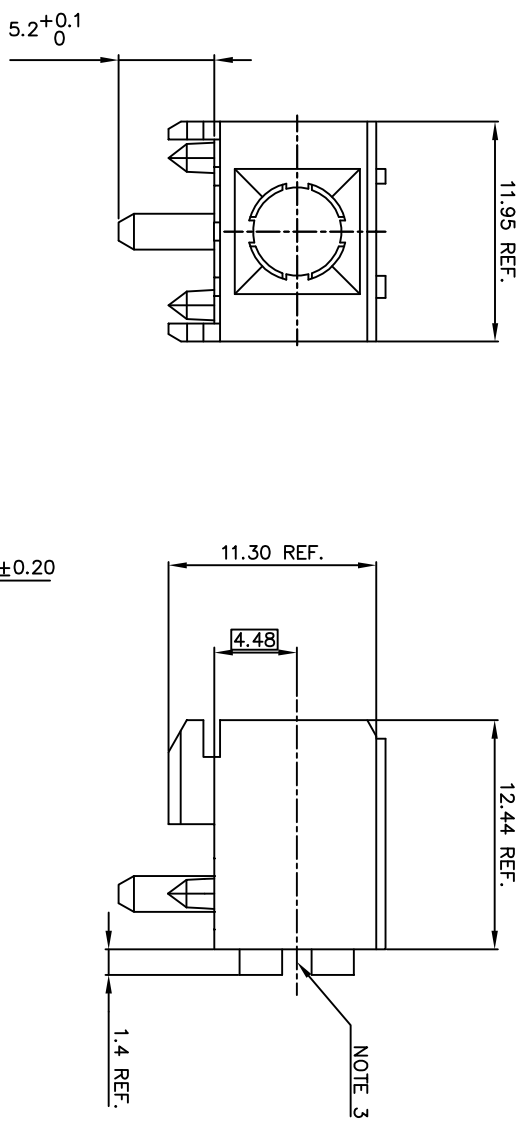

ASSEMBLY AFTER HOT RIVETTING.

NOTE:

- 1 INDICATED HOLES ARE UNPLATED.
- 2 MATERIAL: LIQUID CRYSTAL POLYMER 30% GLASS, FLAME RETARDANT ACC. UL 94-V0 COLOR NATURAL.
- 3 SLOT OPTIONAL
- 4 THIS PRODUCT WITH "LF" SUFFIX MEETS EUROPEAN UNIDIRECTIVES AND OTHER COUNTRY REGULATIONS AS DESCRIBED IN GS -22-008.
- 5 THE HOUSING WILL WITHSTAND EXPOSURE TO 260 DEGREE PEAK TEMPERATURE FOR 10 SECONDS IN A WAVE SOLDER APPLICATION WITH A 1.6mm MINIMUM THICK CIRCUIT BOARD.

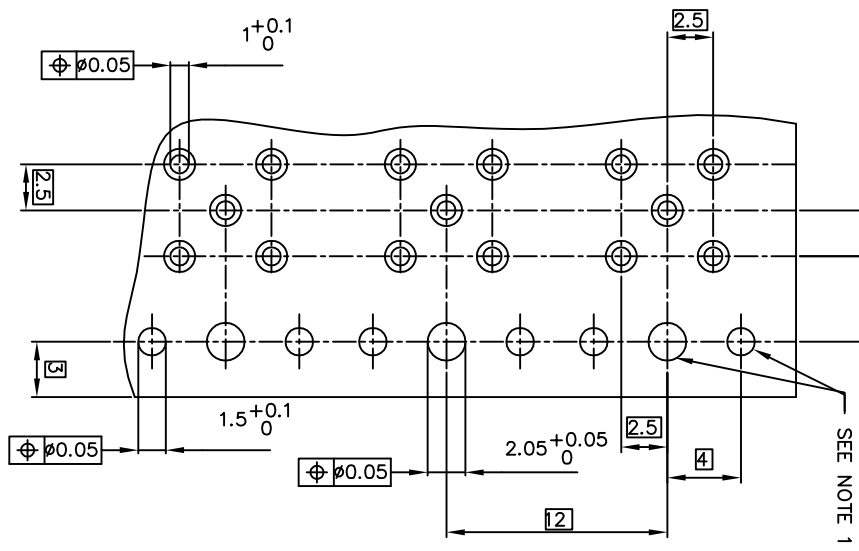

RECOMMENDED HOLE PATTERN,
COMPONENT SIDE.

matl. code	SEE NOTE 2	tolerances unless otherwise specified	CUSTOMER COPY	FCI ELECTRONICS
titr. eqn. no./dr. code	9002-0957/04/050927	linear	projection	www.fci.com
H	9002-0957/04/050927	linear	1st angle	R/A HOUSING
C	H20049	SEE 920609	angles	RECEPTACLE COAX
D	H20070	DAN 920911	dr.	Product form (METRAL) code
E	H50683	RM 951102	eng.	size/dwg no
F	H90490	HME 990816	chr.	70292
G	V00295	LJA 000217	A.v.Zorn	code
sheet	revision	H	scale	213
1	1	1	5:1	1 of 1

PDM: Rev: H 61 STATUS: Released

Printed: May 19, 2011