

| P | LTR | DESCRIPTION | DATE | DWN | APVD |
|---|-----|-----------------------------|-------------|-----|------|
| | E1 | 6 POS PART 1-282845-4 ADDED | 29 JUN 2020 | SS | PS |
| | | | | | |
| | | | | | |

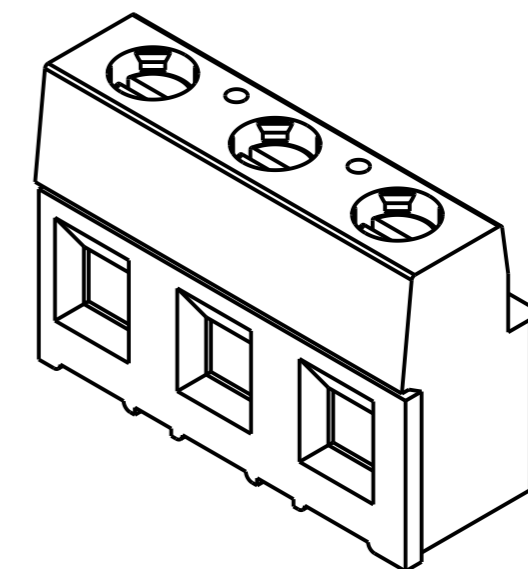

282845-3 AS SHOWN

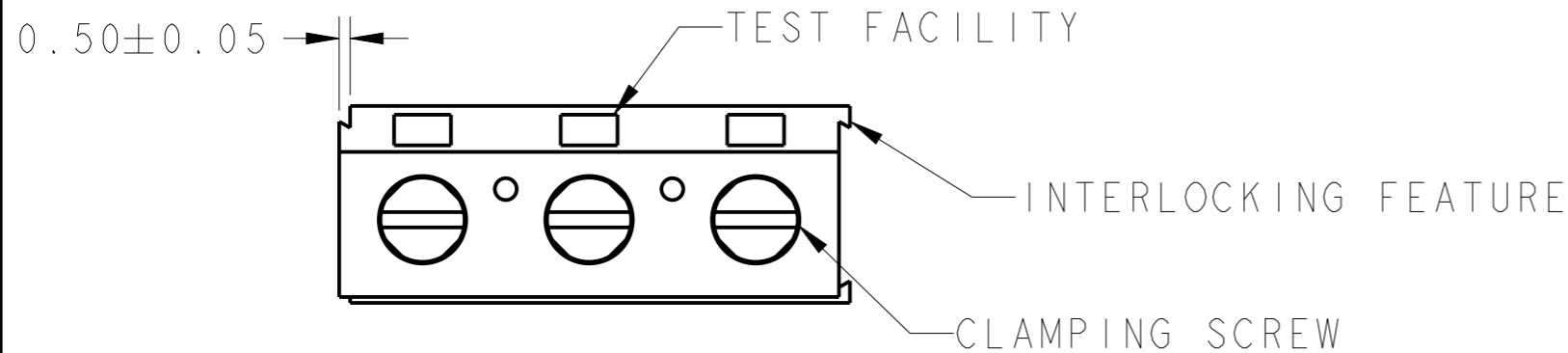
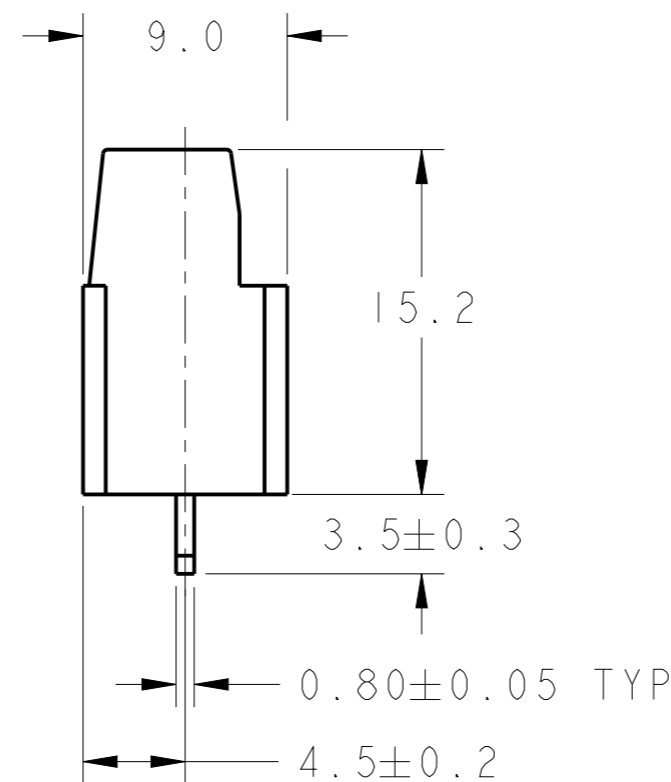
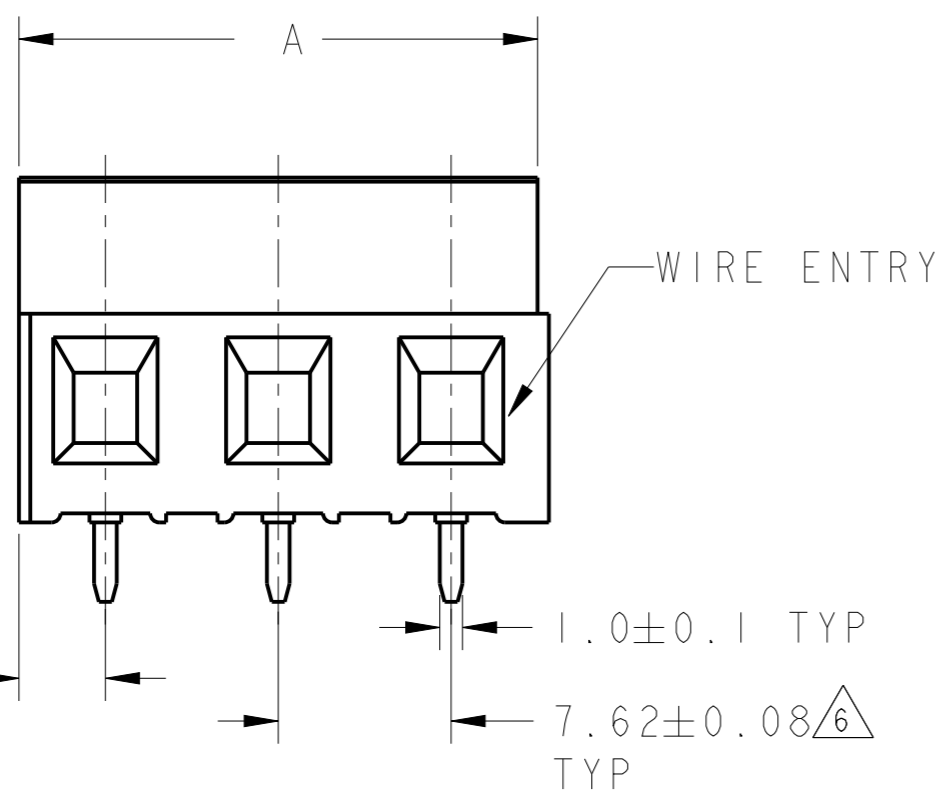

| | | | | |
|---------|-------------|-------|-----|---------------|
| - | 45.72 | 6 | △9 | 1-282845-4 |
| △7 | SEE SHEET 2 | 22.86 | 3 | 1-282845-3 |
| △7 | SEE SHEET 2 | 68.58 | 9 | △8 1-282845-2 |
| △7 | SEE SHEET 2 | 22.86 | 3 | 1-282845-1 |
| △7 | SEE SHEET 2 | 15.24 | 2 | 1-282845-0 |
| △7 | SEE SHEET 2 | 15.24 | 2 | 282845-9 |
| △7 | SEE SHEET 2 | 22.86 | 3 | 282845-8 |
| △7 | SEE SHEET 2 | 15.24 | 2 | 282845-7 |
| △7 | SEE SHEET 2 | 15.24 | 2 | 282845-6 |
| △7 | SEE SHEET 2 | 22.86 | 3 | 282845-5 |
| - | 22.86 | 3 | | 282845-3 |
| - | 15.24 | 2 | | 282845-2 |
| MARKING | | DIM A | POS | PART NUMBER |

RECOMMENDED PC BOARD LAYOUT

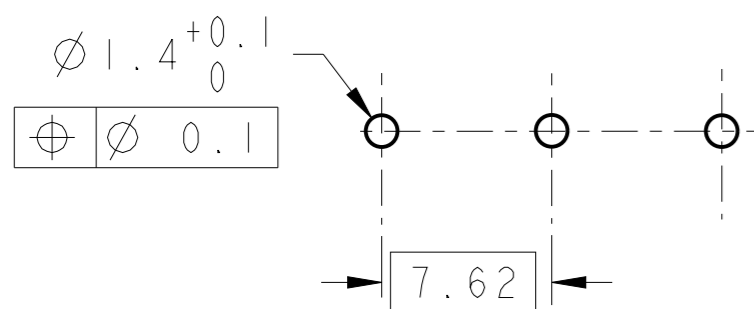

| | | | | |
|--|--|-----------------------------------|--|--------------------|
| THIS DRAWING IS A CONTROLLED DOCUMENT. | | DWN E. ZANOLINI 16AUG2001 | TE Connectivity | |
| DIMENSIONS: mm | | CHK D. BIEVENOUR 16AUG2001 | | |
| TOLERANCES UNLESS OTHERWISE SPECIFIED: | | APVD D. BIEVENOUR 16AUG2001 | NAME TERMINAL BLOCK PCB MOUNT SIDE WIRE ENTRY, STACKING W/INTERLOCK, 7.62mm PITCH | |
| 0 PLC ±- 1 PLC ±.3 2 PLC ±.25 3 PLC ±- 4 PLC ±- ANGLES ±° | | PRODUCT SPEC | RESTRICTED TO | |
| MATERIAL | | APPLICATION SPEC 114-20079 | SIZE A3 | CAGE CODE 00779 |
| FINISH | | WEIGHT - | DRAWING NO C-282845 | |
| | | CUSTOMER DRAWING | SCALE 3:1 | SHEET 1 OF 2 |
| | | | | REV E1 |

| P | LTR | DESCRIPTION | DATE | DWN | APVD |
|---|-----|-------------|------|-----|------|
| - | | SEE SHEET 1 | - | - | - |
| | | | | | |
| | | | | | |

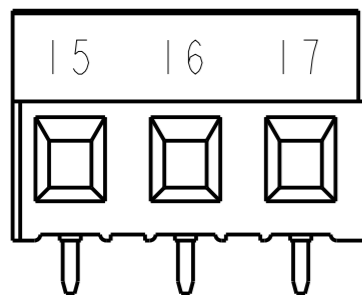

P/N 282845-5 AS SHOWN

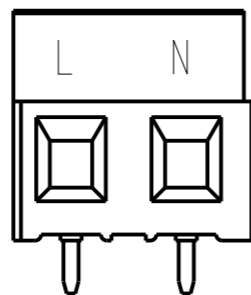

P/N 282845-6 AS SHOWN

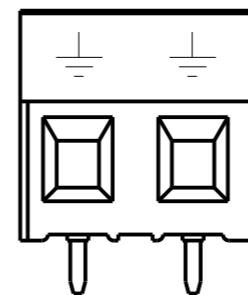

P/N 282845-7 AS SHOWN

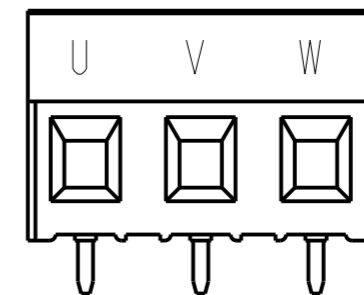

P/N 282845-8 AS SHOWN

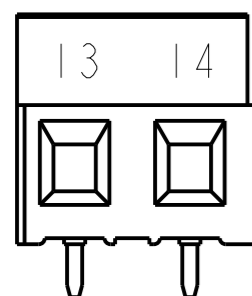

P/N 282845-9 AS SHOWN

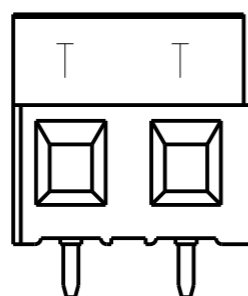

P/N 1-282845-0 AS SHOWN

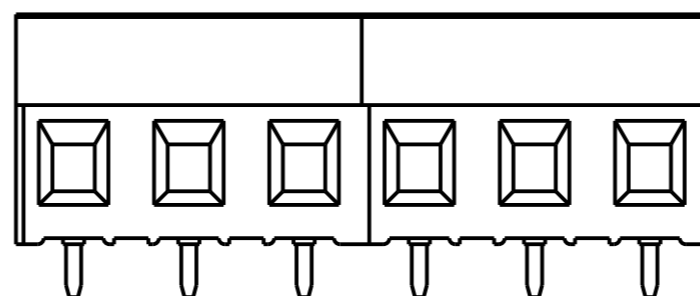

P/N 1-282845-4 AS SHOWN

1. MATERIALS AND FINISH
 HOUSING: PA 6-6, UL 94-V0, COLOR GREEN.
 CLAMP: BRASS, NICKEL PLATED.
 TERMINAL: BRASS, TIN PLATED.
 CLAMPING SCREW: M3, BRASS, NICKEL PLATED

- 2. SUITABLE FOR 1,6-2,4mm. PCB THICKNESS.
- 3. END-TO-END STACKABLE W/INTERLOCK WITHOUT LOSS OF CENTERLINE SPACING.
- 4. WIRE SIZE RANGE : 30-12 AWG
- 5. RECOGNIZED UNDER THE COMPONENT PROGRAM OF UNDERWRITERS LABORATORIES INC. FILE NO E60677.

- 6. NOT CUMULATIVE TOLERANCE.
- 7. INK MARKING, BLACK COLOR
- 8. P/N 1-282845-2 IS OBTAINED BY GLUING AND ASSEMBLING TOGETHER No.1 CONNECTOR P/N 282845-6, No.1 CONNECTOR P/N 282845-7, No.1 CONNECTOR P/N 282845-8 AND No.1 CONNECTOR P/N 1-282845-0
- 9. P/N 1-282845-4 IS OBTAINED BY INTERLOCKING 2 NO.OF CONNECTOR P/N 282845-3.

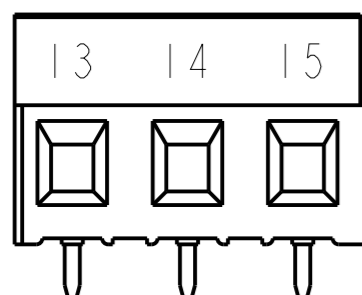

P/N 1-282845-1 AS SHOWN

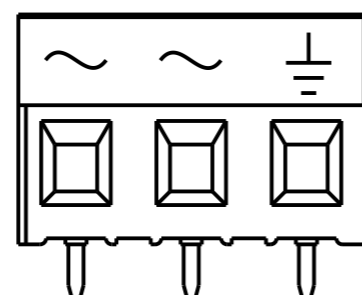

P/N 1-282845-3 AS SHOWN

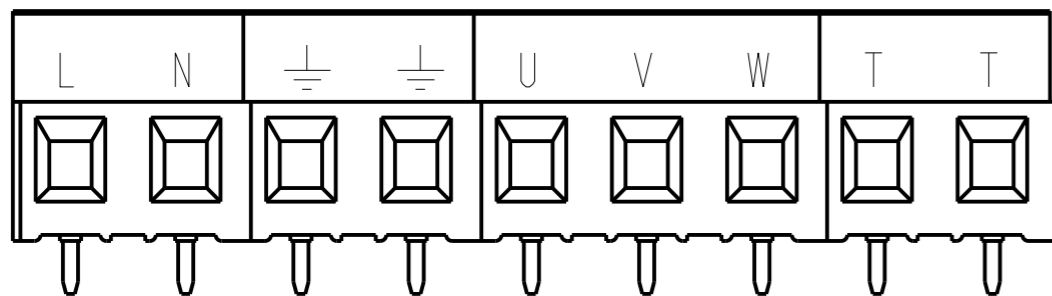

P/N 1-282845-2 AS SHOWN

THIS DRAWING IS A CONTROLLED DOCUMENT.

| DIMENSIONS: | TOLERANCES UNLESS OTHERWISE SPECIFIED: |
|-------------|--|
| mm | |
| 0 PLC | ±0 |
| 1 PLC | ±.3 |
| 2 PLC | ±.25 |
| 3 PLC | ±0 |
| 4 PLC | ±0 |
| ANGLES | ±2° |

| MATERIAL | FINISH |
|----------|--------|
| 1 | 1 |

| | |
|------------------|-----------|
| DWN | 16AUG2001 |
| E. ZANOLINI | |
| CHK | 16AUG2001 |
| D. BIEVENOUR | |
| APVD | 16AUG2001 |
| D. BIEVENOUR | |
| PRODUCT SPEC | 108-20166 |
| APPLICATION SPEC | 114-20079 |
| WEIGHT | - |

| | | | |
|--|-----------|------------|---------------|
| TE TE Connectivity | | | |
| NAME TERMINAL BLOCK PCB MOUNT SIDE WIRE ENTRY, STACKING W/INTERLOCK, 7.62mm PITCH | | | |
| SIZE | CAGE CODE | DRAWING NO | RESTRICTED TO |
| A3 | 00779 | C=282845 | - |
| CUSTOMER DRAWING | | SCALE | SHEET |
| | | 2:1 | 2 OF 2 |
| | | | REV E1 |

Mouser Electronics

Authorized Distributor

Click to View Pricing, Inventory, Delivery & Lifecycle Information:

[TE Connectivity:](#)

[282845-2](#)