

M 25 device connector, standard

Female connector

Correct positioning guaranteed due to flattened thread. Fastening with screws from outside.

Crimp contacts separately available under Accessories

See the Technical Data for insulation strip lengths.

For spacer rings for unlocking at the device connector, see Accessories.

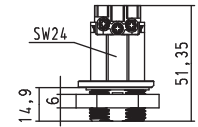
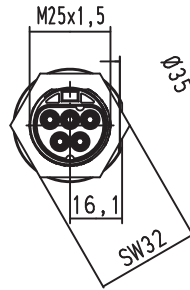

Application Coding Color

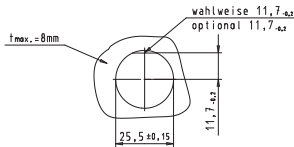

Power 250V/400V		⊕, N, 3, 2, 1	gray black
Power 250V + dimming		L, ⊕, N, D1, D2	turquoise
Switch.func. 250 V		1, 2, 3, 4, 5	blue
50V, LV, bus signals		1, 2, 3, 4, 5	brown

Part No.

with screw connection	
Wire	mm ²
rigid	
fine-stranded	0.75 – 4.0
stranded	without ferrules
Term. poles	1
Thread	M25 x 1.5
Gland	outside

96.051.5053.0	
96.051.5053.1	
96.051.5053.6	
96.051.5053.9	
96.051.5051.4	

Part No.

with crimp connection (see Accessories)	
Wire	mm ²
rigid	
fine-stranded	0.75 – 4.0
stranded	
Term. poles	1
Thread	M25 x 1.5
Gland	outside

96.151.1053.0	
96.151.1053.1	
96.151.1053.6	
96.151.1053.9	
96.151.1051.4	

Male connector

Correct positioning guaranteed due to flattened thread. With locking device. Fastening with screws from outside.

Crimp contacts separately available under Accessories

See the Technical Data for insulation strip lengths.

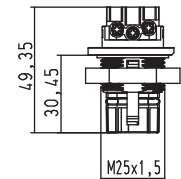
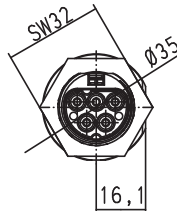

Application Coding Color

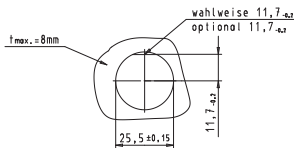

Power 250V/400V		⊕, N, 3, 2, 1	gray black
Power 250V + dimming		L, ⊕, N, D1, D2	turquoise
Switch.func. 250 V		1, 2, 3, 4, 5	blue
50V, LV, bus signals		1, 2, 3, 4, 5	brown

Part No.

with screw connection	
Wire	mm ²
rigid	
fine-stranded	0.75 – 4.0
stranded	without ferrules
Term. poles	1
Thread	M25 x 1.5
Gland	outside
Locking device	yes

96.052.5053.0	
96.052.5053.1	
96.052.5053.6	
96.052.5053.9	
96.052.5051.4	

Part No.

with crimp connection (see Accessories)	
Wire	mm ²
rigid	
fine-stranded	0.75 – 4.0
stranded	
Term. poles	1
Thread	M25 x 1.5
Gland	outside
Locking device	yes

96.152.1053.0	
96.152.1053.1	
96.152.1053.6	
96.152.1053.9	
96.152.1051.4	