

| SYMBOL DEFINITION  |               | TOTAL NO OF INSPECTIONS REQUIRED | NO MISSING SYMBOL NUMBER |
|--|---------------|----------------------------------|--------------------------|
| A DIMENSION WITHOUT AN INSPECTION REPORT SYMBOL DOES NOT REQUIRE INSPECTION. IT MAY BE CONTROLLED ON THE INDIVIDUAL COMPONENT DRAWING. |               | 8                                |                          |
|  | LAST NO. USED | 8                                |                          |

| MISSING SYMBOLS |     |     |     |     | REVISION HISTORY |  |  | AUTH | DR     | AP/VD   |     |
|-----------------|-----|-----|-----|-----|------------------|--|--|------|--------|---------|-----|
| DATE            | STG | REV | N/P | CHG | ZONE             |  |  |      |        |         |     |
| 11JL01          | R   | 01  | -   | -   |                  | ALL ACTIVE PARTS - REVISED GRAPHICS  |  |      | 211315 | RVP/RVP | JH  |
| 17JL03          | R   | 02  | -   | -   |                  | 12020156 - PER ECN 211315 REV LEVEL L2 SHOULD BE K1, CORRECT REV LEVEL TO K2 |  |      | 243603 | JYD/JYD | JH  |
| 01AU06          | R   | 03  | -   | -   |                  | 12020156, 12033997 & 12066614 - MAT'L SPEC WAS P1519030                      |  |      | 283052 | MDH/JAA | MKM |

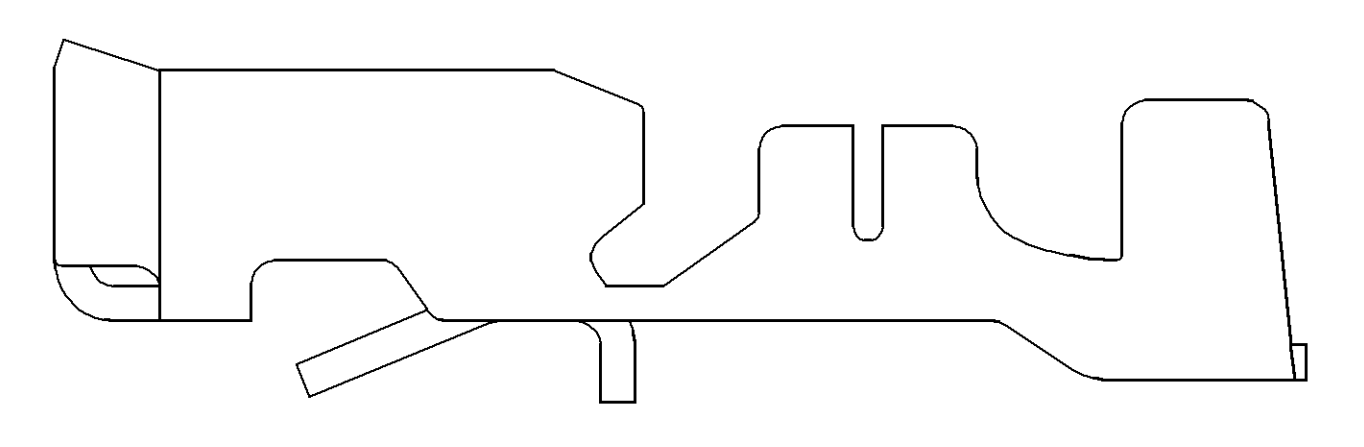

TYPE 102  
SAME AS TYPE 101  
EXCEPT AS SHOWN

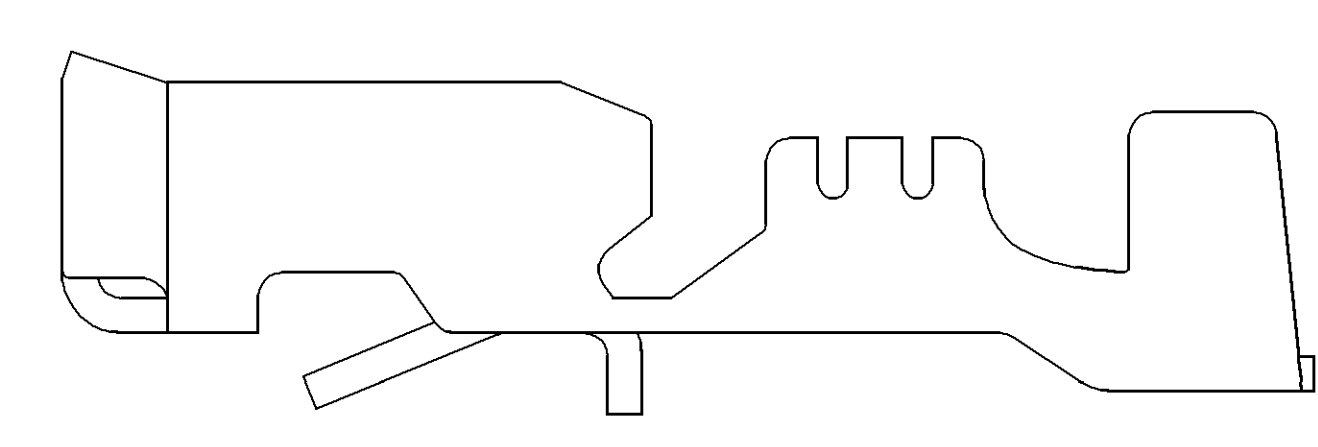

TYPE 103  
SAME AS TYPE 101  
EXCEPT AS SHOWN

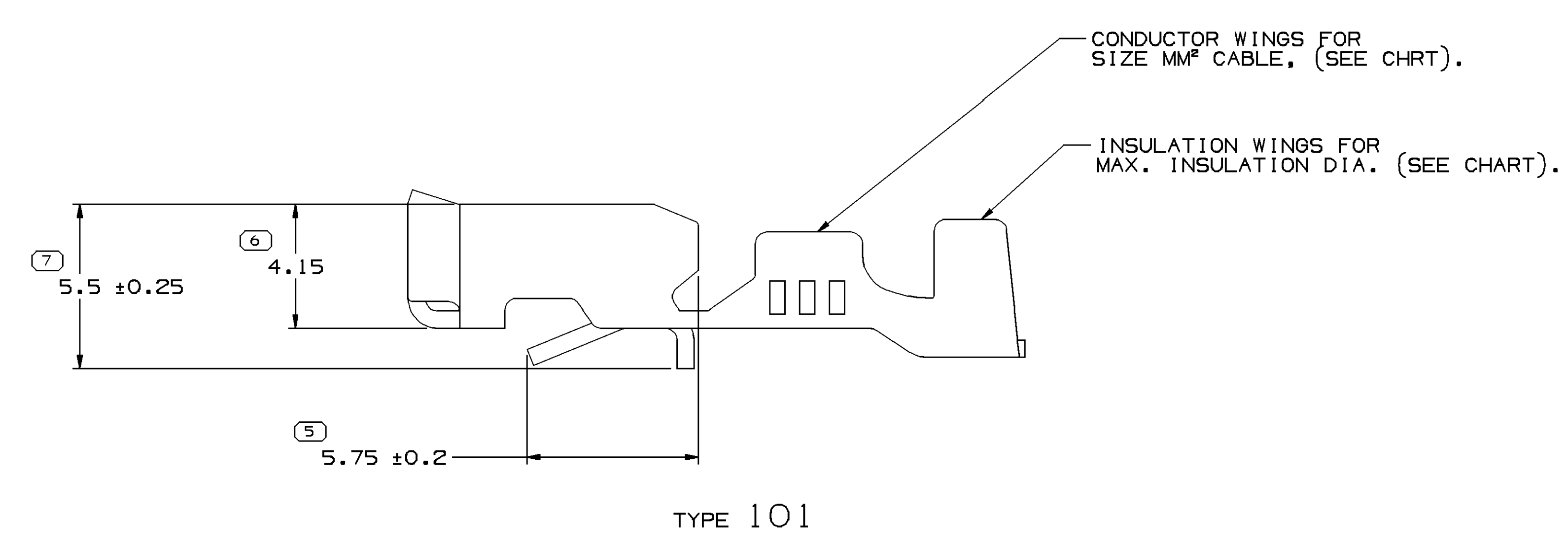
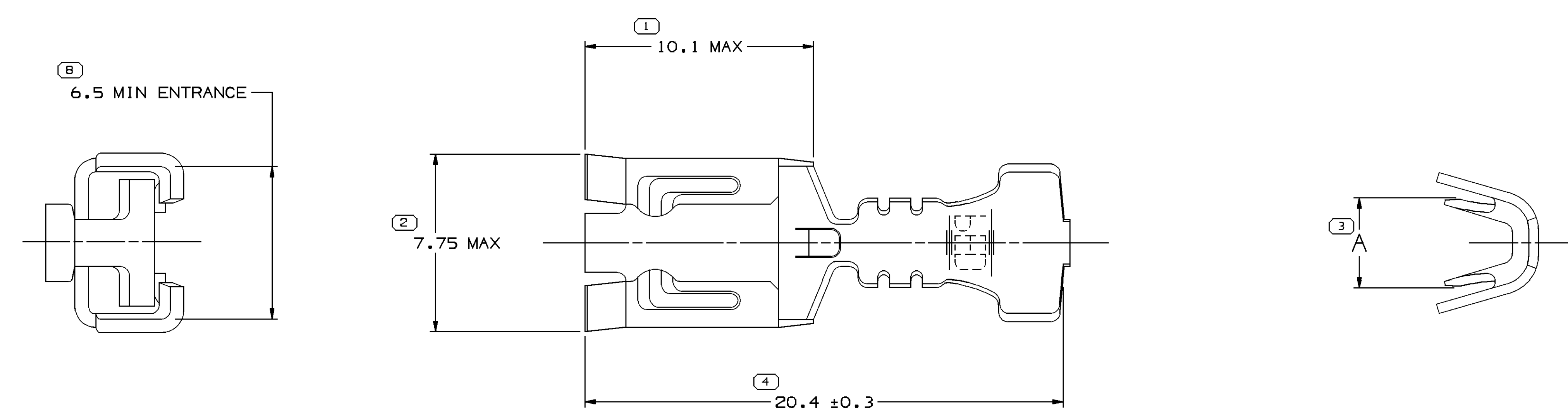

TYPE 101

NOTES

- UNLESS OTHERWISE SPECIFIED AND/OR INDICATED:  
DIMENSIONS ARE TO FACE OF VIEW SHOWN AND AUTOMATICALLY ROUNDED BY COMPUTER FOR INSPECTION (SEE MATH MODEL FOR PRECISE DIMENSIONS). FOR ALL OTHER DIMENSIONS NOT SHOWN BUT REQUIRED FOR TOOL BUILD, SEE MATH MODEL FOR PRECISE TOOL PATH DATA.
- RECOMMENDED MATING BLADES - (1) METRI-PACK (0.86/0.79 THK. X 6.38/6.22 WIDE)  
(2) AUTOFUSE (0.69/0.61 THK X 5.355/5.11 WIDE)
- THIS PART FOR DIAGNOSTIC INDUSTRY APPLICATIONS.

| PART NO  | REV | N/P | STATUS   | MAT'L SIZE    | MAT'L SPEC                  | PART NO  | REV | N/P | STATUS   | MAT'L SIZE    | MAT'L SPEC                                 | PLATED | SIZE (MM <sup>2</sup> ) | ID | DIA       | TYPE    |
|----------|-----|-----|----------|---------------|-----------------------------|----------|-----|-----|----------|---------------|--|--------|-------------------------|----|-----------|---------|
| 12066506 | A   | -   | OBSOLETE | 0.406 X 35.71 | S1519030 TIN BRS EX HD SLIT | 12176854 | A2  | -   |          | 0.406 X 35.71 | PM003658-030 17410 BE CU 1/2 HT A6/N1 PLTD |        | 5 - 3                   | 11 | 4.48-2.74 | 102 4.6 |
| 12066505 | B   | -   | OBSOLETE | 0.406 X 35.71 | S1519030 TIN BRS EX HD SLIT | 12020156 | K3  | -   |          | 0.406 X 35.71 | M1574030 NONFERROUS C42500 EX HD           |        | 0.8 - 0.5               | 19 | 3.13-1.87 | 103 3.2 |
| 12066504 | B   | -   | OBSOLETE | 0.406 X 35.71 | S1519030 TIN BRS EX HD SLIT | 12066614 | A2  | -   |          | 0.406 X 35.71 | M1574030 NONFERROUS C42500 EX HD           |        | 2 - 1                   | 15 | 3.97-3.14 | 102 3.7 |
|          |     |     |          |               |                             | 12033997 | E3  | -   |          | 0.406 X 35.71 | M1574030 NONFERROUS C42500 EX HD           |        | 3 - 1                   | 12 | 3.68-2.94 | 102 4.6 |
|          |     |     |          |               |                             | 12020157 | H   | -   | OBSOLETE | 0.406 X 35.71 | P1519030 TIN BRS EX HD SN PLTD             |        | 2 - 1                   | 15 | 3.97-3.14 | 101 3.7 |

| PART DRAWING   |            |
|--|------------|
| STYLE  |            |
| VOLUME 10/11   | DISTR CODE |
|  | D          |
| UNLESS OTHERWISE SPECIFIED   |            |
| THIS DOCUMENT IS IN ACCORDANCE WITH ASME Y14.5M-1994 AS MODIFIED BY THE IN-SITU DIMENSIONING AND TOLERANCE PRACTICES. SEPARATE WRITINGS OF DIMENSIONS AND TOLERANCES MAY BE OBTAINED SEPARATELY PER DELPHI REFERENCES. |            |
| ALL DIMENSIONS ARE IN MILLIMETERS  |            |

**DELPHI**  
DELPHI PACKARD ELECTRIC SYSTEMS  
WREN, OH

|   |          |
|---|----------|
| DR  | DATE     |
| APV01 J. KRAUSE   | 15MR88   |
| APV02 D. STEELE   | 14AP88   |
| APV03 G. SMALDINO   | 21AP88   |
| APV04   |          |
| SUBSTANCES OF CONCERN AND RECYCLED CONTENT PER DELPHI 1094001 |          |
| DRAWING NAME  |          |
| TAXI TERM F M/P 630   |          |
| DRAWING NUMBER  |          |
| 12020155  |          |
| SIZE  | SCALE    |
| A0  | B:1      |
| FRAME NO  | SHEET NO |
| 1   | 1 OF 3   |
| REV   | N/P      |
| 03  | -        |

| (4) PROCESS SENSITIVE DIMENSION  |        |
|--|--------|
| DIMENSIONS ENCLOSED IN ( ) INDICATE REFERENCE DIMENSIONS AND NO TOLERANCE LIMITS ARE ESTABLISHED |        |
| DIMENSIONAL RANGE (MM)   | CHRT D |
| FROM 0 TO 12   | >12    |
| TOLERANCE UNLESS OTHERWISE SPECIFIED   |        |
| ±0.1   | ±0.2   |
| ANGULAR TOLERANCE 2°   |        |

