

Programming adapter - IFS-BT-PROG-ADAPTER - 2905872

Please be informed that the data shown in this PDF Document is generated from our Online Catalog. Please find the complete data in the user's documentation. Our General Terms of Use for Downloads are valid (<http://phoenixcontact.com/download>)



Bluetooth programming adapter with μ USB and S-PORT interface for wireless programming and monitoring. The driver is included in the software solutions for the products to be programmed, such as measuring transducers or motor managers.

Product Description

Bluetooth programming adapter with μ USB and S-PORT interface for wireless programming and monitoring. The programming adapter can be used for the following device series with programming interface: MINI Analog, MINI Analog Pro, MACX Analog, INTERFACE system gateways, PLC logic. The driver is included in the software solutions for the products to be programmed, such as measuring transducers.

Key Commercial Data

Packing unit	1 STK
GTIN	 4 055626 003917
GTIN	4055626003917
Weight per Piece (excluding packing)	34.800 g
Custom tariff number	84719000
Country of origin	Germany
Note	Made to Order (non-returnable)

Technical data

Ambient conditions

Ambient temperature (operation)	-25 °C ... 65 °C
Ambient temperature (storage/transport)	-25 °C ... 70 °C

General

Connection 1	Device side
Connection method	Micro USB type B
Connection 2	Device side
Connection method	S-PORT
ATEX	# II 3 G Ex ic IIC T4 Gc X

Dimensions

Programming adapter - IFS-BT-PROG-ADAPTER - 2905872

Technical data

Dimensions

Width	38 mm
Height	30.6 mm
Depth	9.6 mm

Ambient conditions

Ambient temperature (operation)	-25 °C ... 65 °C
Ambient temperature (storage/transport)	-25 °C ... 70 °C

General

Housing material	PA 646
ATEX	# II 3 G Ex ic IIC T4 Gc X

Standards and Regulations

ATEX	# II 3 G Ex ic IIC T4 Gc X
------	----------------------------

Environmental Product Compliance

China RoHS	Environmentally Friendly Use Period = 50
	For details about hazardous substances go to tab "Downloads", Category "Manufacturer's declaration"

Drawings

Schematic diagram

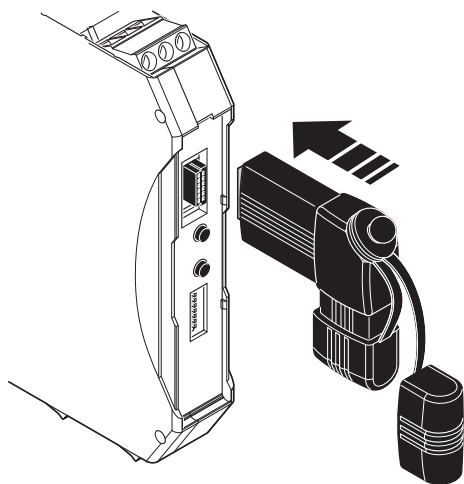

Schematic diagram

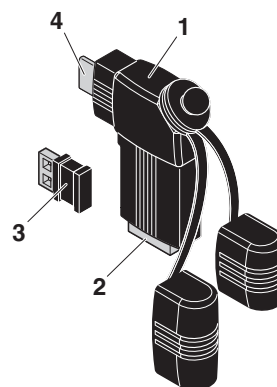

- 1 Device adapter
- 2 S-POR interface
- 3 PC adapter
- 4 µUSB interface

Connection to MACX Analog and INTERFACE system gateways

Programming adapter - IFS-BT-PROG-ADAPTER - 2905872

Schematic diagram

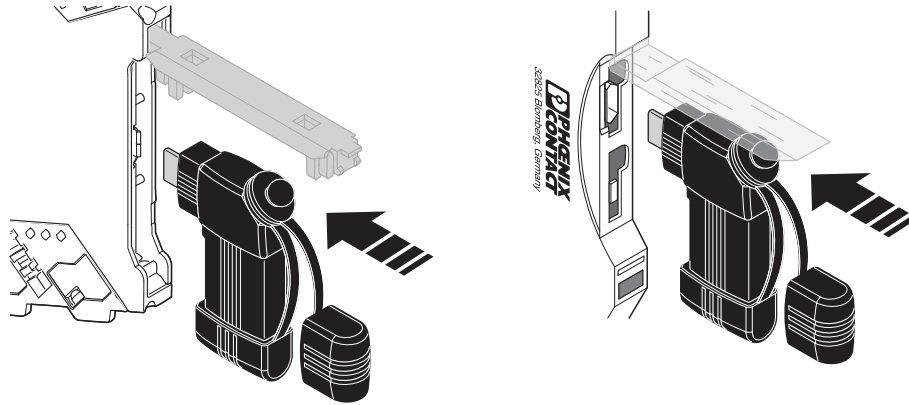

Connection to MINI Analog and MINI Analog Pro

Schematic diagram

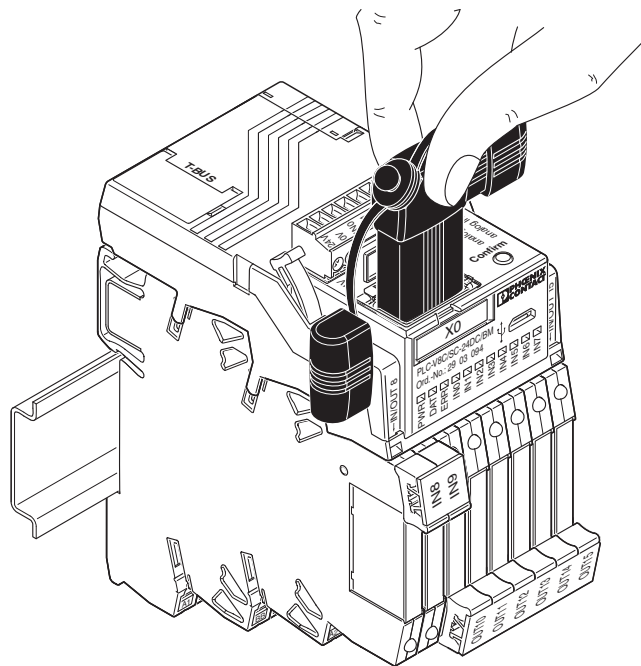

Connection to PLC logic

Classifications

eCI@ss

eCI@ss 5.1	27210107
eCI@ss 6.0	27210107
eCI@ss 8.0	27379201
eCI@ss 9.0	27379201

Programming adapter - IFS-BT-PROG-ADAPTER - 2905872

Classifications

ETIM

ETIM 5.0	EC002498
----------	----------

Phoenix Contact 2016 © - all rights reserved
<http://www.phoenixcontact.com>