

Miniature Fittings/SUS316

Series MS

Possible to use in corrosive applications

Stainless Steel Material (SUS316)

Compact piping space

Tube has a large retaining force. Hose nipple assures easy installation and removal.

Line up various styles

Possible for special tubing in a same direction.

Accepts many styles of plastic tubing

Hose nipple and hose elbow accepts nylon, soft nylon, and polyurethane tubing.



Hose nipple

Barb

Configuration for easy insertion into the tube
Holds the tube tightly

Body

Stainless steel: SUS316

Gasket

Light clamping torque
Tight seal

Tube

Possible for combination use of nylon tube and polyurethane tube.

Cap nut

Certainly hold the tube by manual clamping

Easy removing the tube by loosening
Stainless steel: SUS316

Barb fitting

Barb

Configuration for easy insertion into the tube
Holds the tube tightly

Body

Stainless steel: SUS316





















Tube

Gasket

Light clamping torque. Sure seal.

Specifications

Applicable tube material	Nylon	Soft nylon		Polyurethane
Applicable tube dia.	ø4/ø2.5 ø6/ø4	ø3.18/ø2.18	ø4/ø2.5 ø6/ø4	ø3.18/ø2 ø4/ø2.5, ø6/ø4
Max. operating pressure	1.5MPa	1.0MPa		0.8MPa
Port size	M5 (JIS B0209 class 2)			
Material	Body	Stainless steel (SUS316)		
	Gasket	PVC, nylon 66/GF30%		

Model			
Model	Style	Application	Tube O.D./I.D.
MS-5AU-3		For soft nylon tube	ø3.18/ø2.18 X M5
		For polyurethane tube	ø3.18/ø2 X M5
MS-5AU-4		For soft nylon and polyurethane tube	ø4/ø2.5 X M5
MS-5AU-6			
P.2.3-23			
MS-5ALHU-3		For soft nylon tube	ø3.18/ø2.18 X M5
		For polyurethane tube	ø3.18/ø2 X M5
MS-5ALHU-4		<ul style="list-style-type: none"> ●For soft nylon and polyurethane tube ●Body rotates at 360° around the stud axis 	ø4/ø2.5 X M5
			MS-5ALHU-6
P.2.3-23			
MS-5H-4		For nylon, soft nylon, and polyurethane tube	ø4/ø2.5 X M5
MS-5H-6			ø6/ø4 X M5
P.2.3-23			
MS-5HLH-4		<ul style="list-style-type: none"> ●For nylon, soft nylon, and polyurethane tube ●Body rotates at 360° around the stud axis 	ø4/ø2.5 X M5
			MS-5HLH-6
P.2.3-23			
M-5G1		To seal M5 thread	Material: PVC
MS-5UL	 P.2.3-23	Body rotates at 360° around the stud axis	M5 female X M5 male
MS-5UT	 P.2.3-23	Body rotates at 360° around the stud axis	M5 female X M5 female X M5 male
MS-5B	 P.2.3-24	For reducing Rc(PT)1/8 female to M5 female	Rc(PT)1/8 male X M5 female
MS-5P	 P.2.3-24	To plug unused M5 port	
MS-5J	 P.2.3-24	Solid piece-moves fitting up from work piece	M5 male X M5 female
MS-5N	 P.2.3-24	Fitting to work piece and fitting to fitting connection	M5 male X M5 male
MS-5UN	 P.2.3-24	Body rotates at 360° around the stud axis	M5 male X M5 male PAT
MS-5ATHU-3		For soft nylon tube	ø3.18/ø2.18 X M5
		For polyurethane tube	ø3.18/ø2 X M5
MS-5ATHU-4		<ul style="list-style-type: none"> ●For soft nylon and polyurethane tube ●Body rotates at 360° around the stud axis 	ø4/ø2.5 X M5
MS-5ATHU-6			ø6/ø4 X M5
P.2.3-24			
M-5GH		MS-5ALHU-6 MS-5HLH-4 MS-5HLH-6 MS-5ATHU-6 only	Material: Nylon 66 GF 30%

 K

 M

 H

 D

 MS

 T

 LQ

 Clean Room

Series MS

Barb fitting for soft nylon: MS-5AU-3, -4, -6



Part No.	C	øD	L	Effective area (mm ²)	Weight (g)
MS-5AU-3	4.5	1.6	11.5	1.7	1.4
MS-5AU-4	5	1.8	12	2.1	1.5
MS-5AU-6	7	2.5	14	4.0	1.7

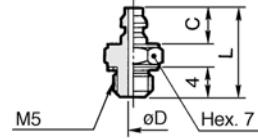

Barb elbow for soft nylon: MS-5ALHU-3, -4, -6



Part No.	A	C	øD	L	Effective area (mm ²)	Weight (g)
MS-5ALHU-3	8	4.5	1.6	11.8	1.1	3.0
MS-5ALHU-4	8.8	5.0	1.8	12.6	1.4	3.1
MS-5ALHU-6	10.8	7.0	2.5	14.6	2.4	3.7

MS-5ALHU-3, -4

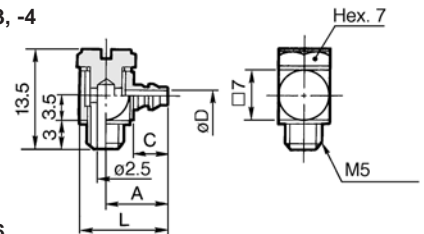

MS-5ALHU-6

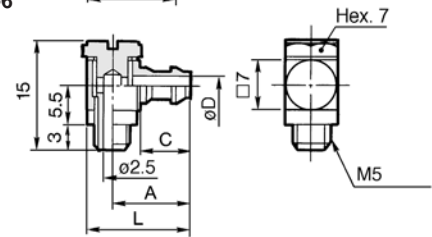

Hose nipple: MS-5H-4, -6



Part No.	B	øD	L	E	øF	Effective area (mm ²)	Weight (g)
MS-5H-4	7	1.8	15.5	7	6.5	2.1	2.5
MS-5H-6	8	2.5	16.5	8	8.5	4.0	3.7

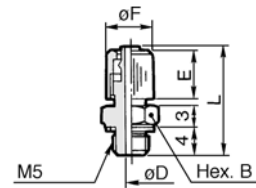

Hose elbow: MS-5HLH-4, -6



Part No.	A	□B	C	øD	E	øF	L	M	N	Effective area (mm ²)	Weight (g)
MS-5HLH-4	12	7	8.5	1.8	7	6.5	15.8	15	5.5	1.4	4.2
MS-5HLH-6	13.5	8	9.5	2.5	8	8.5	17.8	16	6	2.4	6.2

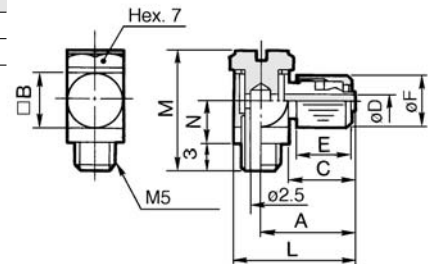

Universal elbow: MS-5UL

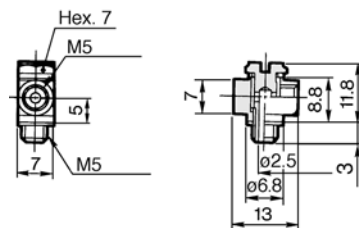

Effective area: 2.4mm²
Weight: 4.5g

Universal tee: MS-5UT

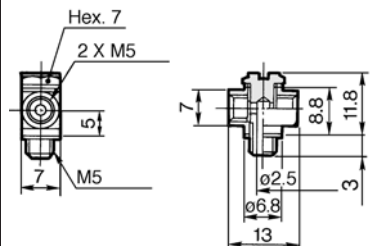

Effective area: 2.4mm²
Weight: 4.5g

Bushing: MS-5B

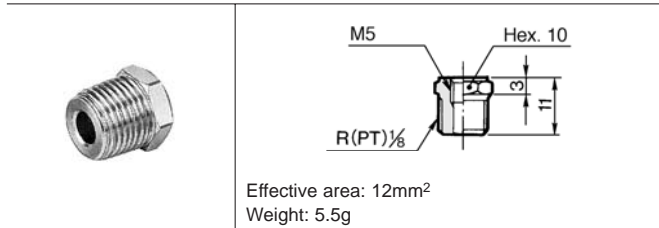

Plug: MS-5P

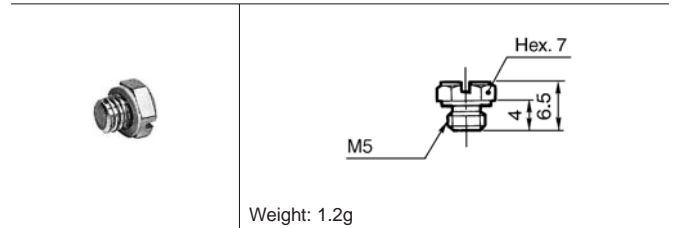

Extension fitting: MS-5J

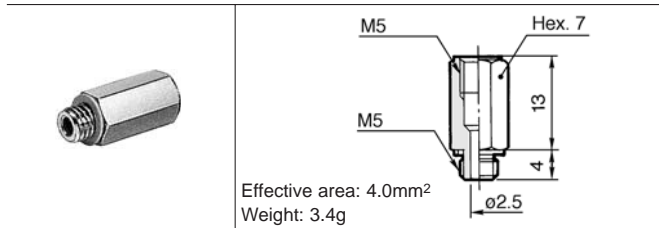

Nipple: MS-5N

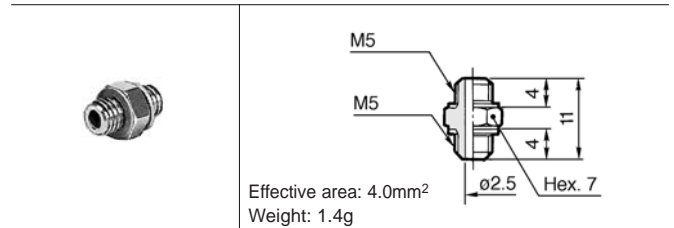

Barb tee for soft tubing: MS-5ATHU-3, -4, -6

Part No.	A1	A2	C	øD	Effective area (mm ²)	Weight (g)
MS-5ATHU-3	8	8.3	4.5	1.6	1.1	3.4
MS-5ATHU-4	8.8	8.8	5.0	1.8	1.4	3.6
MS-5ATHU-6	10.8	10.8	7.0	2.5	2.4	4.2

MS-5ATHU-3, -4

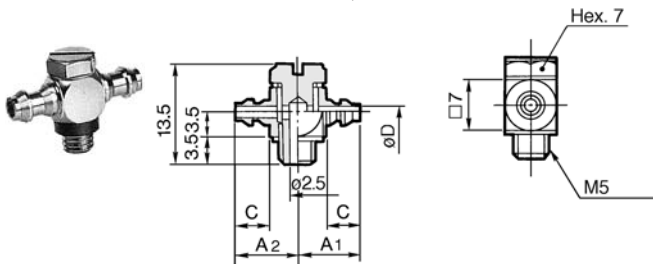

MS-5ATHU-6

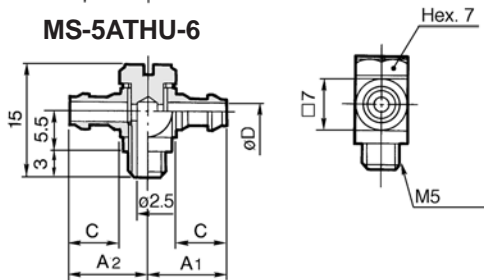

Universal nipple: MS-5UN

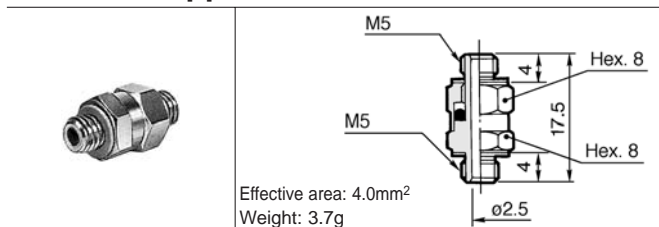

Gasket: M-5G1, M-5GH



⚠ Precautions

Be sure to read before handling.
Refer to p.0-26 and 0-27 for Safety Instructions and common precautions on the products mentioned in this catalogue, and refer to p.2.0-7 and 2.0-8 for more detailed precautions of every series.

Tightening of M5 thread

⚠ Caution

- ① Tighten by hand, and give it an additional 1/4 rotation with a wrench. (The additional rotation should be doubled to 1/2 when using the universal elbow, universal tee, etc. which have two gaskets.) If tightened too much, thread portion may be damaged and gasket may be deformed. This will cause air leakage. On the contrary, if tightening is not sufficient, thread may loosen causing air leakage.

Use of tube with hose nipple

⚠ Caution

- ① Cut the tube perpendicularly to the tube axis to a little longer length than required length. (Use tube cutter "TK-1", "TK-2" or "TK-3".)
- ② Pass the tube through the cap nut.
- ③ Push the tube until it comes to the end of the barb portion, or it may cause air leakage or hose releasing.
- ④ Tighten the cap nut firmly by hand on the fitting.

Use of tube with barb fitting

⚠ Caution

- ① Cut the tube perpendicularly to the tube axis to a little longer length than required length. (Use tube cutter "TK-1", "TK-2" or "TK-3".)
- ② Push the tube in until it comes to the end of the barb portion, or it may cause air leakage or release hose.

 K

 M

 H

 D

 MS

 T

 LQ

 Clean Room