



INSTANT DIRECTIONAL CHANGES

Ensures smooth movement of materials with delicate or polished surfaces.



DESIGNED FOR WET AND DRY CONDITIONS

BZP = Bright Zinc Plate can be used in most applications.

S/S Inox = Stainless Steel Inox for the most arduous conditions.

BALL OPTIONS

Red Polyurethane is harder wearing or Black Rubber for most other applications. Alwaysse Float-on castors are used for easy handling of other flat sheet materials i.e. granite, wood, plastic, paper, card, etc.



MULTI CHOICE OPTIONS TO SUIT ALL APPLICATIONS

Complete Castors

BLACK RUBBER

35MM BZP ACR 35 R/H OR L/H

35MM S/S ACR 35 R/H OR L/H S/S

50MM BZP ACR 50 R/H OR L/H

50MM S/S ACR 50 R/H OR L/H S/S

Balls Only

BLACK RUBBER

35MM BZP ACR 35B

50MM BZP ACR 50B



RED

POLYURETHANE

ACP 35 R/H OR L/H

ACP 35 R/H OR L/H

S/S

ACP 50 R/H OR L/H

ACP 50 R/H OR L/H S/S

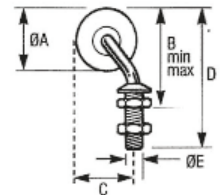

Stem, Circlip, Washer and Ball Only

BZP SCW 35 RB R/H OR L/H

SCW 50 RB R/H OR L/H

SCW 35 PB R/H OR L/H

SCW 50 PB R/H OR L/H

S/S SCW 35 RB R/H OR L/H S/S

SCW 50 RB R/H OR L/H S/S

SCW 35 PB R/H OR L/H S/S

SCW 50 PB R/H OR L/H S/S



A Ømm		35	50
B mm	min	55	73
	max	77	95
C mm		38	58
D mm		88	106
Load Cap Kgs		15	20
E Ømm		13.5	13.5

NOTE - When ordering stems, circlip, washers or complete castors, please state whether R/H righthand or L/H lefthand.