

## FEATURES

- **1/4"~1/2"**  
**(DN8~DN15)**
- **Max working pressure: PN63**
- **Material: ASTM A276-316L**
- **Spring Material SUS 316L**
- **O-Ring Material Viton**

## RS PRO Check Valves

RS Stock No.: 2570035, 2570041, 2570038



RS Professionally Approved Products bring to you professional quality parts across all product categories. Our product range has been tested by engineers and provides a comparable quality to the leading brands without paying a premium price.

### General Specification

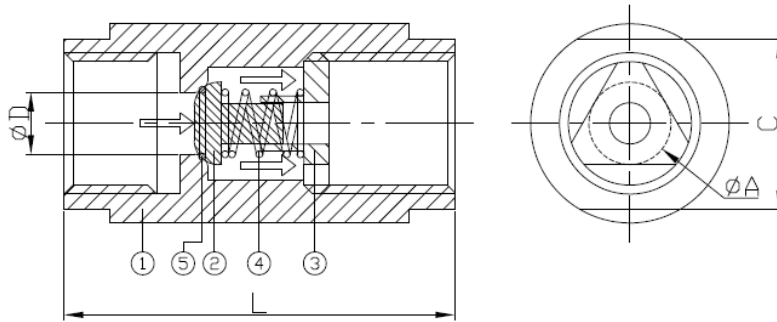

ITEM	PARTS	MATERIAL
1	BODY	ASTM A276-316L
2	DISC	
3	GUIDE CAP	SUS 316L
4	SPRING	
5	O-RING	

DN	D	A	L	C	D1	Weight (kg)
8	5	8	44	17	19	0.1
10	7	11	48	21	25	0.1
15	9	12	57	26	30	0.2

NPS	D	A	L	C	D1	Weight (lb)
1/4"	0.2	0.31	1.73	0.67	0.75	0.2
3/8"	0.28	0.43	1.89	0.83	0.98	0.3
1/2"	0.35	0.47	2.24	1.02	1.18	0.4

unit:in

