

D-SUB STANDARD

Solder pin – Angled – .318" / 7.19 mm – Precision machined contacts – Plastic bracket

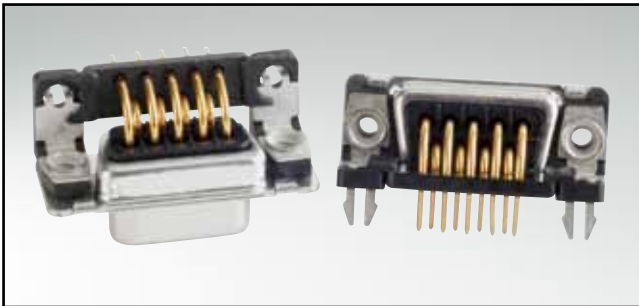

RoHS compliant – CSA listed, File No.: LR 115000-1 – UL listed, File No.: E202784

DESCRIPTION

- Mounting styles:
 - with mounting bracket, PCB clip and 4-40 UNC or M3 threaded insert
 - with mounting bracket, PCB clip and 4-40 UNC or M3 front spacer
- Quality class 3 (also available in quality class 1)
- Shell: Steel tin plated (brass tin plated or stainless steel available on request)

SOCKET CONNECTOR

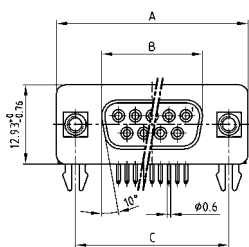

No. of pos.	A -0.76	B -0.25	C
09	31.19	16.46	25.00 ±0.12
15	39.52	24.79	33.30 ±0.15 ±0.10
25	53.42	38.50	47.04 ±0.13
37	69.70	54.96	63.50 ±0.13

PCB layout: Kat1kGEA

Mounting style: PCB clip, threaded insert

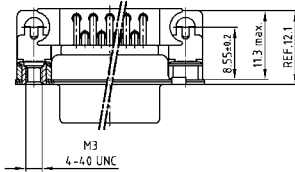

Mounting style: PCB clip, front spacer

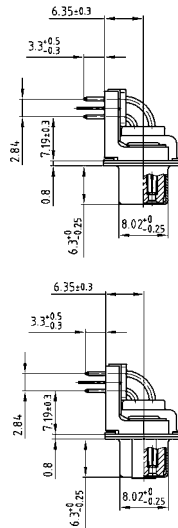
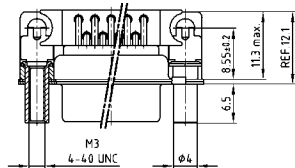

PLUG CONNECTOR

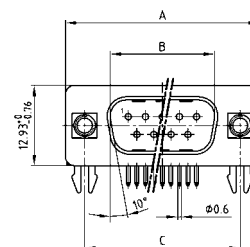

No. of pos.	A -0.76	B +0.25	C	D -0.3
09	31.19	16.79	25.00 ±0.12	6.12
15	39.52	25.12	33.30 ±0.15 ±0.10	6.12
25	53.42	38.84	47.04 ±0.13	5.99
37	69.70	55.30	63.50 ±0.13	5.99

PCB layout: Kat1kGFA

Mounting style: PCB clip, threaded insert

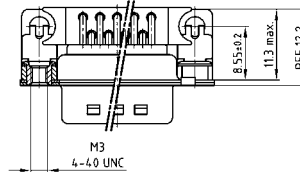

Mounting style: PCB clip, front spacer

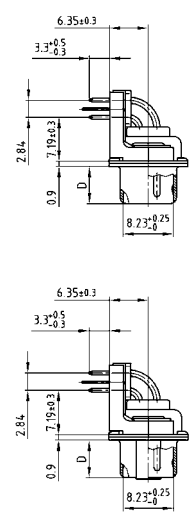
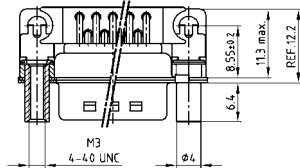

ORDER DATA

SOCKET CONNECTOR		
No. of pos.	Mounting style	Part Number
09	PCB clip / 4-40 UNC Threaded insert	164 A 18809 X
15	PCB clip / 4-40 UNC Threaded insert	164 A 18819 X
25	PCB clip / 4-40 UNC Threaded insert	164 A 18829 X
37	PCB clip / 4-40 UNC Threaded insert	164 A 18839 X
09	PCB clip / M3 Threaded insert	164 A 18849 X
15	PCB clip / M3 Threaded insert	164 A 18859 X
25	PCB clip / M3 Threaded insert	164 A 18869 X
37	PCB clip / M3 Threaded insert	164 A 18879 X
09	PCB clip / 4-40 UNC Front spacer	164 A 18889 X
15	PCB clip / 4-40 UNC Front spacer	164 A 18899 X
25	PCB clip / 4-40 UNC Front spacer	164 A 18909 X
37	PCB clip / 4-40 UNC Front spacer	164 A 18919 X
09	PCB clip / M3 Front spacer	164 A 18929 X
15	PCB clip / M3 Front spacer	164 A 18939 X
25	PCB clip / M3 Front spacer	164 A 18949 X
37	PCB clip / M3 Front spacer	164 A 18959 X

PLUG CONNECTOR		
No. of pos.	Mounting style	Part Number
09	PCB clip / 4-40 UNC Threaded insert	163 A 18389 X
15	PCB clip / 4-40 UNC Threaded insert	163 A 18399 X
25	PCB clip / 4-40 UNC Threaded insert	163 A 18409 X
37	PCB clip / 4-40 UNC Threaded insert	163 A 18419 X
09	PCB clip / M3 Threaded insert	163 A 18429 X
15	PCB clip / M3 Threaded insert	163 A 18439 X
25	PCB clip / M3 Threaded insert	163 A 18449 X
37	PCB clip / M3 Threaded insert	163 A 18459 X
09	PCB clip / 4-40 UNC Front spacer	163 A 18469 X
15	PCB clip / 4-40 UNC Front spacer	163 A 18479 X
25	PCB clip / 4-40 UNC Front spacer	163 A 18489 X
37	PCB clip / 4-40 UNC Front spacer	163 A 18499 X
09	PCB clip / M3 Front spacer	163 A 18509 X
15	PCB clip / M3 Front spacer	163 A 18519 X
25	PCB clip / M3 Front spacer	163 A 18529 X
37	PCB clip / M3 Front spacer	163 A 18539 X

PCB clip .122" / 3.1 ± .004" / 0.10 mm hole diameter and .063" / 1.6 mm circuit board thickness

Mouser Electronics

Authorized Distributor

Click to View Pricing, Inventory, Delivery & Lifecycle Information:

CONEC:

[163A18399X](#) [163A18389X](#) [164A18829X](#) [164A18909X](#) [164A18839X](#) [164A18889X](#) [164A18809X](#) [164A18819X](#)
[163A18429X](#) [164A18899X](#) [163A18449X](#) [163A18409X](#) [163A18419X](#) [163A18479X](#)