

Rubycon **HYBRID POLYMER CAPACITORS** **PZE**

PZE SERIES

UPGRADE



- Radial Lead Type
- Load life : 10000 hours at 105°C
- AEC-Q200 , 85°C/85% RH , RoHS Compliant

◆ SPECIFICATIONS

Item	Characteristics												
Temperature Range	-55~+105°C												
Rated Voltage Range	25~80Vdc												
Capacitance Tolerance	±20% (20°C, 120Hz)												
Leakage Current (MAX)	$I=0.01CV$ or $3\mu A$ After 2 minutes (whichever is greater.) $I=(\mu A)$ $C=(\mu F)$ $V=(Vdc)$ Leakage Current Capacitance Rated Voltage												
Dissipation Factor (MAX)	<table border="1"> <thead> <tr> <th>(Vdc) Rated Voltage</th> <th>25</th> <th>35</th> <th>50</th> <th>63</th> <th>80</th> </tr> </thead> <tbody> <tr> <td>tan δ</td> <td>0.14</td> <td>0.12</td> <td>0.10</td> <td>0.08</td> <td>0.08</td> </tr> </tbody> </table> (20°C, 120Hz)	(Vdc) Rated Voltage	25	35	50	63	80	tan δ	0.14	0.12	0.10	0.08	0.08
(Vdc) Rated Voltage	25	35	50	63	80								
tan δ	0.14	0.12	0.10	0.08	0.08								
Endurance (Life)	After applying rated voltage with rated ripple current for 10000 hours at 105°C, the capacitors shall meet the following Criteria.												
Biased Humidity/Temperature 85°C/85%RH	After applying rated voltage for 2000 hours at 85°C and humidity of ,85%, the capacitors shall meet the following Criteria .												
Criteria	<table border="1"> <tbody> <tr> <td>Capacitance Change</td> <td>Within ±30% of the initial value.</td> </tr> <tr> <td>Dissipation Factor</td> <td>Not more than 200% of the specified value.</td> </tr> <tr> <td>ESR</td> <td>Not more than 200% of the specified value.</td> </tr> <tr> <td>Leakage Current</td> <td>Not more than the specified value.</td> </tr> </tbody> </table>	Capacitance Change	Within ±30% of the initial value.	Dissipation Factor	Not more than 200% of the specified value.	ESR	Not more than 200% of the specified value.	Leakage Current	Not more than the specified value.				
Capacitance Change	Within ±30% of the initial value.												
Dissipation Factor	Not more than 200% of the specified value.												
ESR	Not more than 200% of the specified value.												
Leakage Current	Not more than the specified value.												
Low Temperature Stability Impedance Ratio (MAX)	$Z(-55^{\circ}C)/Z(+20^{\circ}C) \leq 2.0$ (100kHz) $Z(-25^{\circ}C)/Z(+20^{\circ}C) \leq 1.5$												

◆ PART NUMBER CONSTRUCTION

□□□	PZE	□□□	M	□□□	φDxL
Rated Voltage	Series	Capacitance	Capacitance Tolerance	Option	Case Size

*Specifications subject to change without notice.

Rubycon **HYBRID POLYMER CAPACITORS** **PZE**

◆ DIMENSIONS

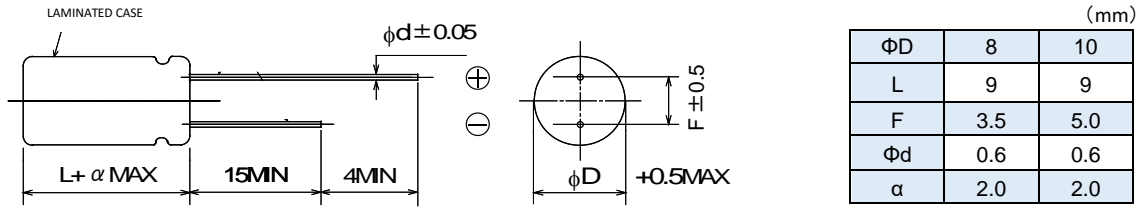

◆ Standard size

Rated Voltage (V)	Capacitance (μF)	Size φD × L (mm)	Dissipation Factor (MAX) 120Hz, 20°C	Leakage Current (uA/2min)	E.S.R (mΩ MAX)		Rated Ripple Current (mA rms / 105°C, 100kHz)
					20°C, 100kHz	-40°C, 10kHz	
25	220	8 × 9	0.14	55.0	27	41	2300
	330	10 × 9	0.14	82.5	20	30	2500
35	150	8 × 9	0.12	52.5	27	41	2300
	270	10 × 9	0.12	94.5	20	30	2500
50	68	8 × 9	0.10	34.0	30	45	1800
	100	10 × 9	0.10	50.0	28	42	2000
63	33	8 × 9	0.08	20.8	40	60	1700
	56	10 × 9	0.08	35.3	30	45	1800
NEW 80	22	8 × 9	0.08	17.6	45	68	1600
	39	10 × 9	0.08	31.2	35	53	1700

◆ FREQUENCY CORRECTION COEFFICIENT FOR RIPPLE CURRENT

f (Hz) Frequency	120	1k	10k	100k≤
Coefficient	0.05	0.30	0.70	1.00

*Specifications subject to change without notice.