

Dorwatcher



Overview

The DorWatcher is an alarm unit used to prevent doors being left open for an extended period of time.

DorWatcher can be used in any situation where it is undesirable for a door to be open for more than a short period. The time that the door can be left open for without generating an alarm can be adjusted at installation time.

Normal Operation

When the protected door is opened the units LED will flash every few seconds and time TD1 will be allowed to elapse before a short warning chime is made by the unit. An additional time TD2 is then allowed to elapse. If the door hasn't been closed after times TD1 and TD2 have elapsed, the unit will start sounding its main alarm tone. If the door is closed before the main alarm tone is heard, the unit will reset and the next time the door is opened the timers will start again.

Once in full alarm, the tone will continue for 2 minutes after which time the alarm tone will cease and a chime will be heard every 30 seconds to alert people in the vicinity that the door is still open. To clear the alarm, close the door.

Simple Inspection

We recommend that DorWatcher's installed in locations prone to tampering/vandalism are both fitted with an anti-tamper screws and cages (available separately) and inspected for signs of tampering on a regular basis.

Optional

CG100 - Manufactured from 9 guage galvanised steel rod, purpose designed for the protection of our Exitguard, DorWatcher, Zoneguard, Aidalarm and Stop 'n' Search models from vandalism and misuse. **The cage has openings for normal operation.**

FIX/10 - Anti Tamper screws for securing DorWatcher lid

FIX/10/ATS - 2 hole anti tamper screwdriver bit to suit FIX/10 screws

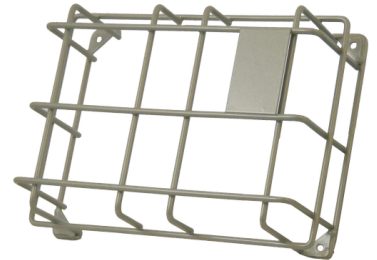

A simple visual check of the DorWatcher can be made:

Open the protected door, if the LED on the front panel flashes within 10 seconds then the system is working correctly, if the LED does not flash and the alarm does not activate after the preset time, contact your installation company for advice.

Battery fault indication

The battery powered DorWatcher model DW304 has a built in Battery fault monitor. If the unit bleeps as soon as the door is opened, this indicates that the batteries are running low and should be changed for new batteries (6 x AA).

TD1 and TD2 times are adjustable as follows:

TD1 (Secs)	TD2 (Secs)	Total time to alarm
20	10	30 seconds
40	20	1 minute - Factory default
160	20	3 minutes
400	20	7 minutes

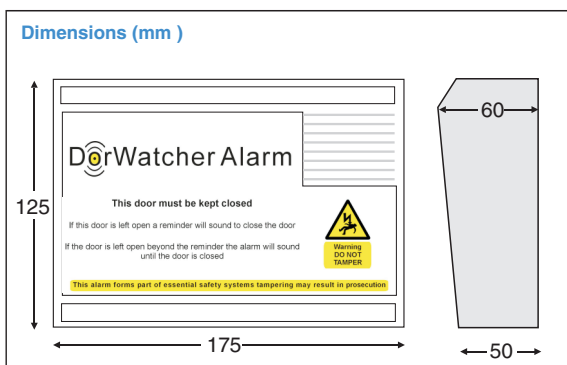

Hoyles Electronic Developments Ltd

T. 01744 886600

F. 01744 886607

E. sales@hoyles.com

W. www.hoyles.com