

FK 222/220 ...

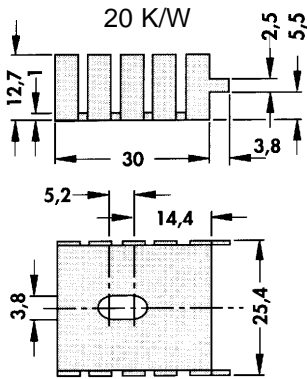

TO 220

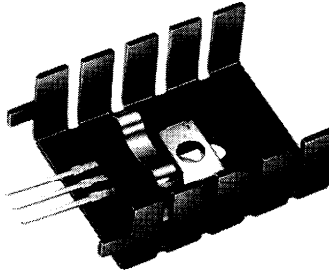

FK 222/220 THF ...

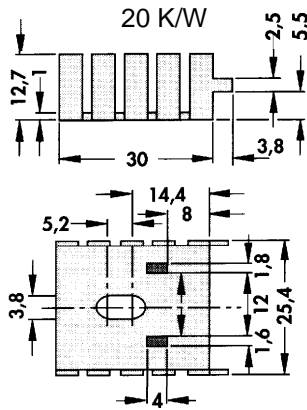

TO 220

... bitte gewünschte Oberfläche angeben:  
SA = schwarz eloxiert  
MI = lötbare Weissbronze

... please indicate requested surface:  
SA = black anodised  
MI = solderable white bronze

... prière d'indiquer la finition:  
SA = anodisé noir  
MI = bronze blanc soudable

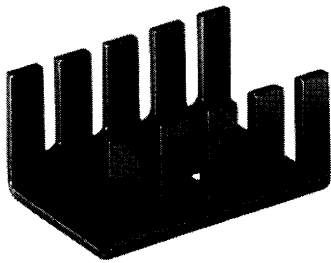

FK 23 1 ISA-220  
24 K/W

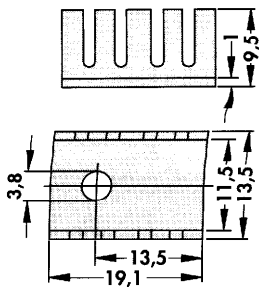

TO 220

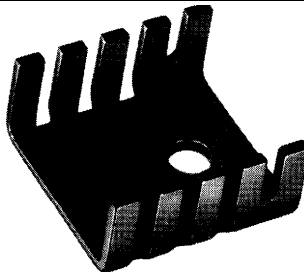

FK 239 / SA-32  
24 K/W

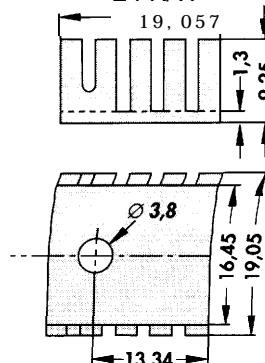

SOT 32